

Surface Raceway / Aluminum SWA4303

Snap Way™ Accessories

Manufactured by MonoSystems, Inc.

COVER PLATE OPTIONS

General Information

- 1.) Assembly instructions: firmly press cover into place ensuring that both sides are completely snapped into base section.
- 2.) All covers come 12" standard unless specified otherwise.
- 3.) UL listed when used with grounding adapter clips (SWA48GC) adjacent to wire entry points.
- 4.) Views for reference - do not scale.

Material

#6063-T6 extruded aluminum, satin anodized finish.

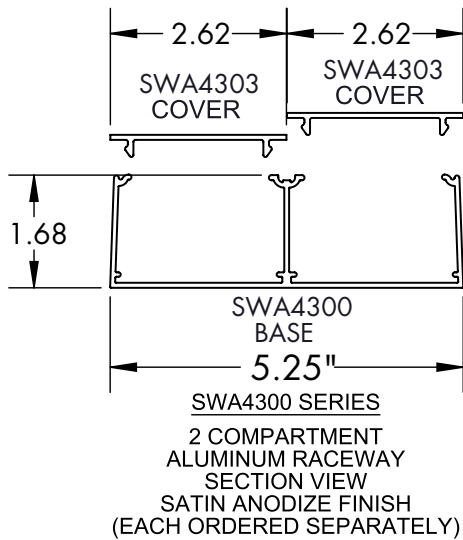

SWA4303 - COVER
(ORDERED SEPARATELY)

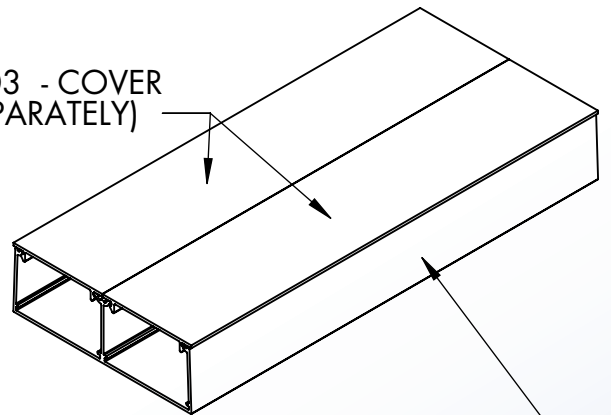

SWA4300
2 COMPARTMENT BASE
(ORDERED SEPARATELY)

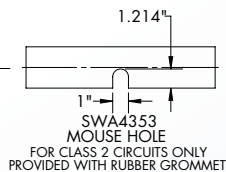
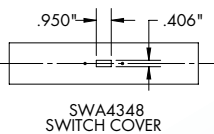
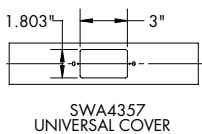
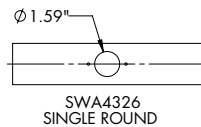
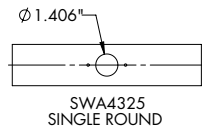
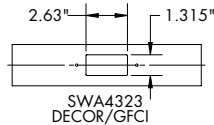
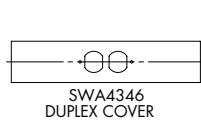
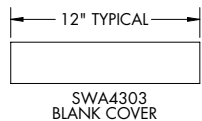

4 International Drive
Rye Brook, NY 10573
Toll Free: 1 888.764.7681
Phone: 914.934.2075
Fax: 914.934.2190
MonoSystems.com

