

Cable Tray / Channel Tray

SXX-XX-60IVXX

Channel Tray Fittings
 Manufactured in the USA by MonoSystems, Inc.



60° Inside Vertical Bend

General Information

- 1.) Attach bend to channel tray using (1) supplied splice plate (sbx-104x) and provided 3/8" hardware.
- 2.) Recommended torque: for 3/8" fasteners 25-35 ft-lbs [33.9-47.5 N-m].
- 3.) Views for reference - do not scale.

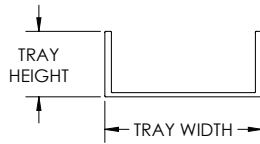
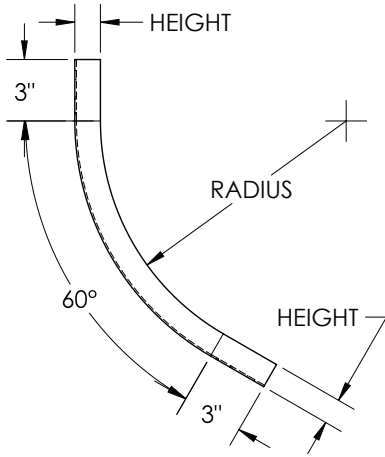

TRAY HEIGHT		TRAY WIDTH	
H		W	
IN.	MM.	IN.	MM.
1.25	32	3	76
1.75	44	4	101
1.75	44	6	152



SOLID BOTTOM

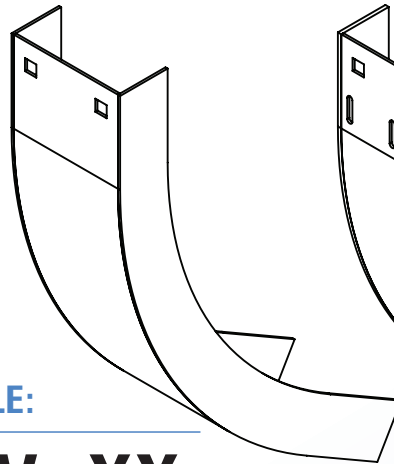

VENTED BOTTOM

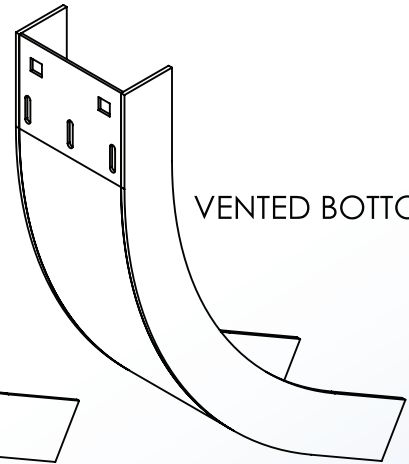

ORDERING DATA EXAMPLE:

SXX - XX - 60 IV XX

STYLE

MATERIAL

WIDTH

FITTING
ANGLE

FITTING TYPE

RADIUS

B = SOLID
BOTTOM
V = VENTED
BOTTOM

A = ALUMINUM
P = PREGRAV STEEL
G = HDGAF STEEL
SS4 = STAINLESS STEEL 304
SS6 = STAINLESS STEEL 316

03 = 3"
04 = 4"
06 = 6"

60°

IV = INSIDE
VERTICAL
BEND

12 = 12"
24 = 24"
36 = 36"
48 = 48"

4 International Drive
Rye Brook, NY 10573
Toll Free: 1 888.764.7681
Phone: 914.934.2075
Fax: 914.934.2190
MonoSystems.com



MonoSystems™
Expect. Direct.