

# Cable Tray / Ladder Tray

## DP-2072-HT-XXXX-PX

# PowerTray™ Fittings

Manufactured by MonoSystems, Inc.

## HORIZONTAL TEE COVER, DIAMOND PLATE

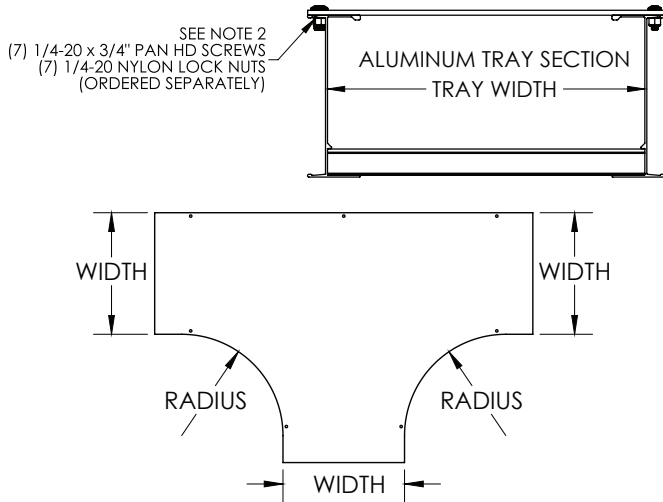

### Notes:

- 1.) Material: 6" wide, 9" wide, 12" wide or 18" wide: 1/8" thick aluminum diamond plate. Material: 24" wide: 3/16" thick aluminum diamond plate.
- 2.) All mounting hardware (by others). MonoSystems recommends fastening cover to power tray fitting using 1/4" hardware. Feed screws thru hole in cover, mark and drill thru top siderail flange of tray and attach on other side with 1/4-20 nylon lock nut. Or install self tapping screws through holes in cover into tray. Be sure to completely align cover to tray before drilling and installing.
- 3.) Views for reference - do not scale.

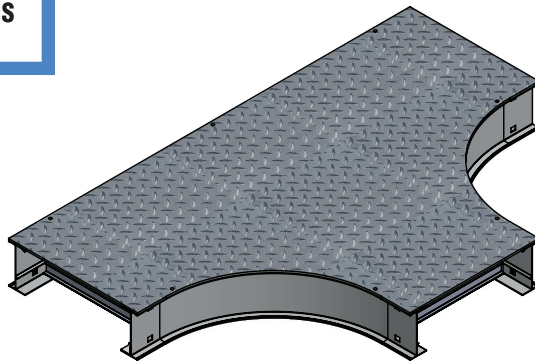

COVER SHOWN ATTACHED

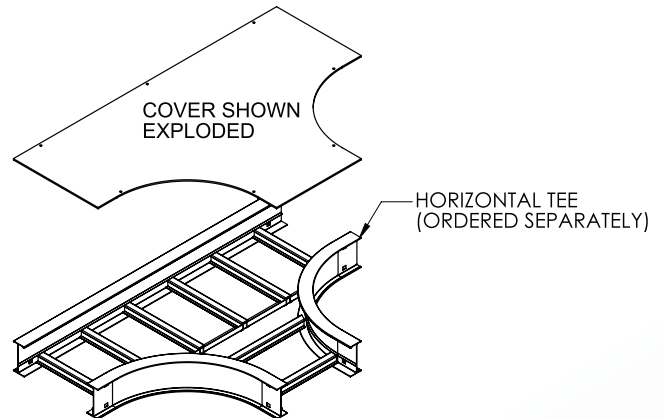

### ORDERING DATA EXAMPLE:

**DP-2072-HT-XX-XX-PX**

**MATERIAL**

ALUMINUM  
DIAMOND  
PLATE

**FITTING TYPE**

SERIES: B, C, D & E  
HEAVY ALUMINUM  
TRAY FITTING COVER

HC =  
HORIZONTAL  
TEE

**RADIUS**

12 = 12"  
24 = 24"

**WIDTH**

06 = 6"  
09 = 9"  
12 = 12"  
18 = 18"  
24 = 24"

**COLOR**

LEAVE BLANK = NON PAINTED  
PY = PAINTED YELLOW  
PNSY = PAINTED NON-SKID  
SAFETY YELLOW

4 International Drive  
Rye Brook, NY 10573  
Toll Free: 1 888.764.7681  
Phone: 914.934.2075  
Fax: 914.934.2190  
MonoSystems.com

