

Cable Tray / Channel Tray

SBX-18XX

Channel Tray Accessories

Manufactured in the USA by MonoSystems, Inc.



Reducer Plate, Channel Tray

General Information

- 1.) Attach reducer plate to channel tray using provided 3/8" hardware as shown.
- 2.) Recommended torque: for 3/8" fasteners: 25-35 ft-lbs [33.9-47.5 N-m].
- 3.) Views for reference - do not scale.

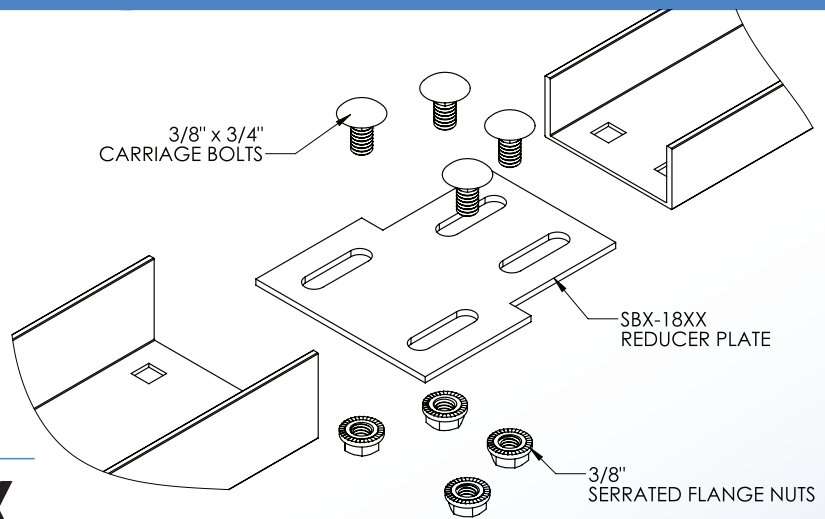
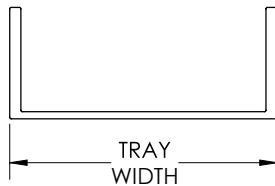
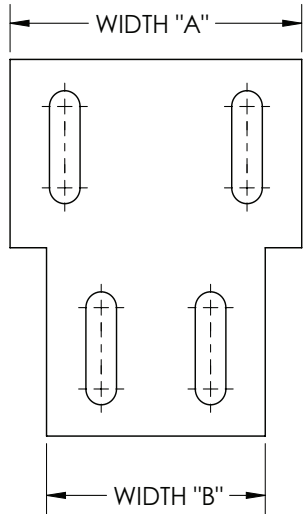

ORDERING DATA EXAMPLE:

SB X - 18 X X

MATERIAL

CHANNEL WIDTH "A"

CHANNEL WIDTH "B"

A = ALUMINUM
 P = PREGLAV STEEL
 G = HDGAF STEEL
 SS4 = STAINLESS STEEL 304
 SS6 = STAINLESS STEEL 316

04 = 4"
 06 = 6"

03 = 3"
 04 = 4"

4 International Drive
 Rye Brook, NY 10573
 Toll Free: 1 888.764.7681
 Phone: 914.934.2075
 Fax: 914.934.2190
 MonoSystems.com

