

Cable Tray / Trough Tray SXXX-XX-120

TroughTray™

Manufactured in the USA by MonoSystems, Inc.



TROUGH TRAY

Notes

- 1.) Standard tray length: 120" [10ft].
- 2.) One u-splice connector and 3/8" hardware supplied with each tray length.
- 3.) Recommended torque: For 3/8" fasteners: 25-35 ft-lbs [33.9-47.5 N-m].
- 4.) Standard NEMA class 10a.
- 5.) Custom sizes are available. Contact MonoSystems with request.
- 6.) Views for reference - do not scale.

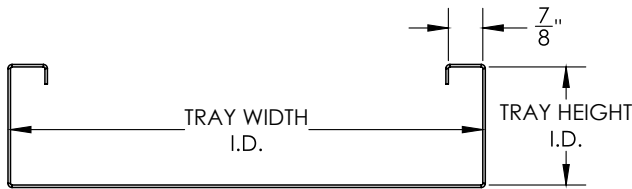

FILE: E80034
VOL.3

ORDERING DATA EXAMPLE:

SXXX-XX-120

TYPE	MATERIAL	HEIGHT	TRAY WIDTH	LENGTH
B = SOLID BOTTOM	P = STEEL	3 = 3" HIGH	06 = 6" WIDE	120 = 10ft LONG
	PRE-GALV	4 = 4" HIGH	09 = 9" WIDE	
V = VENTED BOTTOM	G = HDGAF	6 = 6" HIGH	12 = 12" WIDE	
	A = ALUMINUM		18 = 18" WIDE	
	4SS = 304 STAINLESS STEEL		24 = 24" WIDE	
	6SS = 316 STAINLESS STEEL		36 = 36" WIDE	

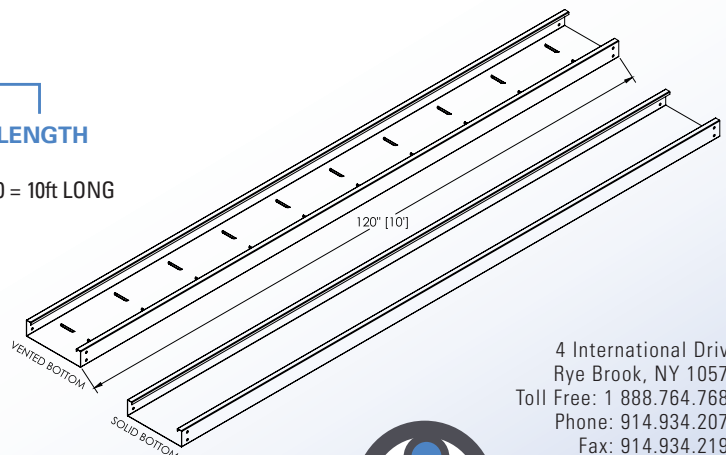
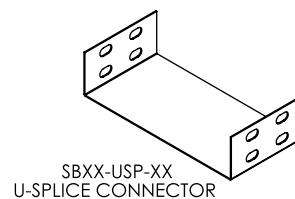

4 International Drive
Rye Brook, NY 10573
Toll Free: 1 888.764.7681
Phone: 914.934.2075
Fax: 914.934.2190
MonoSystems.com



MonoSystems™
wire management. managed.

Cable Tray / Trough Tray Z0-2030-XX

TroughTray™ Accessories
Manufactured by MonoSystems, Inc.

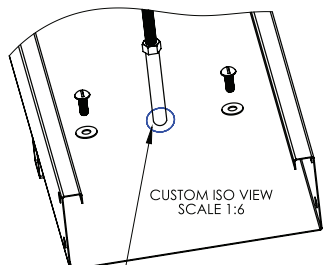

INSTALLER TO:
FIELD DRILL $\varnothing 3/4"$ HOLE
IN CENTER OF TRAY FOR
 $\varnothing 1/2"$ THREADED ROD & PIPE
(BY OTHERS)

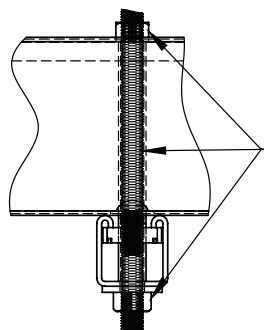

$1/2"$ THREADED ROD
(2X) $1/2"$ HEX NUT
(1X) $1/2"$ WASHER
(BY OTHERS)

SIDE DETAIL VIEW WITH
HIDDEN LINES SHOWN
SCALE 1:4

TROUGH TRAY CENTER HANGER

Notes:

- 1.) Unless otherwise noted, drawing units are in inch.
- 2.) For customer reference and review.
- 3.) Trough Tray and $1/2"$ threaded rod & $1/2"$ hardware (ordered separately).

EACH Z0-2030-XX INCLUDES:

QTY	DESCRIPTION
1	SLOTTED STEEL CENTER STRUT 1-5/8" X 1-5/8" X LENGTH TO MATCH WIDTH OF TRAY WITH 1/2" PROTECTIVE PIPE WELDED ABOUT CENTER
2	3/8-16 x 1" LONG SLOTTED ROUND HEAD MACHINE SCREWS
2	3/8" SPRING NUTS
2	3/8" FLAT WASHERS

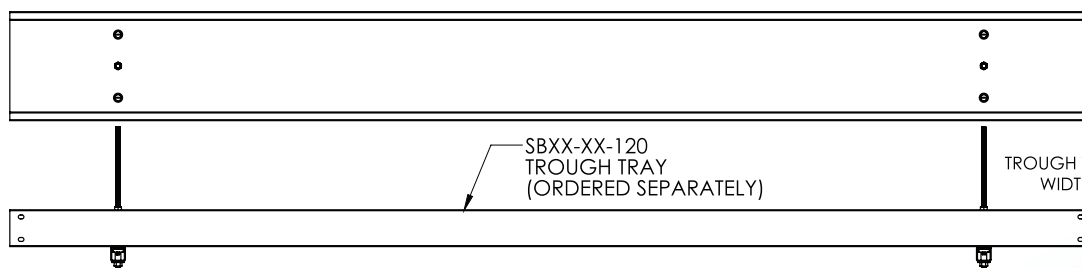

FIELD DRILL HARDWARE
CLEARANCE HOLES FOR 3/8"
HARDWARE IN BOTTOM OF
TRAY WHERE REQUIRED.
FASTEN TROUGH TRAY TO
SUPPORTS WITH PROVIDED
HARDWARE.

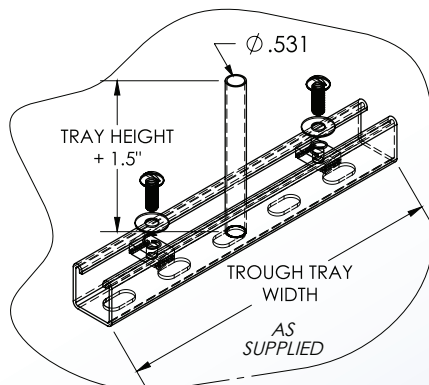
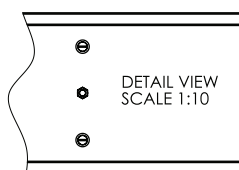

TROUGH TRAY ACCESSORIES

4 International Drive
Rye Brook, NY 10573
Toll Free: 1 888.764.7681
Phone: 914.934.2075
Fax: 914.934.2190
MonoSystems.com



MonoSystems™
Expect. Direct.

Cable Tray / Trough Tray

SBX-COVX-HC-XXXX

TroughTray™ Fittings

Manufactured in the USA by MonoSystems, Inc.



HORIZONTAL CROSS COVER

Notes

- 1.) Ordered as each. Fittings ordered separately.
- 2.) Each cover provided with 8x1/2" self drilling TEK screws for mounting.
- 3.) Views for reference - do not scale.

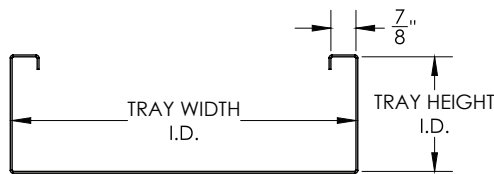
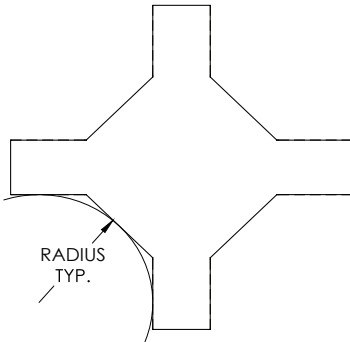

FILE: E80034
VOL.3

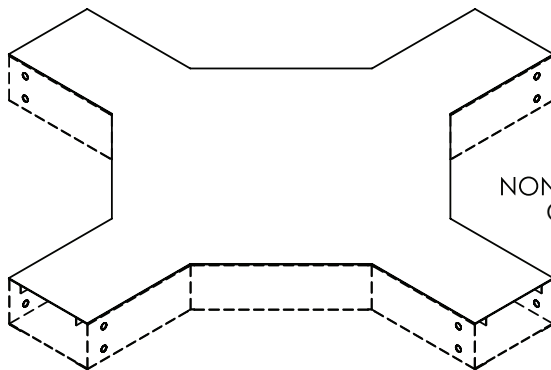

NON-FLANGED
COVER

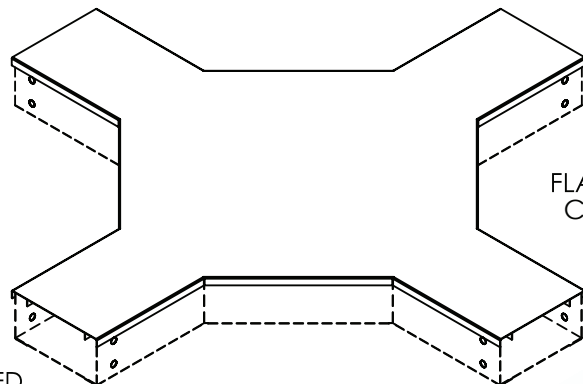

FLANGED
COVER

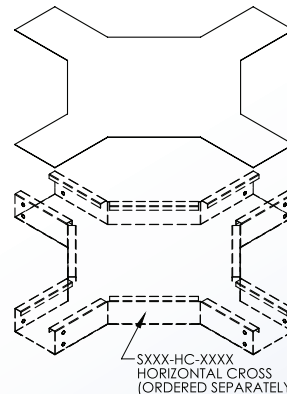

SXXX-HC-XXXX
HORIZONTAL CROSS
(ORDERED SEPARATELY)

ORDERING DATA EXAMPLE:

SBX-COVX-HC-XX XX

MATERIAL

P = STEEL
PRE-GALV
G = HDGAF
A = ALUMINUM
4SS = 304 STAINLESS STEEL
6SS = 316 STAINLESS STEEL

COVER TYPE

(LEAVE BLANK) = NON-FLANGED
F = FLANGED
V = VENTED
FV = FLANGED VENTED

RADIUS

12 = 12"
24 = 24"

TRAY WIDTH

06 = 6" WIDE
09 = 9" WIDE
12 = 12" WIDE
18 = 18" WIDE
24 = 24" WIDE
36 = 36" WIDE



4 International Drive
Rye Brook, NY 10573
Toll Free: 1 888.764.7681
Phone: 914.934.2075
Fax: 914.934.2190
MonoSystems.com

MonoSystems™
wire management. managed.™

Cable Tray / Trough Tray SBX-COVX-HE30-XXXX

TroughTray™ Fittings

Manufactured in the USA by MonoSystems, Inc.



HORIZONTAL ELBOW 30° BEND COVER

Notes

- 1.) Ordered as each. Fittings ordered separately.
- 2.) Each cover provided with 8x1/2" self drilling TEK screws for mounting.
- 3.) Views for reference - do not scale.

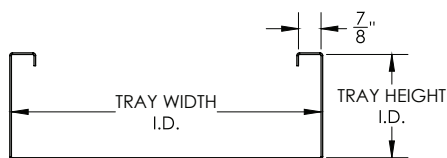
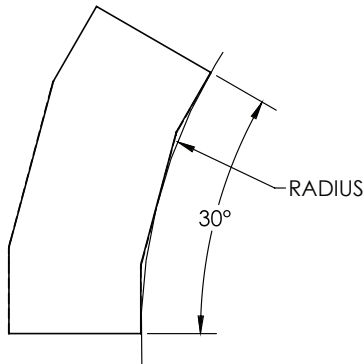

FILE: E80034
VOL.3

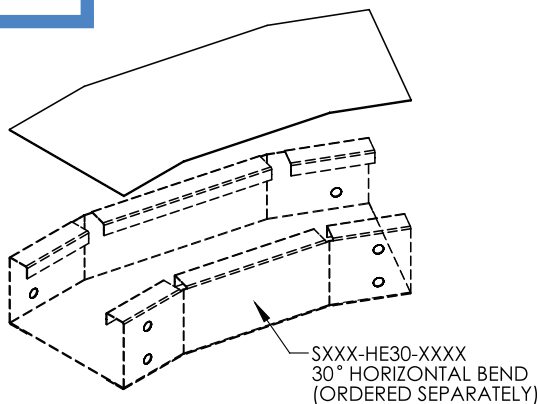

SXXX-HE30-XXXX
30° HORIZONTAL BEND
(ORDERED SEPARATELY)

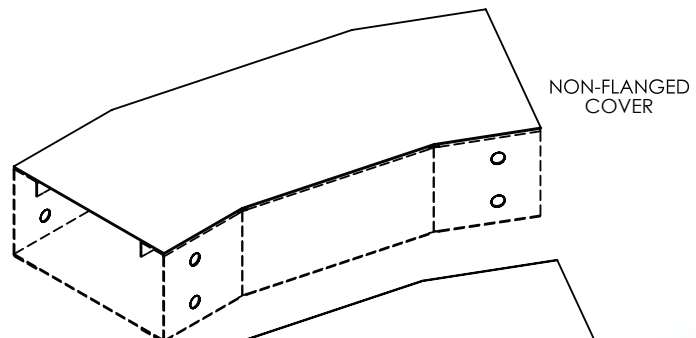

NON-FLANGED
COVER

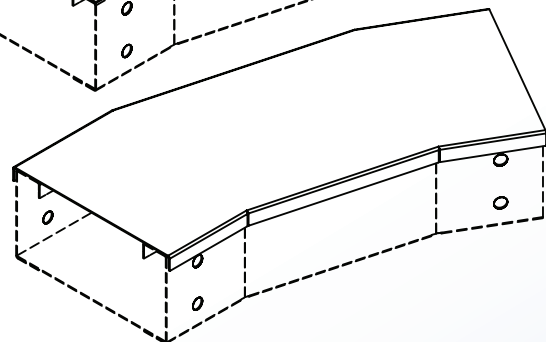

FLANGED
COVER

ORDERING DATA EXAMPLE:

SBX-COVX-HE30-XX XX

MATERIAL

P = STEEL
PRE-GALV
G = HDGAF
A = ALUMINUM
4SS = 304 STAINLESS STEEL
6SS = 316 STAINLESS STEEL

COVER TYPE

(LEAVE BLANK) = NON-FLANGED
F = FLANGED
V = VENTED
FV = FLANGED VENTED

RADIUS

12 = 12"
24 = 24"

TRAY WIDTH

06 = 6" WIDE
09 = 9" WIDE
12 = 12" WIDE
18 = 18" WIDE
24 = 24" WIDE
36 = 36" WIDE



4 International Drive
Rye Brook, NY 10573
Toll Free: 1 888.764.7681
Phone: 914.934.2075
Fax: 914.934.2190
MonoSystems.com

MonoSystems™
wire management. managed.™

Cable Tray / Trough Tray SBX-COVX-HE45-XXXX

TroughTray™ Fittings

Manufactured in the USA by MonoSystems, Inc.



HORIZONTAL ELBOW 45° BEND COVER

Notes

- 1.) Ordered as each. Fittings ordered separately.
- 2.) Each cover provided with 8x1/2" self drilling TEK screws for mounting.
- 3.) Views for reference - do not scale.

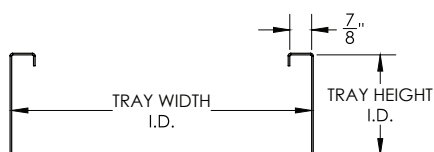
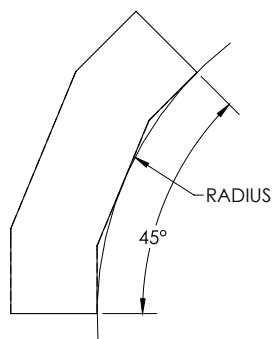

FILE: E80034
VOL.3

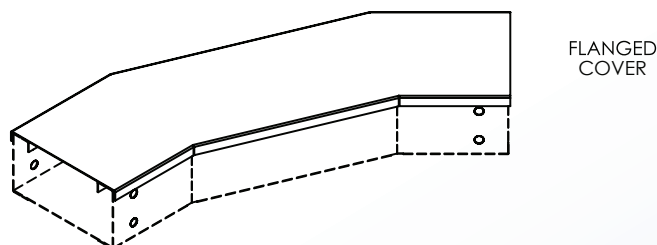
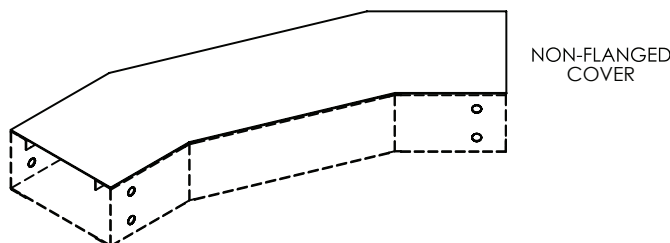
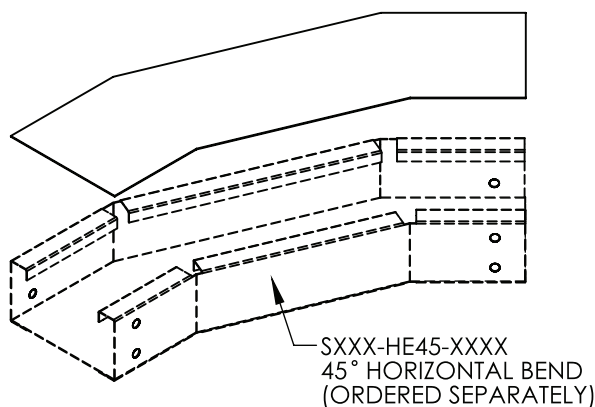

ORDERING DATA EXAMPLE:

SBX-COVX-HE45-XX XX

MATERIAL

P = STEEL
PRE-GALV
G = HDGAF
A = ALUMINUM
4SS = 304 STAINLESS STEEL
6SS = 316 STAINLESS STEEL

COVER TYPE

(LEAVE BLANK) = NON-FLANGED
F = FLANGED
V = VENTED
FV = FLANGED VENTED

RADIUS

12 = 12"
24 = 24"

TRAY WIDTH

06 = 6" WIDE
09 = 9" WIDE
12 = 12" WIDE
18 = 18" WIDE
24 = 24" WIDE
36 = 36" WIDE



4 International Drive
Rye Brook, NY 10573
Toll Free: 1 888.764.7681
Phone: 914.934.2075
Fax: 914.934.2190
MonoSystems.com

MonoSystems™
wire management. managed.™

Cable Tray / Trough Tray

SBX-COVX-HE90-XXXX

TroughTray™ Fittings

Manufactured in the USA by MonoSystems, Inc.



HORIZONTAL ELBOW 90° BEND COVER

Notes

- 1.) Ordered as each. Fittings ordered separately.
- 2.) Each cover provided with 8x1/2" self drilling TEK screws for mounting.
- 3.) Views for reference - do not scale.

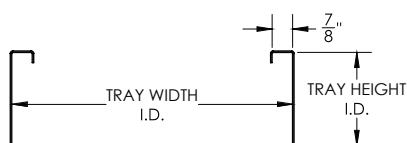
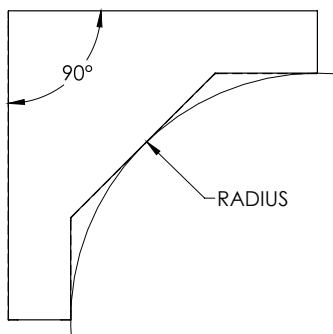

FILE: E80034
VOL.3

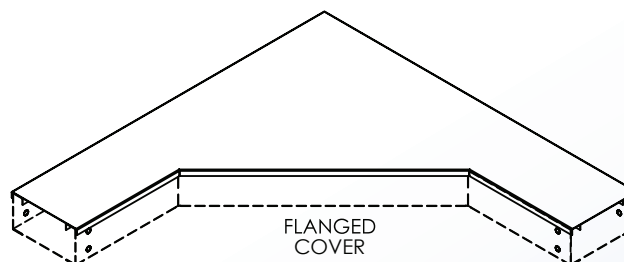
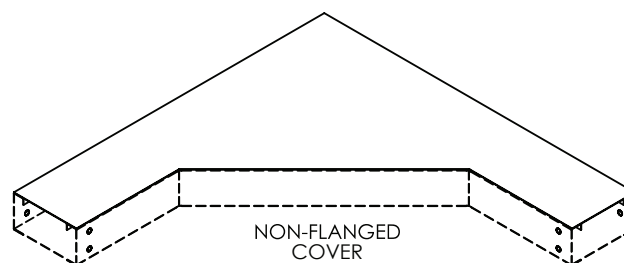
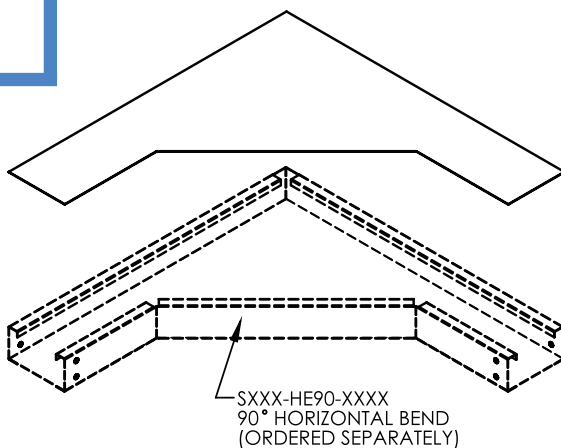

ORDERING DATA EXAMPLE:

SBX-COVX-HE90-XX XX

MATERIAL

P = STEEL
PRE-GALV
G = HDGAF
A = ALUMINUM
4SS = 304 STAINLESS STEEL
6SS = 316 STAINLESS STEEL

COVER TYPE

(LEAVE BLANK) = NON-FLANGED
F = FLANGED
V = VENTED
FV = FLANGED VENTED

RADIUS

12 = 12"
24 = 24"

TRAY WIDTH

06 = 6" WIDE
09 = 9" WIDE
12 = 12" WIDE
18 = 18" WIDE
24 = 24" WIDE
36 = 36" WIDE



4 International Drive
Rye Brook, NY 10573
Toll Free: 1 888.764.7681
Phone: 914.934.2075
Fax: 914.934.2190
MonoSystems.com

MonoSystems™
wire management. managed.™

Cable Tray / Trough Tray

SBX-COVX-HT-XXXX

TroughTray™ Fittings

Manufactured in the USA by MonoSystems, Inc.



HORIZONTAL TEE COVER

Notes

- 1.) Ordered as each. Fittings ordered separately.
- 2.) Each cover provided with 8x1/2" self drilling TEK screws for mounting.
- 3.) Views for reference - do not scale.

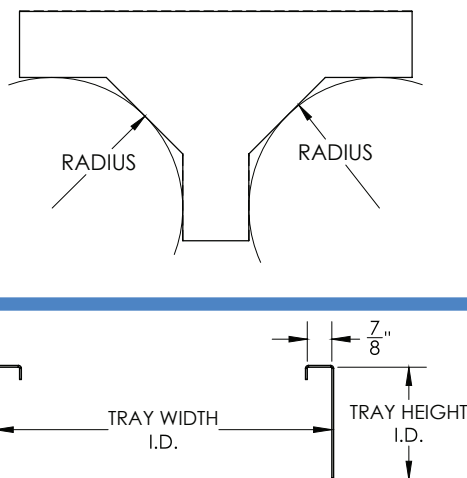

FILE: E80034
VOL.3

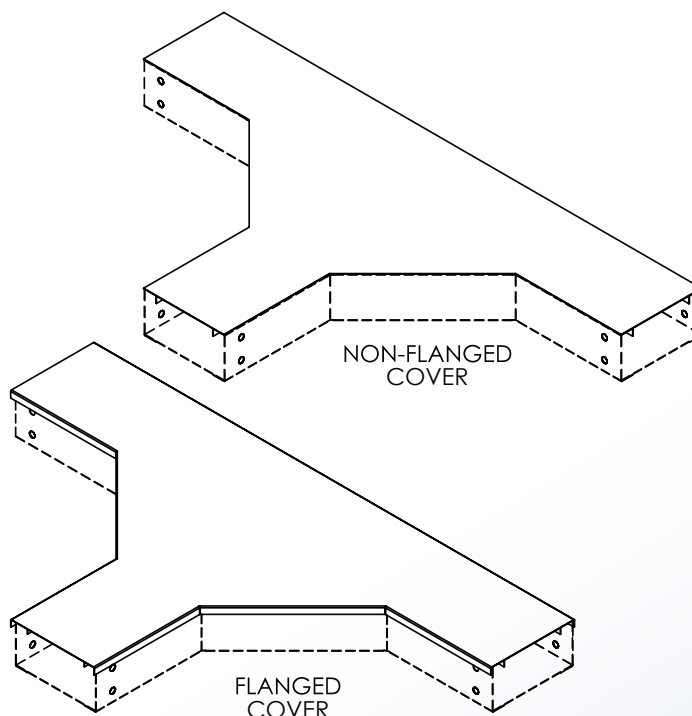
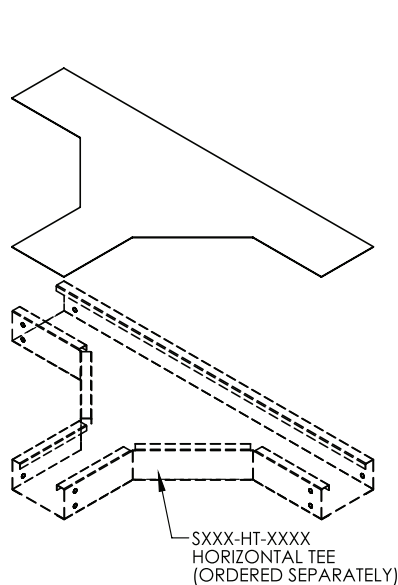

ORDERING DATA EXAMPLE:

SBX-COVX-HT-XX XX

MATERIAL

P = STEEL
PRE-GALV
G = HDGAF
A = ALUMINUM
4SS = 304 STAINLESS STEEL
6SS = 316 STAINLESS STEEL

COVER TYPE

(LEAVE BLANK) = NON-FLANGED
F = FLANGED
V = VENTED
FV = FLANGED VENTED

RADIUS

2.5 = 2 1/2"

TRAY WIDTH

06 = 6" WIDE
09 = 9" WIDE
12 = 12" WIDE
18 = 18" WIDE
24 = 24" WIDE
36 = 36" WIDE



MonoSystems™
wire management. managed.™

4 International Drive
Rye Brook, NY 10573
Toll Free: 1 888.764.7681
Phone: 914.934.2075
Fax: 914.934.2190
MonoSystems.com

Cable Tray / Trough Tray

SBX-COVX-IV45-XXXX

TroughTray™ Fittings

Manufactured in the USA by MonoSystems, Inc.



INSIDE VERTICAL ELBOW 45° BEND COVER

Notes

- 1.) Ordered as each. Fittings ordered separately.
- 2.) Each cover provided with 8x1/2" self drilling TEK screws for mounting.
- 3.) Views for reference - do not scale.

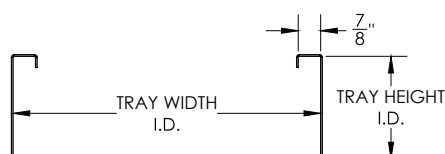
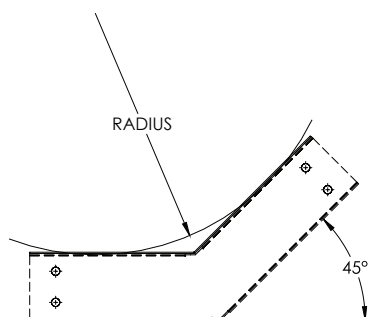

FILE: E80034
VOL.3

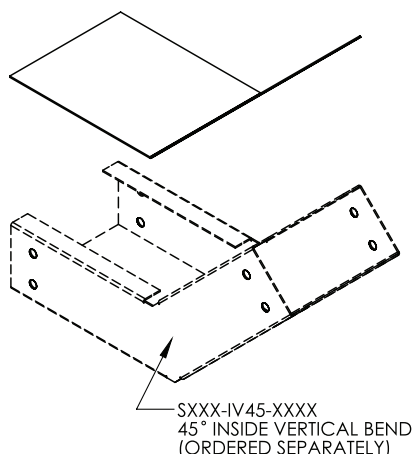

SXXX-IV45-XXXX
45° INSIDE VERTICAL BEND
(ORDERED SEPARATELY)

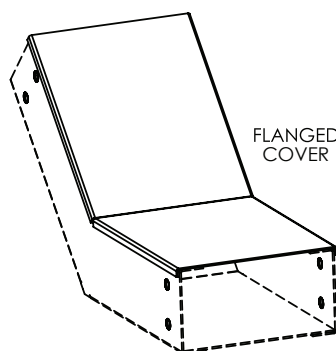

FLANGED
COVER

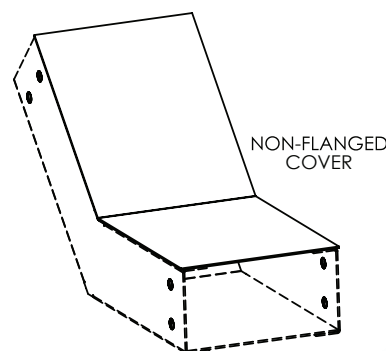

NON-FLANGED
COVER

ORDERING DATA EXAMPLE:

SBX-COVX-IV45-XX XX

MATERIAL

P = STEEL
PRE-GALV
G = HDGAF
A = ALUMINUM
4SS = 304 STAINLESS STEEL
6SS = 316 STAINLESS STEEL

COVER TYPE

(LEAVE BLANK) = NON-FLANGED
F = FLANGED
V = VENTED
FV = FLANGED VENTED

RADIUS

12 = 12"
24 = 24"

TRAY WIDTH

06 = 6" WIDE
09 = 9" WIDE
12 = 12" WIDE
18 = 18" WIDE
24 = 24" WIDE
36 = 36" WIDE



4 International Drive
Rye Brook, NY 10573
Toll Free: 1 888.764.7681
Phone: 914.934.2075
Fax: 914.934.2190
MonoSystems.com

MonoSystems™
wire management. managed.™

Cable Tray / Trough Tray

SBX-COVX-IV90-XXXX

TroughTray™ Fittings

Manufactured in the USA by MonoSystems, Inc.



INSIDE VERTICAL ELBOW 90° BEND COVER

Notes

- 1.) Ordered as each. Fittings ordered separately.
- 2.) Each cover provided with 8x1/2" self drilling TEK screws for mounting.
- 3.) Views for reference - do not scale.

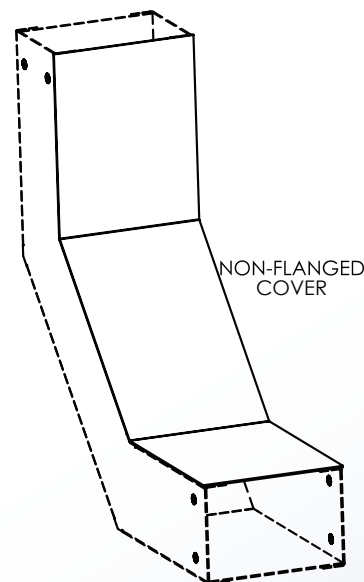
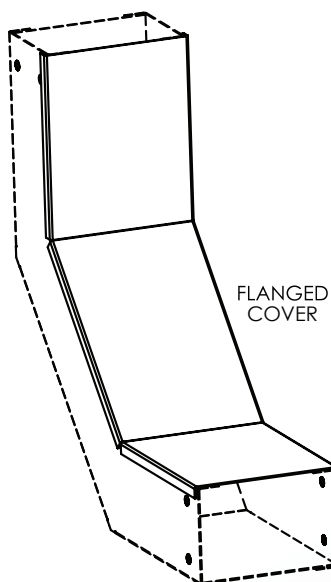
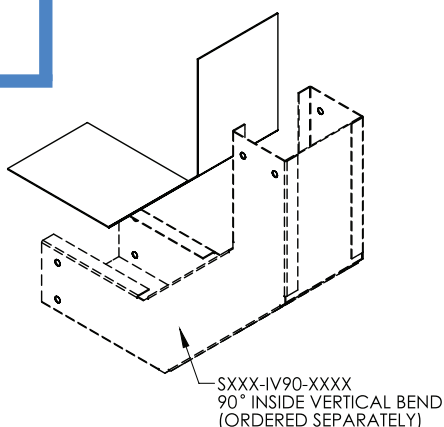
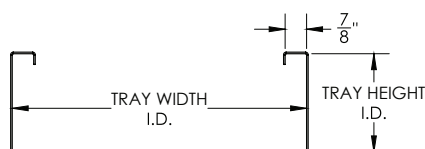
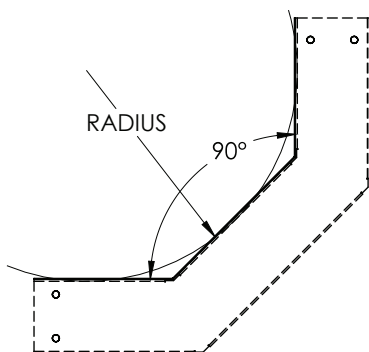

ORDERING DATA EXAMPLE:

SBX-COVX-IV90-XX XX

MATERIAL

P = STEEL
PRE-GALV
G = HDGAF
A = ALUMINUM
4SS = 304 STAINLESS STEEL
6SS = 316 STAINLESS STEEL

COVER TYPE

(LEAVE BLANK) = NON-FLANGED
F = FLANGED
V = VENTED
FV = FLANGED VENTED

RADIUS

12 = 12"
24 = 24"

TRAY WIDTH

06 = 6" WIDE
09 = 9" WIDE
12 = 12" WIDE
18 = 18" WIDE
24 = 24" WIDE
36 = 36" WIDE

4 International Drive
Rye Brook, NY 10573
Toll Free: 1 888.764.7681
Phone: 914.934.2075
Fax: 914.934.2190
MonoSystems.com



MonoSystems™
wire management. managed.

Cable Tray / Trough Tray

SBXX-COVX-OV45-XXXX

TroughTray™ Fittings

Manufactured in the USA by MonoSystems, Inc.



OUTSIDE VERTICAL ELBOW 45° BEND COVER

Notes

- 1.) Ordered as each. Fittings ordered separately.
- 2.) Each cover provided with 8x1/2" self drilling TEK screws for mounting.
- 3.) Views for reference - do not scale.

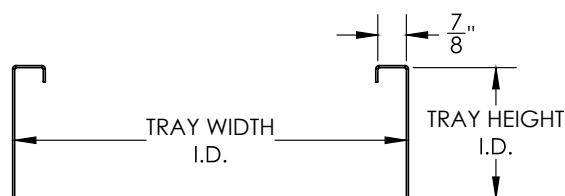
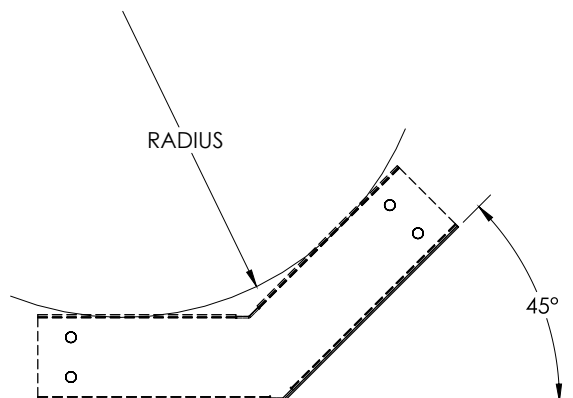

FILE: E80034
VOL.3

SXXX-OV45-XXXX
45° OUTSIDE VERTICAL BEND
(ORDERED SEPARATELY)

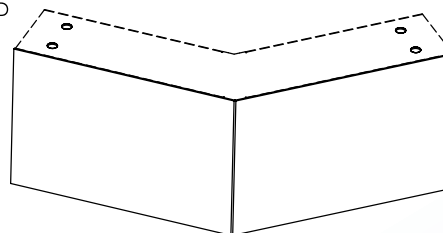
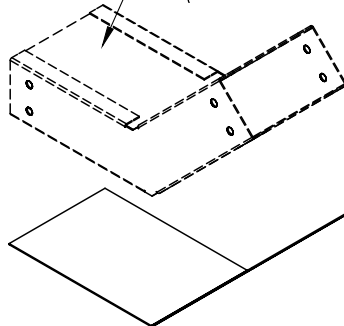

NON-FLANGED
COVER

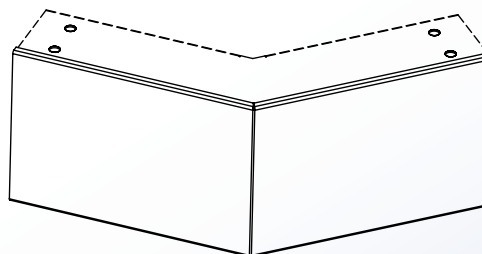

FLANGED
COVER

ORDERING DATA EXAMPLE:

SBXX-COVX-OV45-XXXX

MATERIAL

P = STEEL
PRE-GALV
G = HDGAF
A = ALUMINUM
4SS = 304 STAINLESS STEEL
6SS = 316 STAINLESS STEEL

TRAY HEIGHT

3 = 3" HIGH
4 = 4" HIGH
6 = 6" HIGH

COVER TYPE

(LEAVE BLANK) = NON-FLANGED
F = FLANGED
V = VENTED
FV = FLANGED VENTED

RADIUS

12 = 12"
24 = 24"

TRAY WIDTH

06 = 6" WIDE
09 = 9" WIDE
12 = 12" WIDE
18 = 18" WIDE
24 = 24" WIDE
36 = 36" WIDE

4 International Drive
Rye Brook, NY 10573
Toll Free: 1 888.764.7681
Phone: 914.934.2075
Fax: 914.934.2190
MonoSystems.com



MonoSystems™
wire management. managed.™

Cable Tray / Trough Tray

SBXX-COVX-OV90-XXXX

TroughTray™ Fittings

Manufactured in the USA by MonoSystems, Inc.



OUTSIDE VERTICAL ELBOW 90° BEND COVER

Notes

- 1.) Ordered as each. Fittings ordered separately.
- 2.) Each cover provided with 8x1/2" self drilling TEK screws for mounting.
- 3.) Views for reference - do not scale.

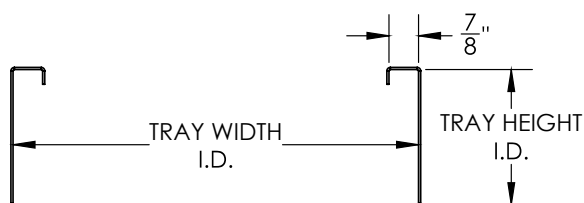
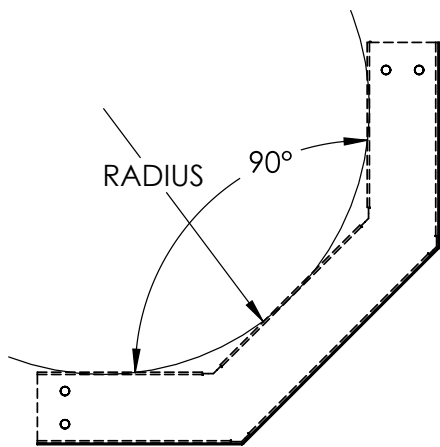

FILE: E80034
VOL.3

SXXX-OV90-XXXX
90° OUTSIDE VERTICAL BEND
(ORDERED SEPARATELY)

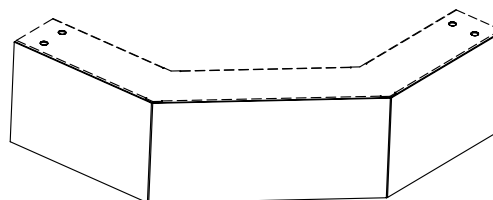
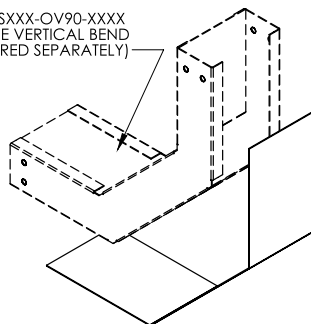

NON-FLANGED
COVER

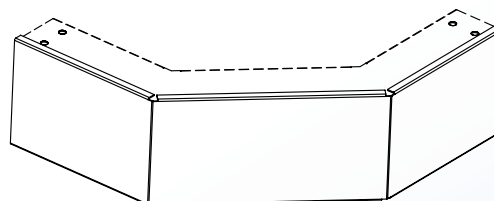

FLANGED
COVER

ORDERING DATA EXAMPLE:

SBXX-COVX-OV90-XXXX

MATERIAL	TRAY HEIGHT	COVER TYPE	RADIUS	TRAY WIDTH
P = STEEL	3 = 3" HIGH	(LEAVE BLANK) = NON-FLANGED	12 = 12"	06 = 6" WIDE
PRE-GALV	4 = 4" HIGH	F = FLANGED	24 = 24"	09 = 9" WIDE
G = HDGAF	6 = 6" HIGH	V = VENTED		12 = 12" WIDE
A = ALUMINUM		FV = FLANGED VENTED		18 = 18" WIDE
4SS = 304 STAINLESS STEEL				24 = 24" WIDE
6SS = 316 STAINLESS STEEL				36 = 36" WIDE

4 International Drive
Rye Brook, NY 10573
Toll Free: 1 888.764.7681
Phone: 914.934.2075
Fax: 914.934.2190
MonoSystems.com



MonoSystems™
wire management. managed.™

Cable Tray / Trough Tray SBXX-HC-XXXX

TroughTray™ Fittings

Manufactured in the USA by MonoSystems, Inc.

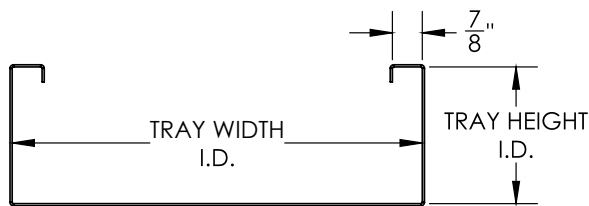
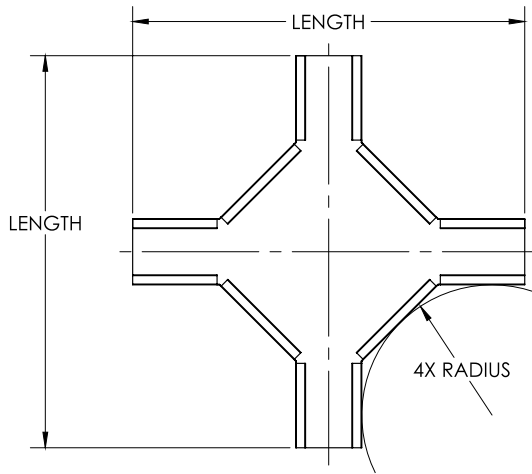

HORIZONTAL CROSS

Notes

- 1.) Ordered as each.
- 2.) Three u-splice connectors and 3/8" mounting hardware provided.
- 3.) Recommended torque: For 3/8" fasteners: 25-35 ft-lbs [33.9-47.5 N-m].
- 4.) Views for reference - do not scale.



FILE: E80034
VOL.3

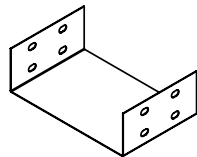

SBXX-USP-XX
U-SPLICE CONNECTOR

*ADDITIONAL RADIUS, VENTED BOTTOM,
AND PAINTED OPTIONS AVAILABLE
SPEAK WITH MONOSYSTEMS TO CHOOSE

ALUMINUM P/N	ALUMINUM GAUGE	STEEL GAUGE	HEIGHT (H)	WIDTH (W)	FOR 12"R LENGTH	FOR 24"R LENGTH
SBXX-HC-XX06	0.063"	20	3" 4" OR 6"	6"	36"	54"
SBXX-HC-XX09	0.063"	20	3" 4" OR 6"	9"	39"	57"
SBXX-HC-XX12	0.063"	20	3" 4" OR 6"	12"	42"	60"
SBXX-HC-XX18	0.063"	20	3" 4" OR 6"	18"	48"	66"
SBXX-HC-XX24	0.063"	20	3" 4" OR 6"	24"	54"	72"
SBXX-HC-XX36	0.080"	18	3" 4" OR 6"	36"	66"	84"

ORDERING DATA EXAMPLE:

SBXX-HC-XXXX

MATERIAL TRAY HEIGHT RADIUS TRAY WIDTH

P = STEEL	3 = 3" HIGH	12 = 12"	06 = 6" WIDE
PRE-GALV	4 = 4" HIGH	24 = 24"	09 = 9" WIDE
G = HDGAF	6 = 6" HIGH		12 = 12" WIDE
A = ALUMINUM			18 = 18" WIDE
4SS = 304 STAINLESS STEEL			24 = 24" WIDE
6SS = 316 STAINLESS STEEL			36 = 36" WIDE

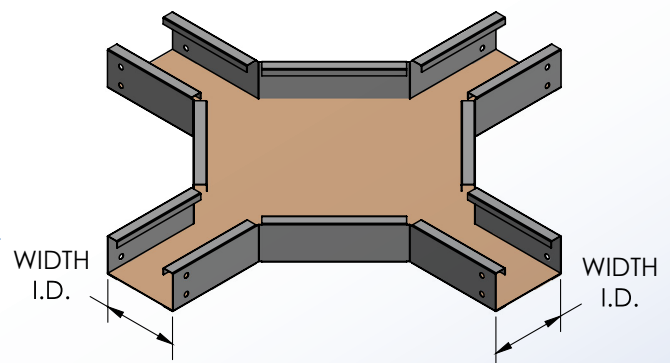

4 International Drive
Rye Brook, NY 10573
Toll Free: 1 888.764.7681
Phone: 914.934.2075
Fax: 914.934.2190
MonoSystems.com



MonoSystems™
wire management. managed.™

Cable Tray / Trough Tray SBXX-HE30-XXXX

TroughTray™ Fittings

Manufactured in the USA by MonoSystems, Inc.



HORIZONTAL ELBOW, 30°

Notes

- 1.) Ordered as each. Use to make a 30° bend.
- 2.) One u-splice and 3/8" mounting hardware provided.
- 3.) Recommended torque: for 3/8" fasteners: 25-35 ft-lbs [33.9-47.5 N-m].
- 4.) Views for reference - do not scale.

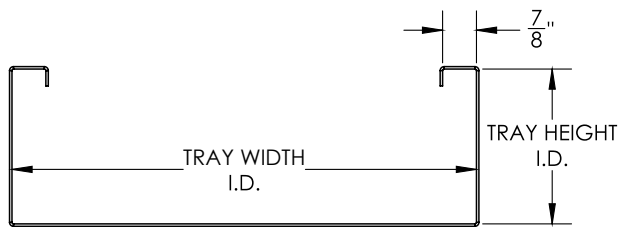
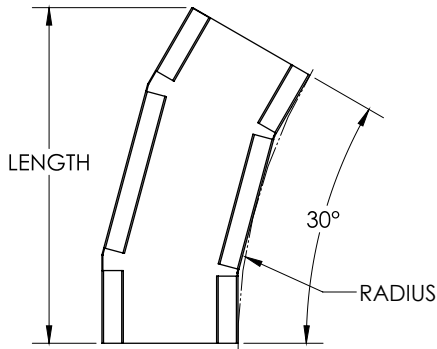

FILE: E80034
VOL.3

ORDERING DATA EXAMPLE:

SBXX-HE30-XXXX

MATERIAL TRAY HEIGHT ANGLE RADIUS TRAY WIDTH

P = STEEL	3 = 3" HIGH	30 = 30°	12 = 12"	06 = 6" WIDE
PRE-GALV	4 = 4" HIGH		24 = 24"	09 = 9" WIDE
G = HDGAF	6 = 6" HIGH			12 = 12" WIDE
A = ALUMINUM				18 = 18" WIDE
4SS = 304 STAINLESS STEEL				24 = 24" WIDE
6SS = 316 STAINLESS STEEL				36 = 36" WIDE

*ADDITIONAL RADIUS, VENTED BOTTOM,
AND PAINTED OPTIONS AVAILABLE
SPEAK WITH MONOSYSTEMS TO CHOOSE

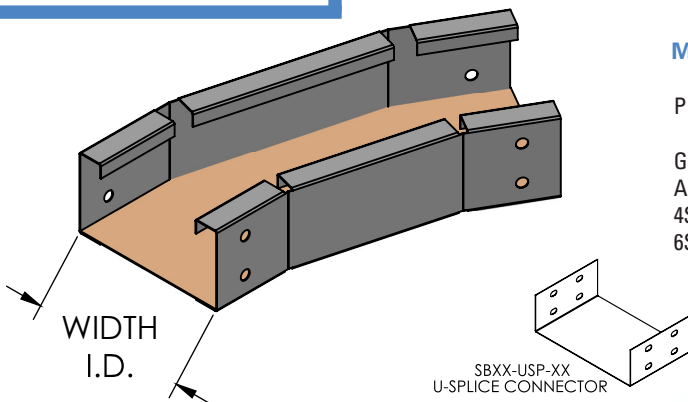

ALUMINUM P/N	ALUMINUM GAUGE	STEEL GAUGE	HEIGHT (H)	WIDTH (W)	FOR 12"R LENGTH (L)	FOR 24"R LENGTH (L)
SBXX-HE30-XX06	0.063"	20	3," 4" OR 6"	6"	9"	15"
SBXX-HE30-XX09	0.063"	20	3," 4" OR 6"	9"	10-1/2"	16-1/2"
SBXX-HE30-XX12	0.063"	20	3," 4" OR 6"	12"	12"	18"
SBXX-HE30-XX18	0.063"	20	3," 4" OR 6"	18"	15"	21"
SBXX-HE30-XX24	0.063"	20	3," 4" OR 6"	24"	18"	24"
SBXX-HE30-XX36	0.080"	18	3," 4" OR 6"	36"	24"	30"

4 International Drive
Rye Brook, NY 10573
Toll Free: 1 888.764.7681
Phone: 914.934.2075
Fax: 914.934.2190
MonoSystems.com



MonoSystems™
wire management. managed.™

Cable Tray / Trough Tray

SBXX-HE45-XXXX

TroughTray™ Fittings

Manufactured in the USA by MonoSystems, Inc.



HORIZONTAL ELBOW, 45°

Notes

- 1.) Ordered as each. Use to make 45° bend.
- 2.) One u-splice connector and 3/8" hardware provided.
- 3.) Recommended torque: For 3/8" fasteners: 25-35 ft-lbs [33.9-47.5 N-m].
- 4.) Views for reference - do not scale.

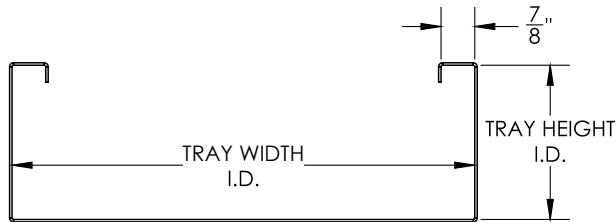
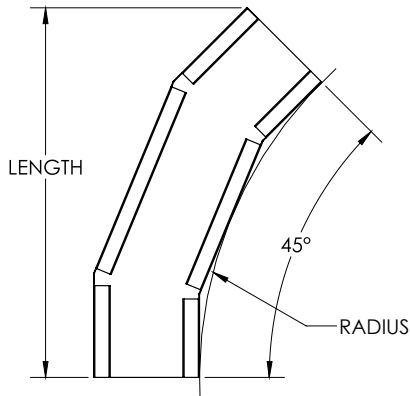

FILE: E80034
VOL.3

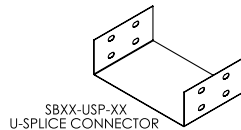

ORDERING DATA EXAMPLE:

SBXX-HE45-XXXX

MATERIAL TRAY HEIGHT ANGLE RADIUS TRAY WIDTH

P = STEEL	3 = 3" HIGH	45 = 45°	12 = 12"	06 = 6" WIDE
PRE-GALV	4 = 4" HIGH		24 = 24"	09 = 9" WIDE
G = HDGAF	6 = 6" HIGH			12 = 12" WIDE
A = ALUMINUM				18 = 18" WIDE
4SS = 304 STAINLESS STEEL				24 = 24" WIDE
6SS = 316 STAINLESS STEEL				36 = 36" WIDE

*ADDITIONAL RADIUS, VENTED BOTTOM,
AND PAINTED OPTIONS AVAILABLE
SPEAK WITH MONOSYSTEMS TO CHOOSE

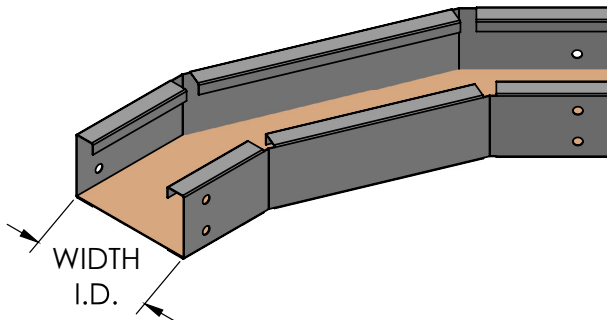

ALUMINUM P/N	ALUMINUM GAUGE	STEEL GAUGE	HEIGHT (H)	WIDTH (W)	FOR 12"R LENGTH (L)	FOR 24"R LENGTH (L)
SBXX-HE45-XX06	0.063"	20	3," 4" OR 6"	6"	12-3/4"	21-7/32"
SBXX-HE45-XX09	0.063"	20	3," 4" OR 6"	9"	14-7/8"	23-11/32"
SBXX-HE45-XX12	0.063"	20	3," 4" OR 6"	12"	16-31/32"	25-15/32"
SBXX-HE45-XX18	0.063"	20	3," 4" OR 6"	18"	21-7/32"	29-11/16"
SBXX-HE45-XX24	0.063"	20	3," 4" OR 6"	24"	25-15/32"	33-15/16"
SBXX-HE45-XX36	0.080"	18	3," 4" OR 6"	36"	33-15/16"	42-7/16"



4 International Drive
Rye Brook, NY 10573
Toll Free: 1 888.764.7681
Phone: 914.934.2075
Fax: 914.934.2190
MonoSystems.com

MonoSystems™
wire management. managed.™

Cable Tray / Trough Tray SBXX-HE90-XXXX

TroughTray™ Fittings

Manufactured in the USA by MonoSystems, Inc.

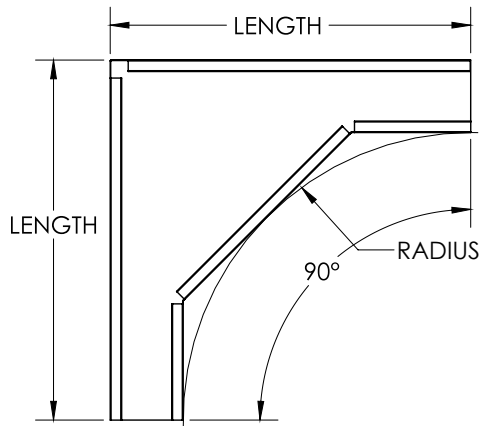

HORIZONTAL ELBOW, 90°

Notes

- 1.) Ordered as each. Use to make 90° bend.
- 2.) One u-splice connector and 3/8" hardware provided.
- 3.) Recommended torque: For 3/8" fasteners: 25-35 ft-lbs [33.9-47.5 N-m].
- 4.) Views for reference - do not scale.

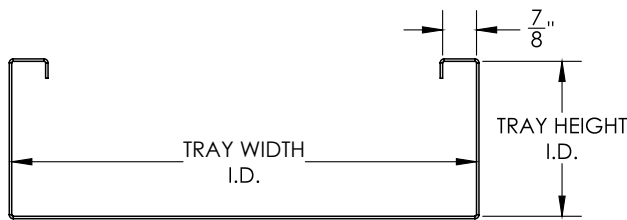

FILE: E80034
VOL.3

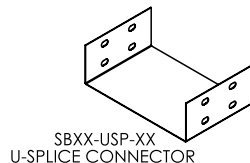

ORDERING DATA EXAMPLE:

SBXX-HE90-XXXX

MATERIAL	TRAY HEIGHT	ANGLE	RADIUS	TRAY WIDTH
P = STEEL	3 = 3" HIGH	90 = 90°	12 = 12"	06 = 6" WIDE
PRE-GALV	4 = 4" HIGH		24 = 24"	09 = 9" WIDE
G = HDGAF	6 = 6" HIGH			12 = 12" WIDE
A = ALUMINUM				18 = 18" WIDE
4SS = 304 STAINLESS STEEL				24 = 24" WIDE
6SS = 316 STAINLESS STEEL				36 = 36" WIDE

*ADDITIONAL RADIUS, VENTED BOTTOM,
AND PAINTED OPTIONS AVAILABLE
SPEAK WITH MONOSYSTEMS TO CHOOSE

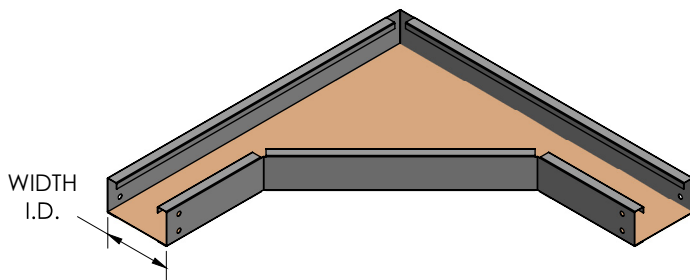

ALUMINUM P/N	ALUMINUM GAUGE	STEEL GAUGE	HEIGHT (H)	WIDTH (W)	FOR 12"R LENGTH (L)	FOR 24"R LENGTH (L)
SBXX-HE90-XX06	0.063"	20	3," 4" OR 6"	6"	21"	30"
SBXX-HE90-XX09	0.063"	20	3," 4" OR 6"	9"	24"	33"
SBXX-HE90-XX12	0.063"	20	3," 4" OR 6"	12"	27"	36"
SBXX-HE90-XX18	0.063"	20	3," 4" OR 6"	18"	33"	42"
SBXX-HE90-XX24	0.063"	20	3," 4" OR 6"	24"	39"	48"
SBXX-HE90-XX36	0.080"	18	3," 4" OR 6"	36"	51"	60"



4 International Drive
Rye Brook, NY 10573
Toll Free: 1 888.764.7681
Phone: 914.934.2075
Fax: 914.934.2190
MonoSystems.com

MonoSystems™
wire management. managed.™

Cable Tray / Trough Tray SBXX-HT-XXXX

TroughTray™ Fittings

Manufactured in the USA by MonoSystems, Inc.



HORIZONTAL TEE

Notes

- 1.) Ordered as each.
- 3.) 2 U-splice connectors, and 3/8" mounting hardware provided.
- 3.) Recommended torque: For 3/8" fasteners: 25-35 ft-lbs [33.9-47.5 N-m].
- 4.) Views for reference - do not scale.

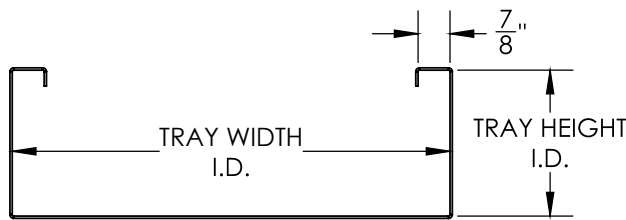
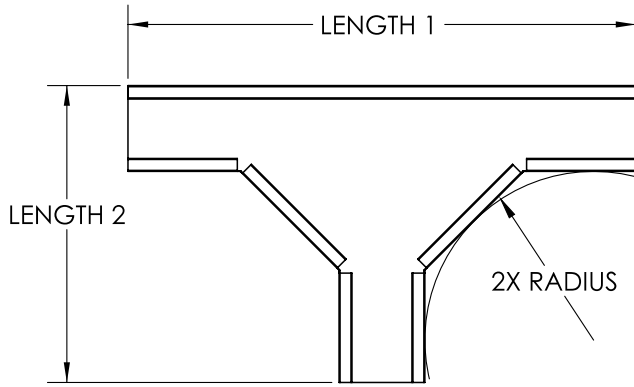

FILE: E80034
VOL.3

ALUMINUM P/N	ALUMINUM GAUGE	STEEL GAUGE	HEIGHT (H)	WIDTH (W)	FOR 12"R LENGTH 1	FOR 24"R LENGTH 1	FOR 12"R LENGTH 2	FOR 24"R LENGTH 2
SBXX-HT-XX06	0.063"	20	3," 4" OR 6"	6"	36"	54"	21"	30"
SBXX-HT-XX09	0.063"	20	3," 4" OR 6"	9"	39"	57"	24"	33"
SBXX-HT-XX12	0.063"	20	3," 4" OR 6"	12"	42"	60"	27"	36"
SBXX-HT-XX18	0.063"	20	3," 4" OR 6"	18"	48"	66"	33"	42"
SBXX-HT-XX24	0.063"	20	3," 4" OR 6"	24"	54"	72"	39"	48"
SBXX-HT-XX36	0.080"	18	3," 4" OR 6"	36"	66"	84"	51"	60"

ORDERING DATA EXAMPLE:

SBXX-HT-XXXX

MATERIAL **TRAY HEIGHT** **RADIUS** **TRAY WIDTH**

P = STEEL 3 = 3" HIGH 12 = 12" 06 = 6" WIDE
 PRE-GALV 4 = 4" HIGH 24 = 24" 09 = 9" WIDE
 G = HDGAF 6 = 6" HIGH 12 = 12" WIDE
 A = ALUMINUM 18 = 18" WIDE
 4SS = 304 STAINLESS STEEL 24 = 24" WIDE
 6SS = 316 STAINLESS STEEL 36 = 36" WIDE

*ADDITIONAL RADIUS, VENTED BOTTOM,
AND PAINTED OPTIONS AVAILABLE
SPEAK WITH MONOSYSTEMS TO CHOOSE

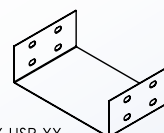
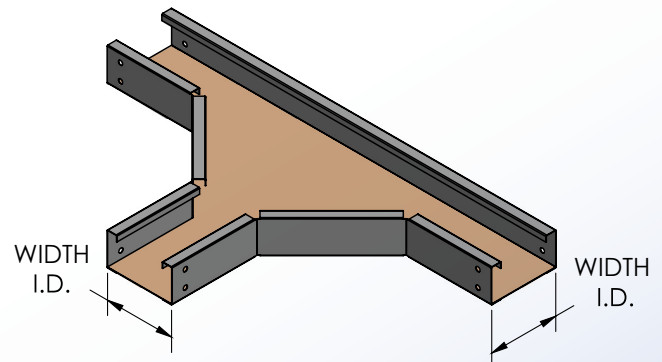

SBXX-USP-XX
U-SPLICE CONNECTOR

4 International Drive
Rye Brook, NY 10573
Toll Free: 1 888.764.7681
Phone: 914.934.2075
Fax: 914.934.2190
MonoSystems.com



MonoSystems™
wire management. managed.™

Cable Tray / Trough Tray SBXX-IV45-XXXX

TroughTray™ Fittings

Manufactured in the USA by MonoSystems, Inc.



INSIDE VERTICAL ELBOW 45° BEND

Notes

- 1.) Ordered as each.
- 2.) One u-splice connector and 3/8" mounting hardware provided.
- 3.) Recommended torque: For 3/8" fasteners: 25-35 ft-lbs [33.9-47.5 N-m].
- 4.) Views for reference - do not scale.

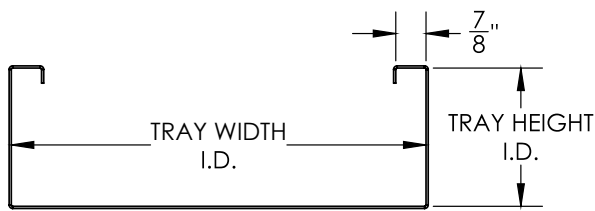
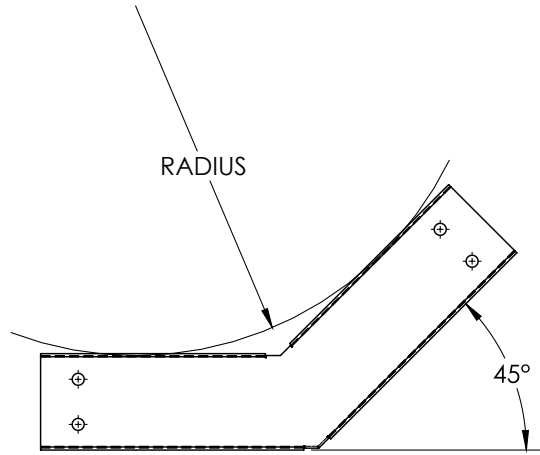

FILE: E80034
VOL.3

*ADDITIONAL RADIUS, VENTED BOTTOM,
AND PAINTED OPTIONS AVAILABLE
SPEAK WITH MONOSYSTEMS TO CHOOSE

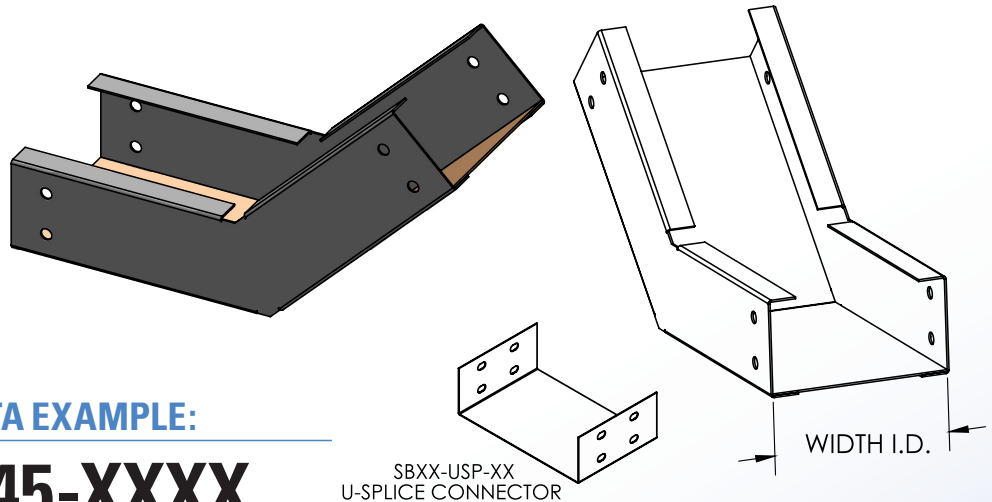

ORDERING DATA EXAMPLE:

SBXX-IV45-XXXX

MATERIAL TRAY HEIGHT RADIUS TRAY WIDTH

P = STEEL	3 = 3" HIGH	12 = 12"	06 = 6" WIDE
PRE-GALV	4 = 4" HIGH	24 = 24"	09 = 9" WIDE
G = HDGAF	6 = 6" HIGH		12 = 12" WIDE
A = ALUMINUM			18 = 18" WIDE
4SS = 304 STAINLESS STEEL			24 = 24" WIDE
6SS = 316 STAINLESS STEEL			36 = 36" WIDE

SBXX-USP-XX
U-SPLICE CONNECTOR

WIDTH I.D.



4 International Drive
Rye Brook, NY 10573
Toll Free: 1 888.764.7681
Phone: 914.934.2075
Fax: 914.934.2190
MonoSystems.com

MonoSystems™
wire management. managed.™

Cable Tray / Trough Tray SBXX-IV90-XXXX

TroughTray™ Fittings

Manufactured in the USA by MonoSystems, Inc.



INSIDE VERTICAL ELBOW 90° BEND

Notes

- 1.) Ordered as each.
- 2.) One u-splice connector and 3/8" mounting hardware provided.
- 3.) Recommended torque: For 3/8" fasteners: 25-35 ft-lbs [33.9-47.5 N-m].
- 4.) Views for reference - do not scale.

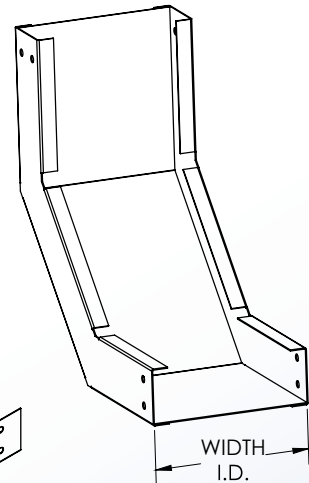
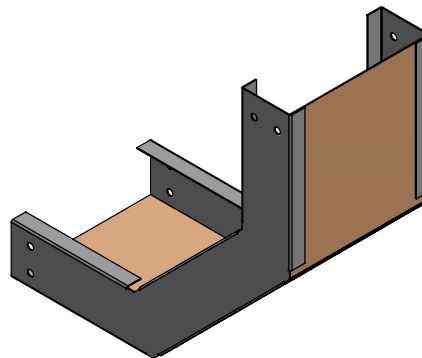
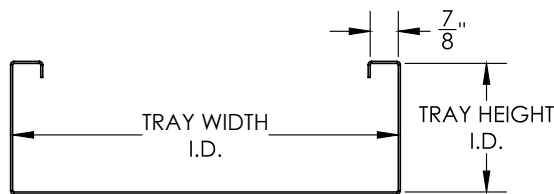
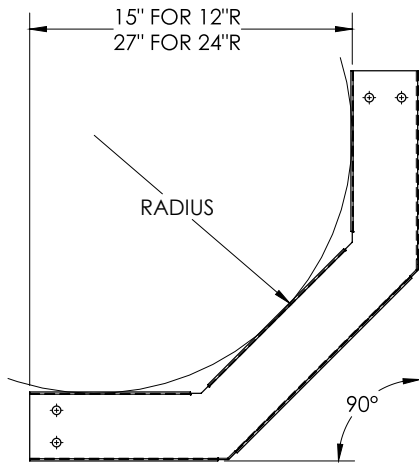

SBXX-USP-XX
U-SPLICE CONNECTOR

ORDERING DATA EXAMPLE:

SBXX-IV90-XXXX

MATERIAL	TRAY HEIGHT	RADIUS	TRAY WIDTH
P = STEEL	3 = 3" HIGH	12 = 12"	06 = 6" WIDE
PRE-GALV	4 = 4" HIGH	24 = 24"	09 = 9" WIDE
G = HDGAF	6 = 6" HIGH		12 = 12" WIDE
A = ALUMINUM			18 = 18" WIDE
4SS = 304 STAINLESS STEEL			24 = 24" WIDE
6SS = 316 STAINLESS STEEL			36 = 36" WIDE

*ADDITIONAL RADIUS, VENTED BOTTOM,
AND PAINTED OPTIONS AVAILABLE
SPEAK WITH MONOSYSTEMS TO CHOOSE

4 International Drive
Rye Brook, NY 10573
Toll Free: 1 888.764.7681
Phone: 914.934.2075
Fax: 914.934.2190
MonoSystems.com



MonoSystems™
wire management. managed.™

Cable Tray / Trough Tray SBXX-OV45-XXXX

TroughTray™ Fittings

Manufactured in the USA by MonoSystems, Inc.



OUTSIDE VERTICAL ELBOW 45° BEND

Notes

- 1.) Ordered as each.
- 2.) One u-splice connector and 3/8" mounting hardware provided.
- 3.) Recommended torque: For 3/8" fasteners: 25-35 ft-lbs [33.9-47.5 N-m].
- 4.) Views for reference - do not scale.

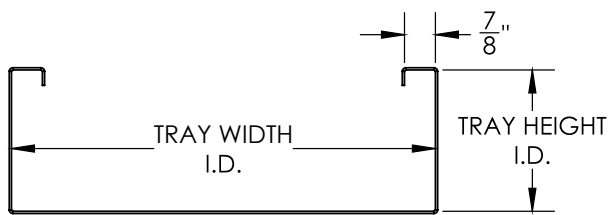
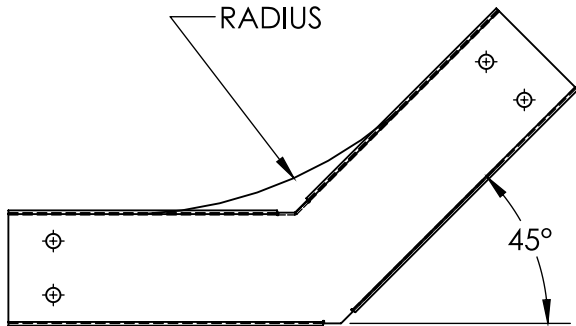

FILE: E80034
VOL.3

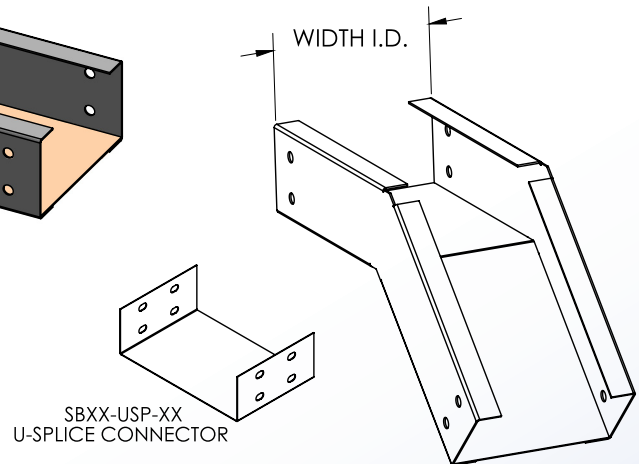
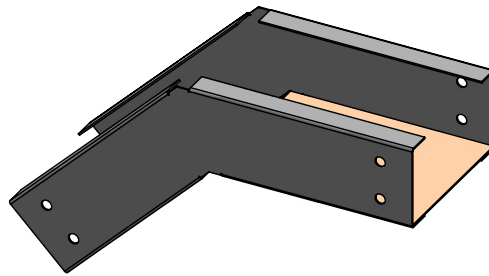

ORDERING DATA EXAMPLE:

SBXX-OV45-XXXX

MATERIAL	TRAY HEIGHT	RADIUS	TRAY WIDTH
P = STEEL	3 = 3" HIGH	12 = 12"	06 = 6" WIDE
PRE-GALV	4 = 4" HIGH	24 = 24"	09 = 9" WIDE
G = HDGAF	6 = 6" HIGH		12 = 12" WIDE
A = ALUMINUM			18 = 18" WIDE
4SS = 304 STAINLESS STEEL			24 = 24" WIDE
6SS = 316 STAINLESS STEEL			36 = 36" WIDE

*ADDITIONAL RADIUS, VENTED BOTTOM,
AND PAINTED OPTIONS AVAILABLE
SPEAK WITH MONOSYSTEMS TO CHOOSE

4 International Drive
Rye Brook, NY 10573
Toll Free: 1 888.764.7681
Phone: 914.934.2075
Fax: 914.934.2190
MonoSystems.com



MonoSystems™
wire management. managed.™

Cable Tray / Trough Tray SBXX-OV90-XXXX

TroughTray™ Fittings

Manufactured in the USA by MonoSystems, Inc.



OUTSIDE VERTICAL ELBOW 90° BEND

Notes

- 1.) Ordered as each.
- 2.) One u-splice connector and 3/8" mounting hardware provided.
- 3.) Recommended torque: For 3/8" fasteners: 25-35 ft-lbs [33.9-47.5 N-m].
- 4.) Views for reference - do not scale.

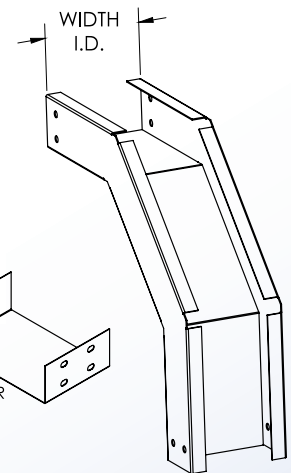
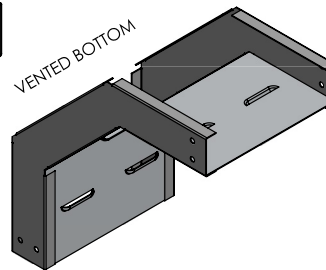
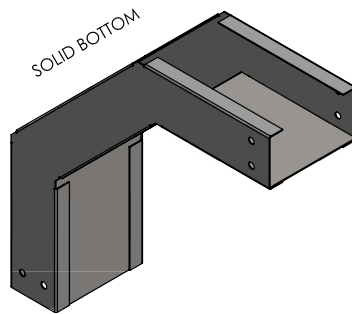
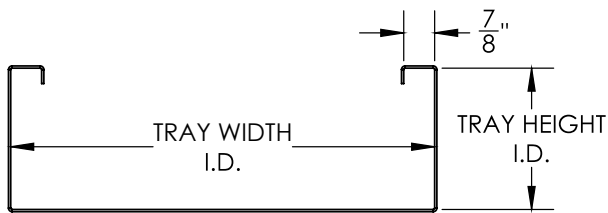
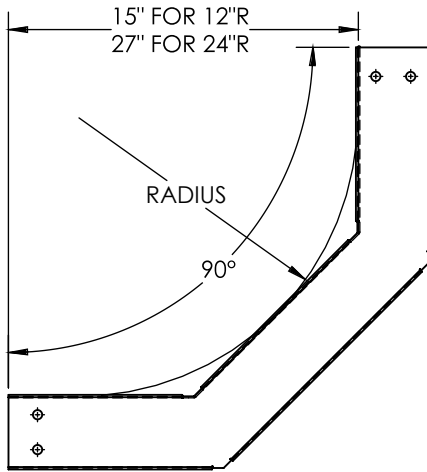

SBXX-USP-XX
U-SPLICE CONNECTOR

*ADDITIONAL RADIUS AND PAINTED OPTIONS
AVAILABLE SPEAK WITH MONOSYSTEMS TO CHOOSE

ORDERING DATA EXAMPLE:

SBXX-OV90-XXXX

TYPE	MATERIAL	TRAY HEIGHT	RADIUS	TRAY WIDTH
B = SOLID BOTTOM	P = STEEL PRE-GALV	3 = 3" HIGH 4 = 4" HIGH	12 = 12" 24 = 24"	06 = 6" WIDE 09 = 9" WIDE
V = VENTED BOTTOM	G = HDGAF A = ALUMINUM	6 = 6" HIGH		12 = 12" WIDE 18 = 18" WIDE 24 = 24" WIDE 36 = 36" WIDE
	4SS = 304 STAINLESS STEEL 6SS = 316 STAINLESS STEEL			



4 International Drive
Rye Brook, NY 10573
Toll Free: 1 888.764.7681
Phone: 914.934.2075
Fax: 914.934.2190
MonoSystems.com

MonoSystems™
wire management. managed.™

Cable Tray / Trough Tray SBXX-SR-XXXX

TroughTray™ Fittings

Manufactured in the USA by MonoSystems, Inc.



STRAIGHT REDUCER

Notes

- 1.) Ordered as each.
- 2.) One u-splice connector and 3/8" hardware provided.
- 3.) Recommended torque: For 3/8" fasteners: 25-35 ft-lbs [33.9-47.5 N-m].
- 4.) Views for reference - do not scale.

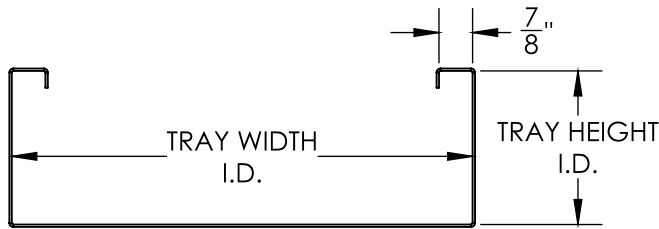
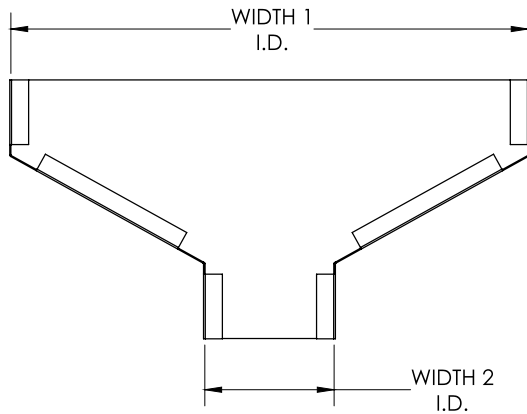

FILE: E80034
VOL.3

ORDERING DATA EXAMPLE:

SBXX-SR-XXXX

MATERIAL	TRAY HEIGHT	WIDTH 1	WIDTH 2
P = STEEL	3 = 3" HIGH	09 = 9" WIDE	06 = 6" WIDE
PRE-GALV	4 = 4" HIGH	12 = 12" WIDE	09 = 9" WIDE
G = HDGAF	6 = 6" HIGH	18 = 18" WIDE	12 = 12" WIDE
A = ALUMINUM		24 = 24" WIDE	18 = 18" WIDE
4SS = 304 STAINLESS STEEL		36 = 36" WIDE	24 = 24" WIDE
6SS = 316 STAINLESS STEEL			

*ADDITIONAL RADIUS, VENTED BOTTOM,
AND PAINTED OPTIONS AVAILABLE
SPEAK WITH MONOSYSTEMS TO CHOOSE

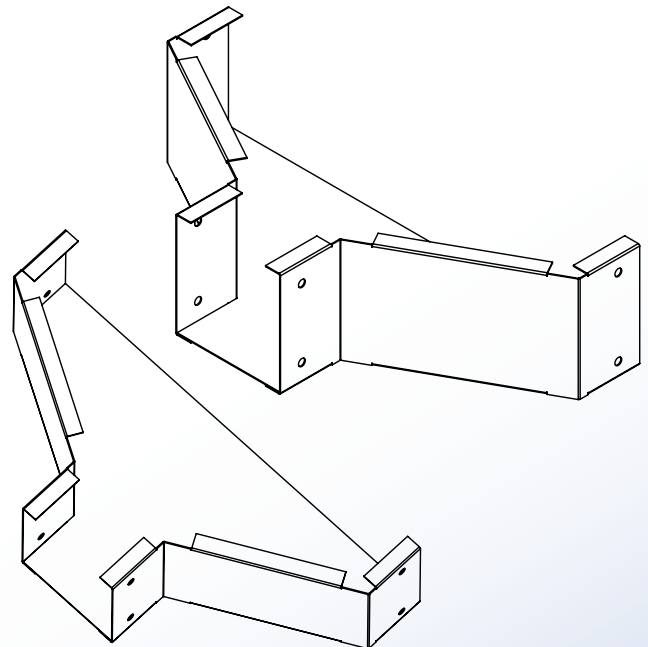

4 International Drive
Rye Brook, NY 10573
Toll Free: 1 888.764.7681
Phone: 914.934.2075
Fax: 914.934.2190
MonoSystems.com



MonoSystems™
wire management. managed.™

Cable Tray / Trough Tray

SVXX-HE90-XXXX

TroughTray™ Fittings

Manufactured in the USA by MonoSystems, Inc.



HORIZONTAL ELBOW, 90° VENTED BOTTOM

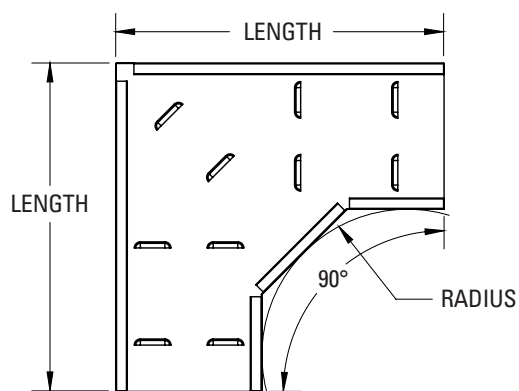
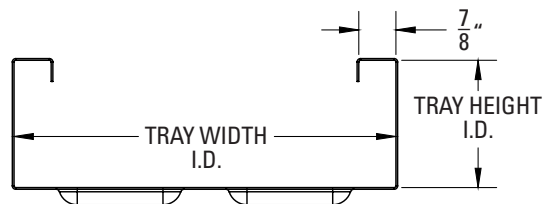

Notes

- 1.) Ordered as each. Use to make a 90° bend.
- 2.) Exact vent pattern and quantity will vary depending on size.
- 3.) One u-splice and 3/8" mounting hardware provided.
- 4.) Recommended torque: for 3/8" fasteners: 25-35 ft-lbs [33.9-47.5 N-m].
- 5.) Views for reference - do not scale.



FILE: 80034

ORDERING DATA EXAMPLE:

S V X X - H E 9 0 - X X X X

STYLE

MATERIAL

TRAY HEIGHT

ANGLE

RADIUS

TRAY WIDTH

V = VENTED
BOTTOM

P = STEEL PRE-GALV
G = HDGAF
A = ALUMINUM
4SS = 304 STAINLESS STEEL
6SS = 316 STAINLESS STEEL

3 = 3" HIGH
4 = 4" HIGH
6 = 6" HIGH

90 = 90°
12 = 12" RADIUS
24 = 24" RADIUS

06 = 6" WIDE
09 = 9" WIDE
12 = 12" WIDE
18 = 18" WIDE
24 = 24" WIDE
36 = 36" WIDE

*ADDITIONAL RADIUS, SOLID BOTTOM,
AND PAINTED OPTIONS AVAILABLE
SPEAK WITH MONOSYSTEMS TO CHOOSE

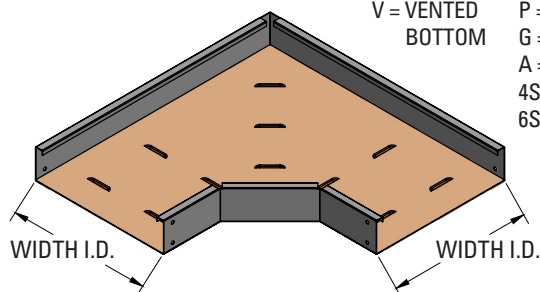

ALUMINUM P/N	ALUMINUM GAUGE	STEEL GAUGE	HEIGHT (H)	WIDTH (W)	FOR 12" R LENGTH (L)	FOR 24" R LENGTH (L)
SVXX-HE90-XX06	0.063"	20	3," 4" OR 6"	6"	21"	30"
SVXX-HE90-XX09	0.063"	20	3," 4" OR 6"	9"	24"	33"
SVXX-HE90-XX12	0.063"	20	3," 4" OR 6"	12"	27"	36"
SVXX-HE90-XX18	0.063"	20	3," 4" OR 6"	18"	33"	42"
SVXX-HE90-XX24	0.063"	20	3," 4" OR 6"	24"	39"	48"
SVXX-HE90-XX36	0.080"	18	3," 4" OR 6"	36"	51"	60"



4 International Drive
Rye Brook, NY 10573
Toll Free: 1 888.764.7681
Phone: 914.934.2075
Fax: 914.934.2190
MonoSystems.com



MonoSystems™
wire management. managed.™

Cable Tray / Trough Tray

SVXX-HT-XXXX

TroughTray™ Fittings

Manufactured in the USA by MonoSystems, Inc.



HORIZONTAL TEE, VENTED BOTTOM

Notes

- 1.) Ordered as each.
- 2.) Exact vent pattern and quantity will vary depending on size.
- 3.) One pair of u-splice and 3/8" mounting hardware provided.
- 4.) Recommended torque: for 3/8" fasteners: 25-35 ft-lbs [33.9-47.5 N-m].
- 5.) Views for reference - do not scale.

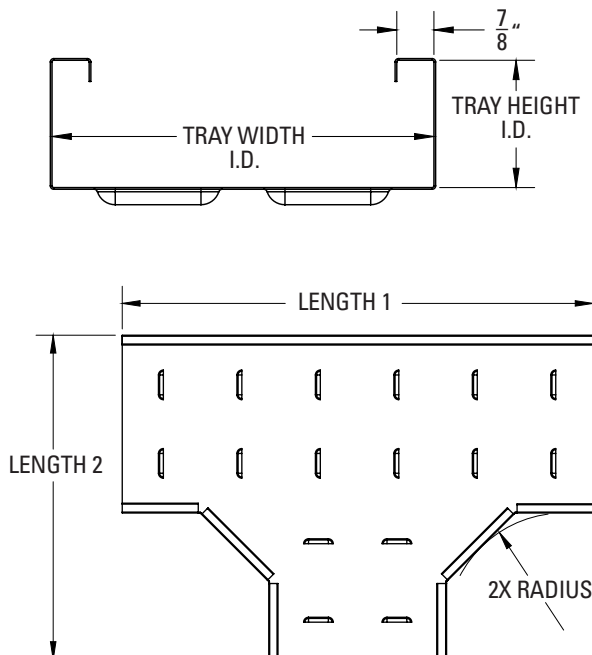

FILE: 80034

ORDERING DATA EXAMPLE:

SVXX-HT-XXXX

STYLE

V = VENTED
BOTTOM

MATERIAL

P = STEEL PRE-GALV
G = HDGAF
A = ALUMINUM
4SS = 304 STAINLESS STEEL
6SS = 316 STAINLESS STEEL

TRAY HEIGHT

3 = 3" HIGH
4 = 4" HIGH
6 = 6" HIGH

RADIUS

12 = 12" RADIUS
24 = 24" RADIUS

TRAY WIDTH

06 = 6" WIDE
09 = 9" WIDE
12 = 12" WIDE
18 = 18" WIDE
24 = 24" WIDE
36 = 36" WIDE

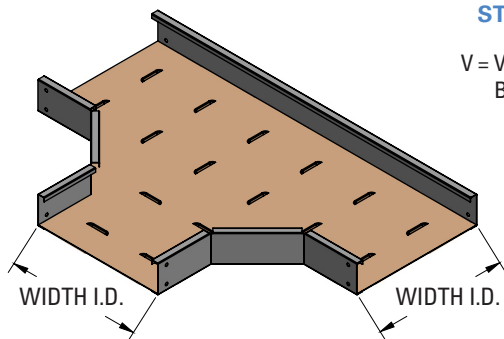

*ADDITIONAL RADIUS, SOLID BOTTOM,
AND PAINTED OPTIONS AVAILABLE
SPEAK WITH MONOSYSTEMS TO CHOOSE

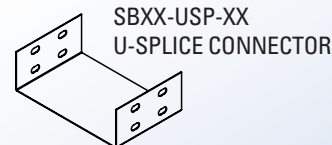

ALUMINUM P/N	ALUMINUM GAUGE	STEEL GAUGE	HEIGHT (H)	WIDTH (W)	FOR 12"R LENGTH 1	FOR 24"R LENGTH 1	FOR 12"R LENGTH 2	FOR 24"R LENGTH 2
SVXX-HT-XX06	0.063"	20	3," 4" OR 6"	6"	36"	54"	21"	30"
SVXX-HT-XX09	0.063"	20	3," 4" OR 6"	9"	39"	57"	24"	33"
SVXX-HT-XX12	0.063"	20	3," 4" OR 6"	12"	42"	60"	27"	36"
SVXX-HT-XX18	0.063"	20	3," 4" OR 6"	18"	48"	66"	33"	42"
SVXX-HT-XX24	0.063"	20	3," 4" OR 6"	24"	54"	72"	39"	48"
SVXX-HT-XX36	0.080"	18	3," 4" OR 6"	36"	66"	84"	51"	60"

4 International Drive
Rye Brook, NY 10573
Toll Free: 1 888.764.7681
Phone: 914.934.2075
Fax: 914.934.2190
MonoSystems.com



MonoSystems™
wire management. managed.

Cable Tray / TroughTray SBXX-RHT-XXXX-XX

TroughTray™ Fittings

Manufactured in the USA by MonoSystems, Inc.



REDUCING HORIZONTAL TEE

Notes

- 1.) Ordered as each.
- 2.) Two U-Splice connectors and 3/8" mounting hardware provided.
- 3.) Recommended torque: For 3/8" fasteners: 25-35 ft-lbs [33.9-47.5 N-m].
- 4.) Views for reference - do not scale.

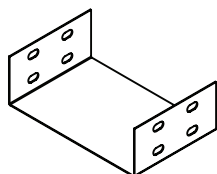
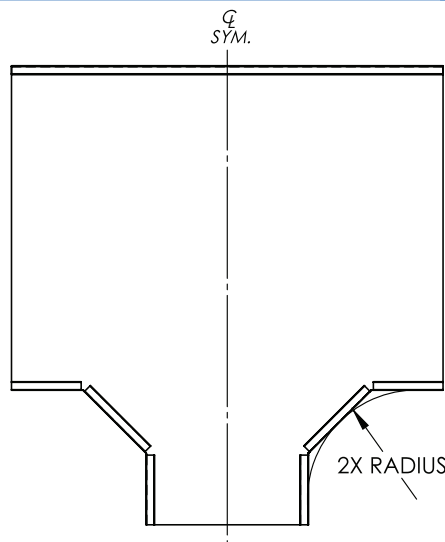
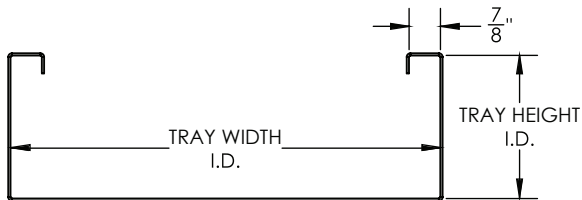

SBXX-USP-XX
U-SPLICE CONNECTOR

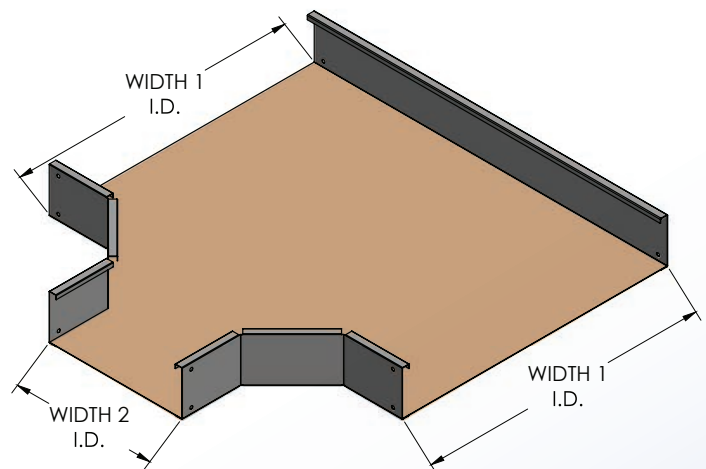

ORDERING DATA EXAMPLE:

SBXX-RHT-XXXX-XX

MATERIAL

P = STEEL
PRE-GALV
G = HDGAF
A = ALUMINUM
4SS = 304 STAINLESS STEEL
6SS = 316 STAINLESS STEEL

TRAY HEIGHT

3 = 3"
4 = 4"
6 = 6"

RADIUS

12 = 12" RADIUS
24 = 24" RADIUS

WIDTH 1

09 = 9" WIDE
12 = 12" WIDE
18 = 18" WIDE
24 = 24" WIDE
36 = 36" WIDE

WIDTH 2

06 = 6" WIDE
09 = 9" WIDE
12 = 12" WIDE
18 = 18" WIDE
24 = 24" WIDE

*ADDITIONAL RADIUS, VENTED BOTTOM,
AND PAINTED OPTIONS AVAILABLE
SPEAK WITH MONOSYSTEMS TO CHOOSE

4 International Drive
Rye Brook, NY 10573
Toll Free: 1 888.764.7681
Phone: 914.934.2075
Fax: 914.934.2190
MonoSystems.com



MonoSystems™
wire management. managed.™

Cable Tray / TroughTray SBXX-RHC-XXXX-XX

TroughTray™ Fittings

Manufactured in the USA by MonoSystems, Inc.



REDUCING HORIZONTAL CROSS

Notes

- 1.) Ordered as each.
- 2.) Three u-splice connectors and 3/8" Mounting hardware provided.
- 3.) Recommended torque: For 3/8" fasteners: 25-35 ft-lbs [33.9-47.5 N-m].
- 4.) Part is symmetric and could also be used as an "expanding" horizontal cross if rotated.
- 5.) Views for reference - do not scale.

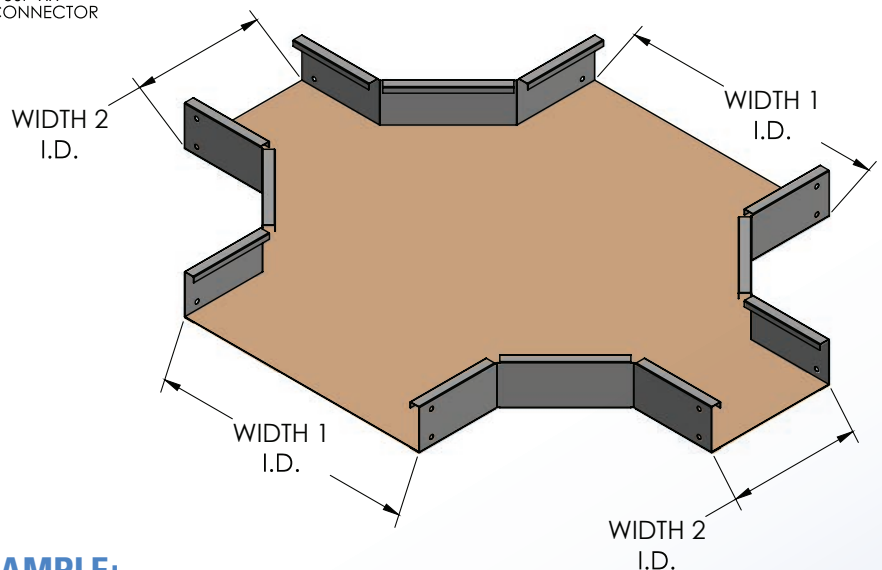
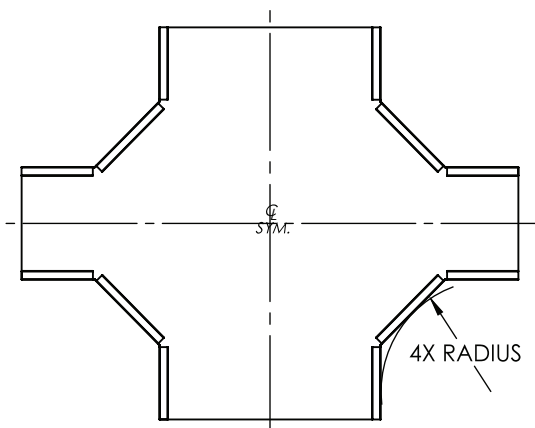
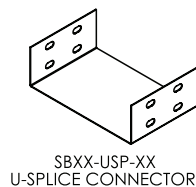

ORDERING DATA EXAMPLE:

SBXX-RHC-XXXX-XX

MATERIAL

P = STEEL
PRE-GALV
G = HDGAF
A = ALUMINUM
4SS = 304 STAINLESS STEEL
6SS = 316 STAINLESS STEEL

TRAY HEIGHT

3 = 3"
4 = 4"
6 = 6"

RADIUS

12 = 12" RADIUS
24 = 24" RADIUS

WIDTH 1

09 = 9" WIDE
12 = 12" WIDE
18 = 18" WIDE
24 = 24" WIDE
36 = 36" WIDE

WIDTH 2

06 = 6" WIDE
09 = 9" WIDE
12 = 12" WIDE
18 = 18" WIDE
24 = 24" WIDE

*ADDITIONAL RADIUS, VENTED BOTTOM,
AND PAINTED OPTIONS AVAILABLE
SPEAK WITH MONOSYSTEMS TO CHOOSE



4 International Drive
Rye Brook, NY 10573
Toll Free: 1 888.764.7681
Phone: 914.934.2075
Fax: 914.934.2190
MonoSystems.com

MonoSystems™
wire management. managed.™

Cable Tray / TroughTray SBX-COV-SR-XXXX

TroughTray™ Fittings

Manufactured in the USA by MonoSystems, Inc.



STRAIGHT REDUCER COVER

Notes

- 1.) Ordered as each. Fittings ordered separately.
- 2.) Each cover provided with #8 TEK screws for mounting.
- 3.) Views for reference - do not scale.

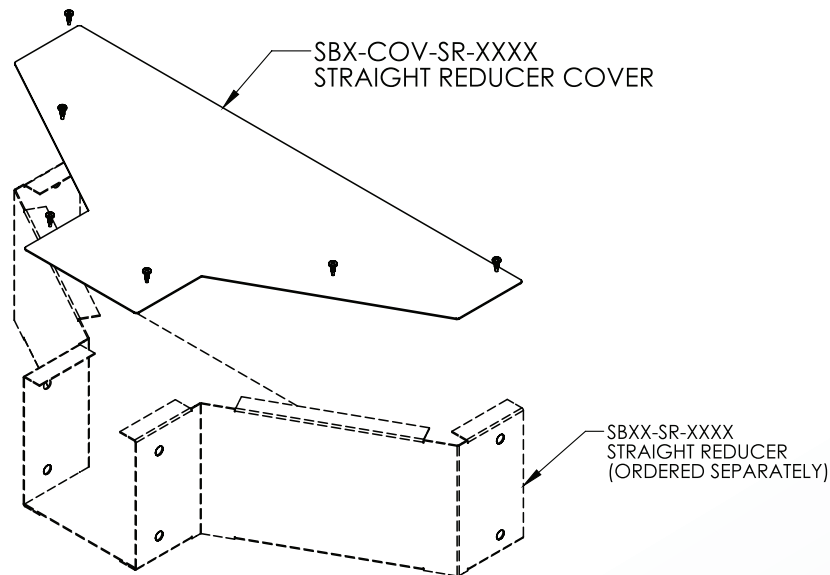
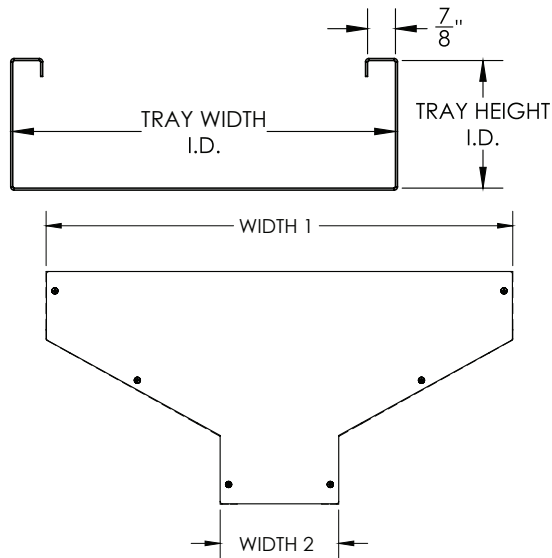

ORDERING DATA EXAMPLE:

SBX-COVX-SR-XXXX

MATERIAL

P = STEEL
PRE-GALV
G = HDGAF
A = ALUMINUM
4SS = 304 STAINLESS STEEL
6SS = 316 STAINLESS STEEL

COVER TYPE

(LEAVE BLANK) = NON-FLANGED
F = FLANGED
V = VENTED
FV = FLANGED VENTED

WIDTH 1

09 = 9" WIDE
12 = 12" WIDE
18 = 18" WIDE
24 = 24" WIDE
36 = 36" WIDE

WIDTH 2

06 = 6" WIDE
09 = 9" WIDE
12 = 12" WIDE
18 = 18" WIDE
24 = 24" WIDE

4 International Drive
Rye Brook, NY 10573
Toll Free: 1 888.764.7681
Phone: 914.934.2075
Fax: 914.934.2190
MonoSystems.com



MonoSystems™
wire management. managed.™

Cable Tray / TroughTray SBX-COVX-RHT-XXXX-XX

TroughTray™ Fittings

Manufactured in the USA by MonoSystems, Inc.



REDUCING HORIZONTAL TEE COVER

Notes

- 1.) Ordered as each. Fittings ordered separately.
- 2.) Each cover provided with #8 TEK screws for mounting.
- 3.) Views for reference - do not scale.

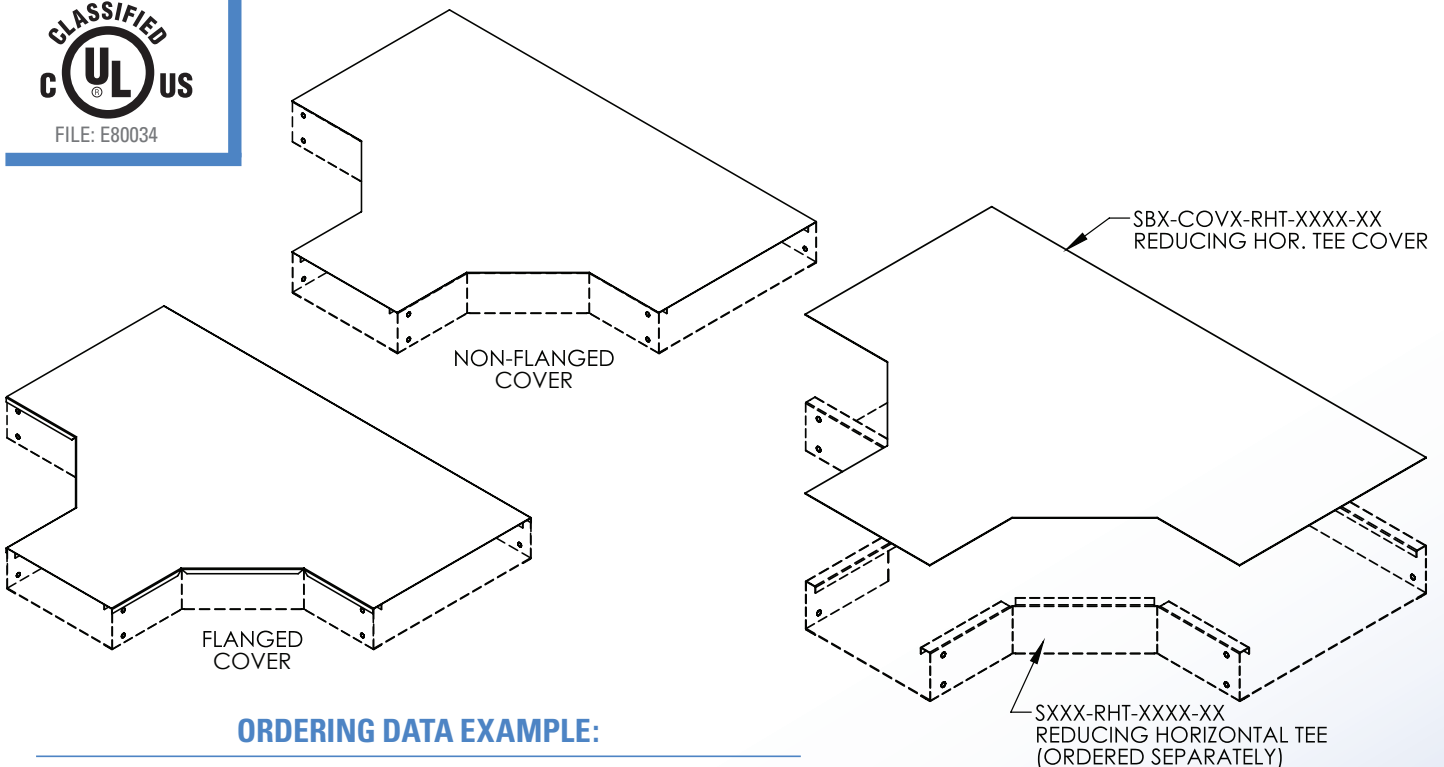
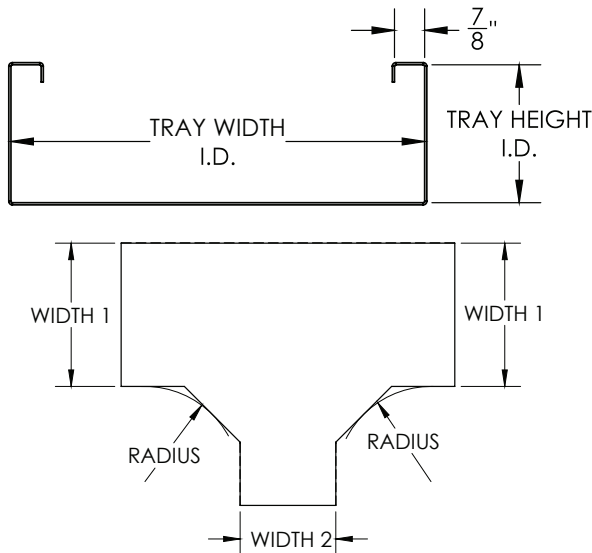

ORDERING DATA EXAMPLE:

SBX-COVX-RHT-XX XX-XX

MATERIAL

P = STEEL
PRE-GALV
G = HDGAF
A = ALUMINUM
4SS = 304 STAINLESS STEEL
6SS = 316 STAINLESS STEEL

COVER TYPE

(LEAVE BLANK) = NON-FLANGED
F = FLANGED
V = VENTED
FV = FLANGED VENTED

RADIUS

12 = 12" RADIUS
24 = 24" RADIUS

WIDTH 1

09 = 9" WIDE
12 = 12" WIDE
18 = 18" WIDE
24 = 24" WIDE
36 = 36" WIDE

WIDTH 2

06 = 6" WIDE
09 = 9" WIDE
12 = 12" WIDE
18 = 18" WIDE
24 = 24" WIDE



4 International Drive
Rye Brook, NY 10573
Toll Free: 1 888.764.7681
Phone: 914.934.2075
Fax: 914.934.2190
MonoSystems.com

MonoSystems™
wire management. managed.™

Cable Tray / TroughTray SBX-COVX-RHC-XXXX-XX

TroughTray™ Fittings

Manufactured in the USA by MonoSystems, Inc.



REDUCING HORIZONTAL CROSS COVER

Notes

- 1.) Ordered as each. Fittings ordered separately.
- 2.) Each cover provided with #8 TEK screws for mounting.
- 3.) Part is symmetric and could also be used as an "expanding" horizontal cross if rotated.
- 4.) Views for reference - do not scale.

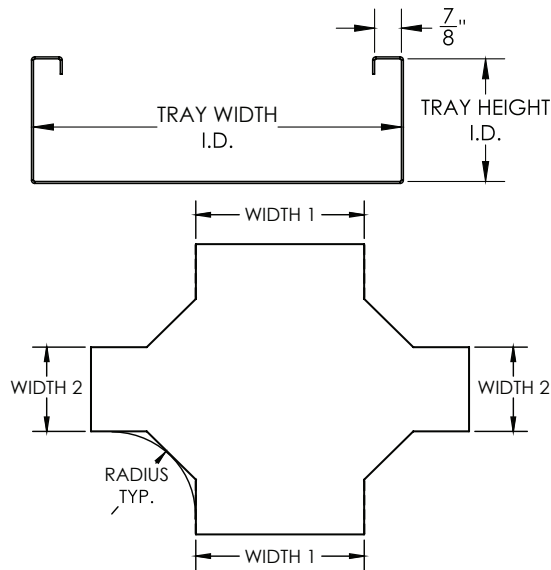

SBX-COVX-RHC-XXXX-XX
REDUCING HORIZONTAL
CROSS COVER

XXXX-RHC-XXXX-XX
REDUCING HORIZONTAL CROSS
(ORDERED SEPARATELY)

NON-FLANGED
COVER

FLANGED
COVER

ORDERING DATA EXAMPLE:

SBX-COVX-RHC-XX XX-XX

MATERIAL

P = STEEL
PRE-GALV
G = HDGAF
A = ALUMINUM
4SS = 304 STAINLESS STEEL
6SS = 316 STAINLESS STEEL

COVER TYPE

(LEAVE BLANK) = NON-FLANGED
F = FLANGED
V = VENTED
FV = FLANGED VENTED

RADIUS

12 = 12" RADIUS
24 = 24" RADIUS

WIDTH 1

09 = 9" WIDE
12 = 12" WIDE
18 = 18" WIDE
24 = 24" WIDE
36 = 36" WIDE

WIDTH 2

06 = 6" WIDE
09 = 9" WIDE
12 = 12" WIDE
18 = 18" WIDE
24 = 24" WIDE



4 International Drive
Rye Brook, NY 10573
Toll Free: 1 888.764.7681
Phone: 914.934.2075
Fax: 914.934.2190
MonoSystems.com

MonoSystems™
wire management. managed.™

Cable Tray / Trough Tray SBX-DO-XX

TroughTray™ Accessories

Manufactured by MonoSystems, Inc.

END OF TRAY DROP OUT

Notes:

- 1.) Use to exit cables at end of trough run.
- 2.) Includes Ø 1/4" tray mounting hardware.
- 3.) Installation instructions: align drop out at end of tray.
Mark hole locations in tray using drop out as a template.
Remove and field drill Ø 5/16" holes. Install dropout to tray using supplied 1/4-20 hardware as shown.
- 4.) Views for reference - do not scale.

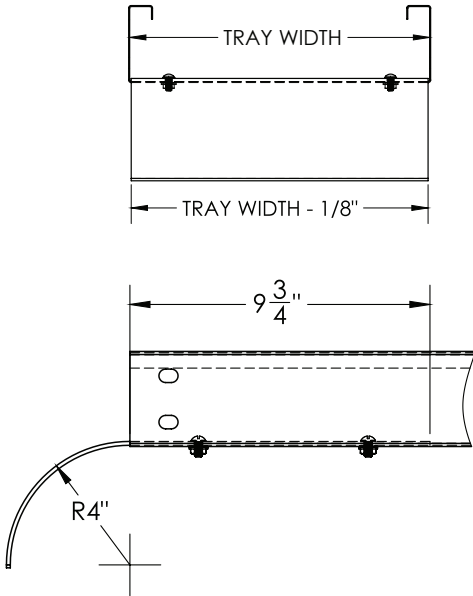

ORDERING DATA EXAMPLE:

SBX-DO-XX

MATERIAL

P = STEEL PRE-GALV
G = HDGAF
A = ALUMINUM
SS = 304 STAINLESS STEEL

TRAY HEIGHT

06 = 6"
09 = 9"
12 = 12"
18 = 18"
24 = 24"
36 = 36"

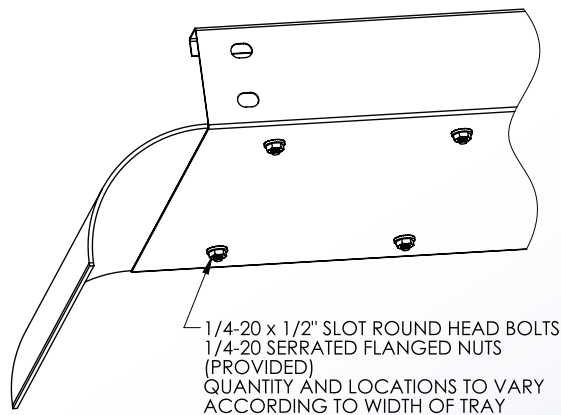
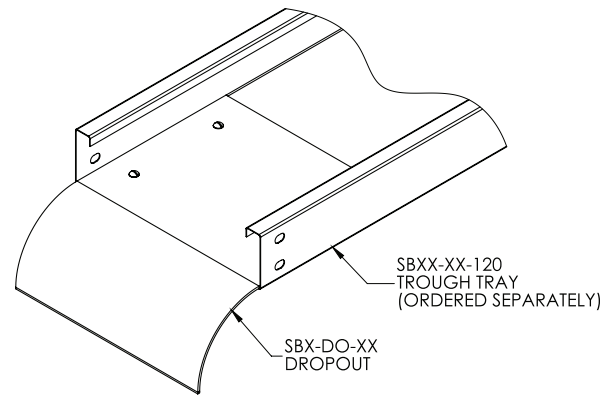

4 International Drive
Rye Brook, NY 10573
Toll Free: 1 888.764.7681
Phone: 914.934.2075
Fax: 914.934.2190
MonoSystems.com



Cable Tray / Trough Tray SBXX-2010-PR

TroughTray™ Accessories

Manufactured by MonoSystems, Inc.

VERTICAL PIVOT CONNECTORS FOR TROUGH TRAY

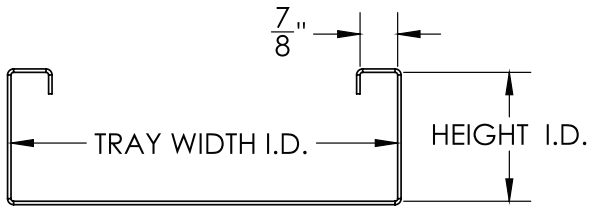

Notes:

- 1.) Ordered as pairs. Includes 3/8" mounting hardware.
- 2.) Installation instructions: align vertical pivot connector to outside siderail, mark and drill outer 3/8" clearance holes. Install vertical pivot connectors inside tray using supplied 3/8" hardware as shown.
- 3.) Recommended torque for 3/8" fasteners: 35 ft-lbs [47.5 N-m].
- 4.) Views for reference - do not scale.

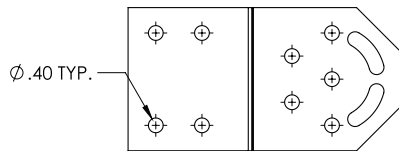

ORDERING DATA EXAMPLE:

SBXX-2010-PR

MATERIAL

P = STEEL PRE-GALV
G = HDGAF
A = ALUMINUM
SS = 304 STAINLESS STEEL

TRAY HEIGHT

3 = 3"
4 = 4"
6 = 6"

EACH SBXX-2010-PR INCLUDES:

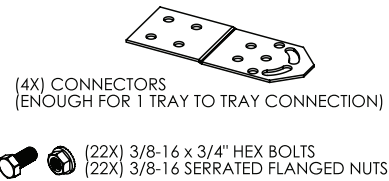

TRAY MUST BE SUPPORTED WITHIN
12" OF EACH SIDE OF PIVOT
(SUPPORTS BY OTHERS)

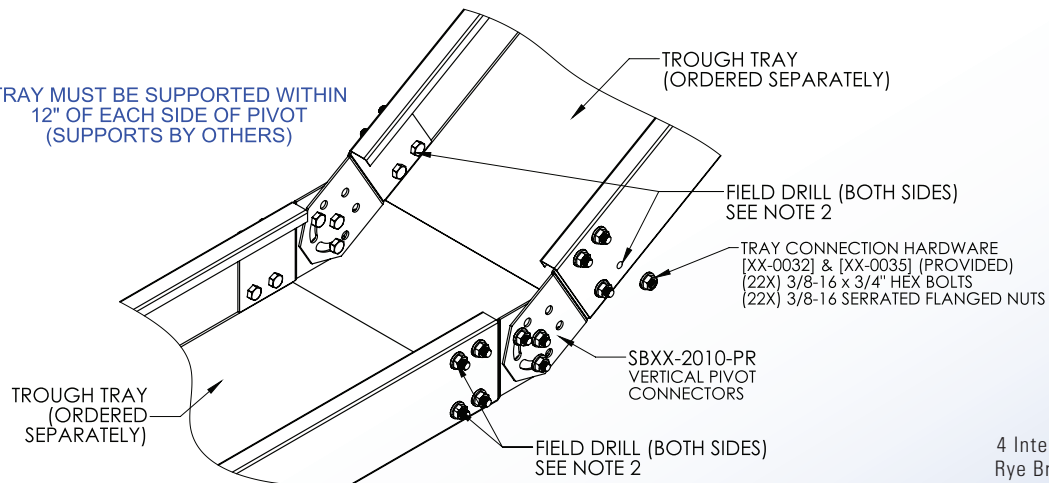

4 International Drive
Rye Brook, NY 10573
Toll Free: 1 888.764.7681
Phone: 914.934.2075
Fax: 914.934.2190
MonoSystems.com



Cable Tray / Trough Tray SBXX-2011-PR

TroughTray™ Accessories

Manufactured by MonoSystems, Inc.

HORIZONTAL PIVOT CONNECTORS FOR TROUGH TRAY

Notes:

- 1.) Ordered as pairs. Includes two pivot connectors with 3/8-16 pivot and 3/8-16 tray mounting hardware (enough for one tray to tray connection).
- 2.) Used to accommodate changes in horizontal direction up to 6°. Mounting slots allow for movement when positioning desired angle.
- 3.) Installation instructions: align horizontal pivot connector to mounting locations at end of tray. Install horizontal pivot connectors inside tray using supplied 3/8-16 hardware as shown.
- 4.) Recommended torque for 3/8" fasteners: 35 ft-lbs [47.5 N-m].
- 5.) Views for reference - do not scale.

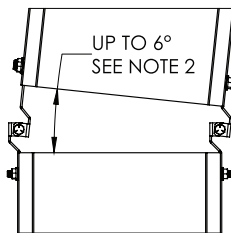
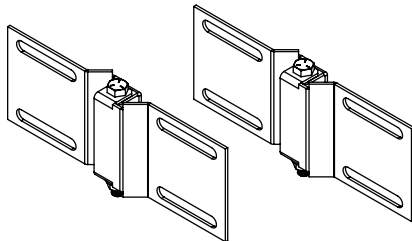
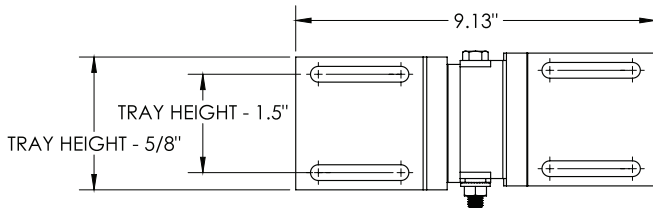

SBXX-2011-PR
HORIZONTAL PIVOT
CONNECTORS

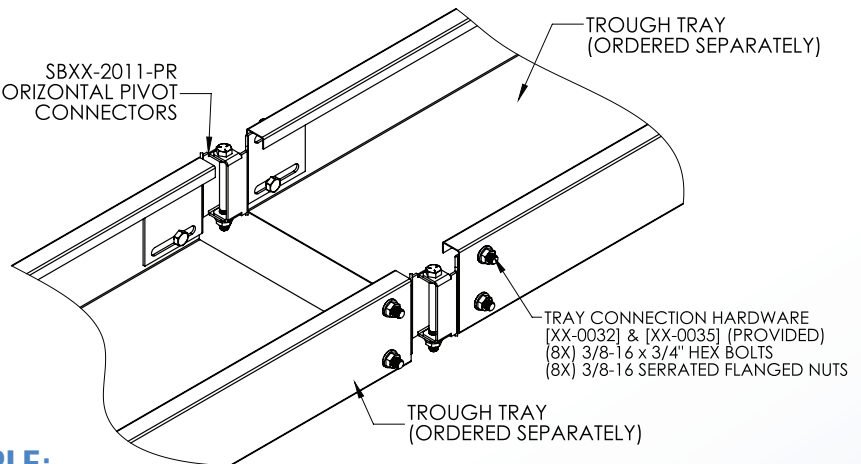

ORDERING DATA EXAMPLE:

SBXX-2011-PR

MATERIAL

P = STEEL PRE-GALV
G = HDGAF
A = ALUMINUM
SS = 304 STAINLESS STEEL

TRAY HEIGHT

3 = 3"
4 = 4"
6 = 6"

4 International Drive
Rye Brook, NY 10573
Toll Free: 1 888.764.7681
Phone: 914.934.2075
Fax: 914.934.2190
MonoSystems.com



Cable Tray / Trough Tray SBXX-BE-XX

TroughTray™ Accessories

Manufactured in the USA by MonoSystems, Inc.



BLIND END

Notes

- 1.) Ordered as each. Use to terminate run of tray.
- 2.) 3/8" Mounting hardware provided.
- 3.) Recommended torque: For 3/8" fasteners: 25-35 ft-lbs [33.9-47.5 N-m].
- 4.) Views for reference - do not scale.

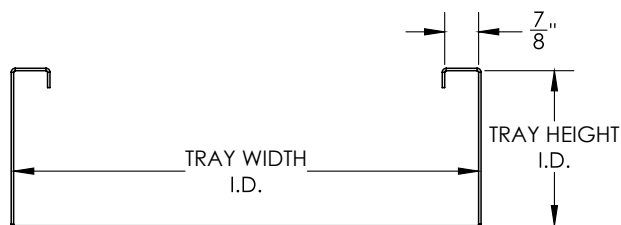

FILE: E80034
VOL.3

ORDERING DATA EXAMPLE:

SBXX-BE-XX

MATERIAL	TRAY HEIGHT	TRAY WIDTH
----------	-------------	------------

P = STEEL	3 = 3" HIGH	06 = 6" WIDE
PRE-GALV	4 = 4" HIGH	09 = 9" WIDE
G = HDGAF	6 = 6" HIGH	12 = 12" WIDE
A = ALUMINUM		18 = 18" WIDE
4SS = 304 STAINLESS STEEL		24 = 24" WIDE
6SS = 316 STAINLESS STEEL		36 = 36" WIDE

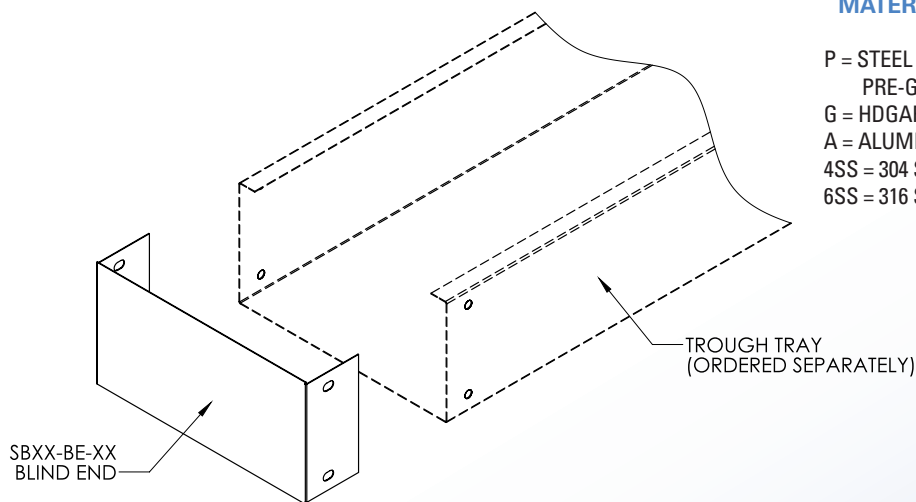

4 International Drive
Rye Brook, NY 10573
Toll Free: 1 888.764.7681
Phone: 914.934.2075
Fax: 914.934.2190
MonoSystems.com



MonoSystems™
wire management. managed.™

Cable Tray / Trough Tray SBX-COVX-XX-XXX

TroughTray™ Accessories

Manufactured by MonoSystems, Inc.

COVER

Notes:

- 1.) Standard cover length: 120" [10ft].
- 2.) Each cover provided with (10) #8 self drilling tek screws for mounting. Recommended attachment locations: 3/8" from edges width wise & 1" from end length wise, followed by 29-1/2" O.C.
- 3.) Views for reference - do not scale.

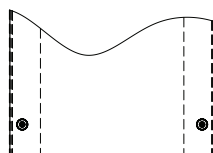
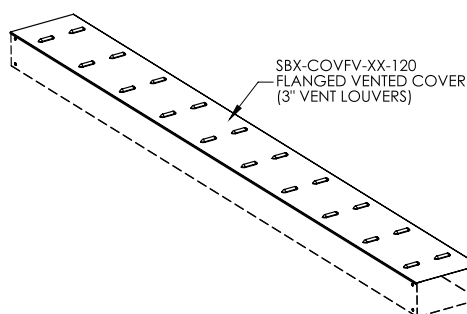
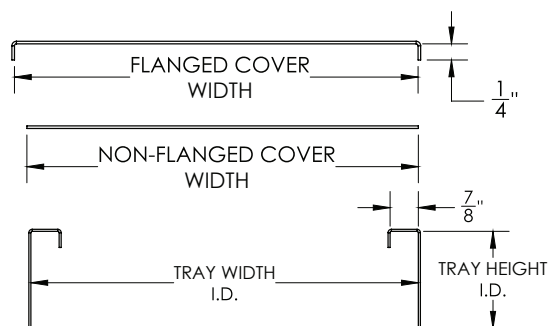

ORDERING DATA EXAMPLE:

SBX-COVX-XX-120

MATERIAL

P = STEEL
PRE-GALV
G = HDGAF
A = ALUMINUM
4SS = 304 STAINLESS STEEL
6SS = 316 STAINLESS STEEL

COVER TYPE

LEAVE BLANK) = NON-FLANGED
F = FLANGED
V = VENTED
FV = FLANGED VENTED

LENGTH

120 = 10' LONG

TRAY WIDTH

06 = FOR 6" WIDE
09 = FOR 9" WIDE
12 = FOR 12" WIDE
18 = FOR 18" WIDE
24 = FOR 24" WIDE
30 = FOR 30" WIDE
36 = FOR 36" WIDE

TEK SCREWS
(PROVIDED)

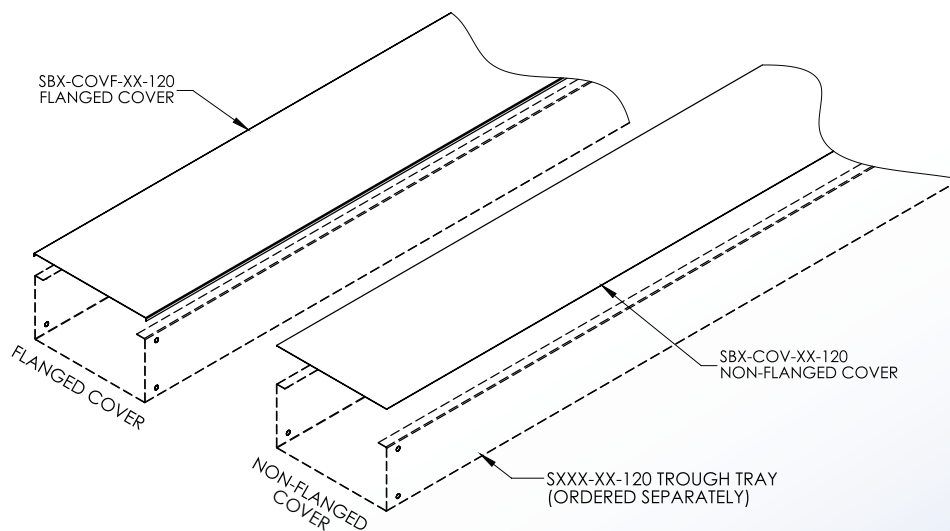

4 International Drive
Rye Brook, NY 10573
Toll Free: 1 888.764.7681
Phone: 914.934.2075
Fax: 914.934.2190
MonoSystems.com



Cable Tray / Trough Tray SBXX-DIV-120

TroughTray™ Accessories
Manufactured by MonoSystems, Inc.

STRAIGHT DIVIDER

Notes:

- 1.) Ordered as each. Use to create multiple compartments in TroughTray.
- 2.) Install using rivets, tek screws, or machine screws. Attachment hardware by others.
- 3.) For horizontal bend divider see P/N: SBXX-2058
- 4.) Views for reference - do not scale.

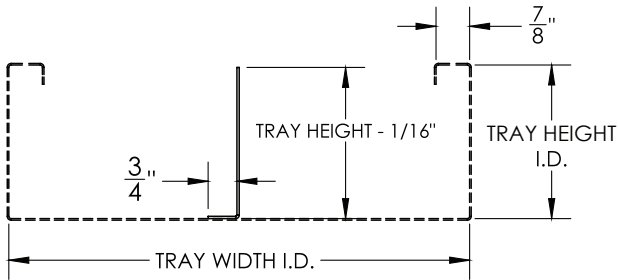

ORDERING DATA EXAMPLE:

SBXX-DIV-120

MATERIAL

P = STEEL
PRE-GALV
G = HDGAF
A = ALUMINUM
4SS = 304 STAINLESS STEEL
6SS = 316 STAINLESS STEEL

TRAY HEIGHT

3 = 3"
4 = 4"
6 = 6"

DIVIDER LENGTH

120" (10ft)

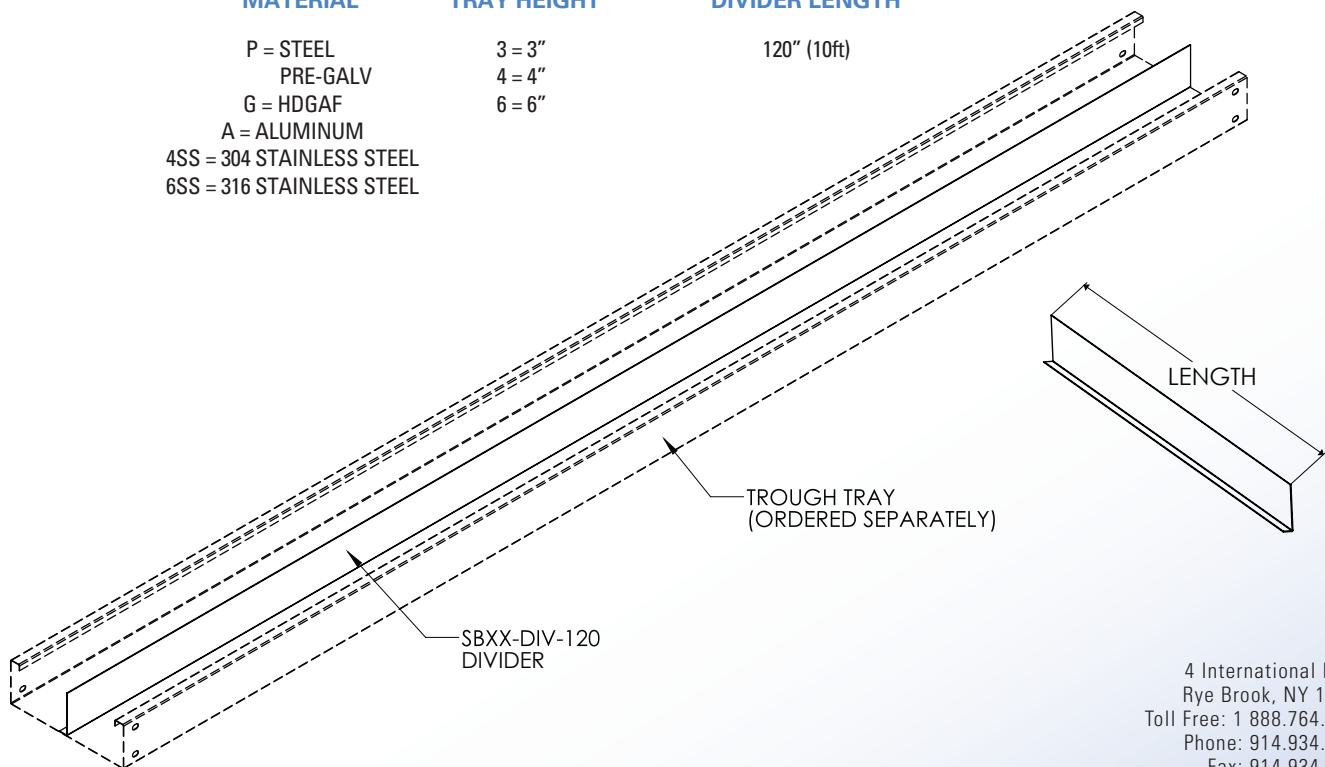

4 International Drive
Rye Brook, NY 10573
Toll Free: 1 888.764.7681
Phone: 914.934.2075
Fax: 914.934.2190
MonoSystems.com



Cable Tray / Trough Tray SB-GSK

TroughTray™ Accessories

Manufactured in the USA by MonoSystems, Inc.



FOAM GASKET

Notes

- 1.) 1/16" X 3/4" foam gasket, color: black.
- 2.) To install: remove adhesive backing and stick to clean surface.
- 3.) Views for reference - do not scale.

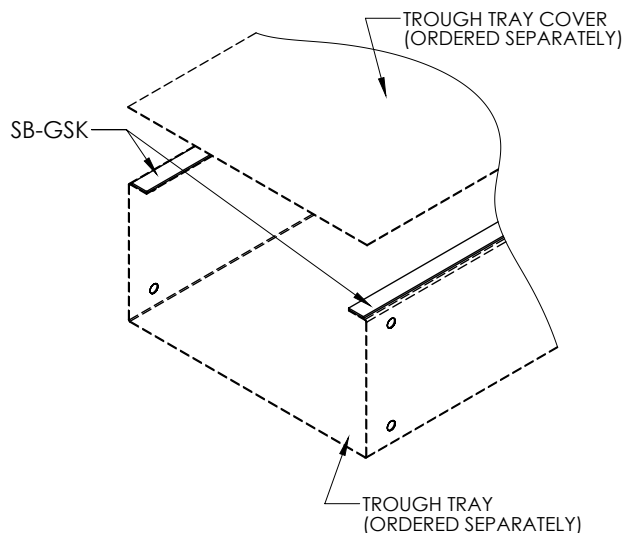

FILE: E80034
VOL.3

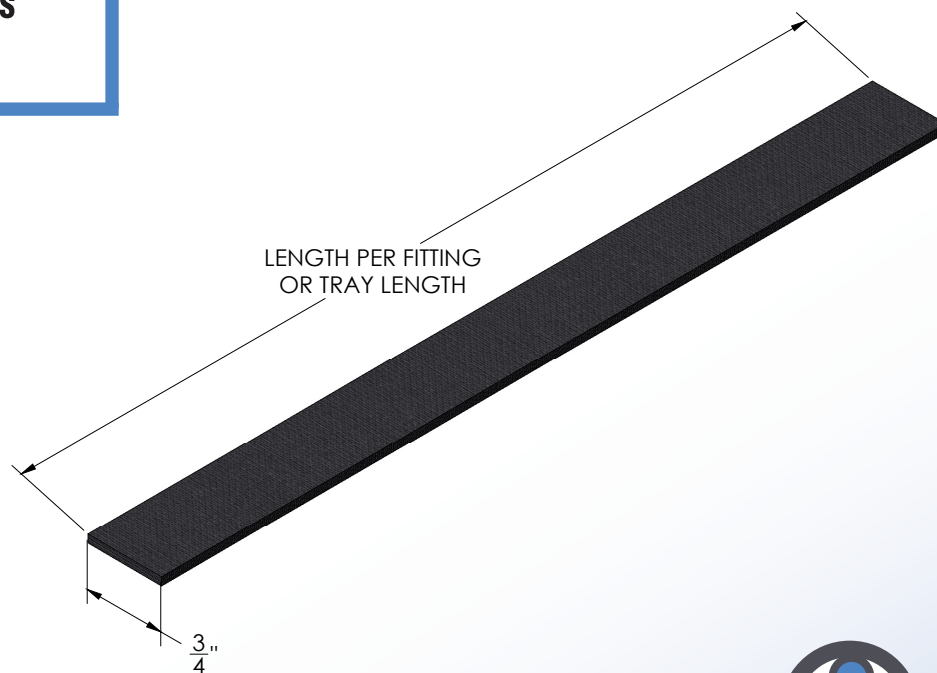

4 International Drive
Rye Brook, NY 10573
Toll Free: 1 888.764.7681
Phone: 914.934.2075
Fax: 914.934.2190
MonoSystems.com



MonoSystems™
wire management. managed.™

Cable Tray / Trough Tray SBXX-TBC-XX

TroughTray™ Accessories

Manufactured in the USA by MonoSystems, Inc.



TRAY TO BOX CONNECTOR

Notes

- 1.) Designed to attach the end of a Trough Tray cable tray run to a distribution cabinet or control center to help reinforce the box at the point of entry.
- 2.) Packaged with hardware for connection to cable tray.

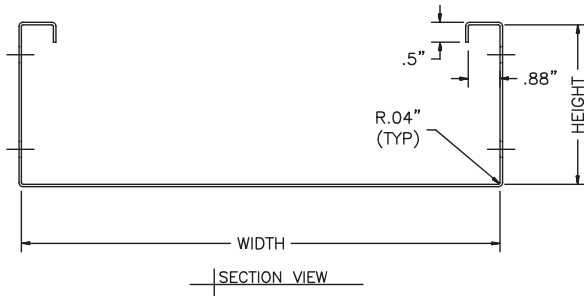

FILE: E80034
VOL.3

ORDERING DATA EXAMPLE:

SBXX-TBC-XX

MATERIAL

P = PRE-GALV
STEEL
G = HDGAF
A = ALUMINUM
SS = 304 STAINLESS STEEL

HEIGHT

03 = 3" HIGH
04 = 4" HIGH
06 = 6" HIGH

WIDTH

06 = 6" WIDE
09 = 9" WIDE
12 = 12" WIDE
18 = 18" WIDE
24 = 24" WIDE
36 = 36" WIDE

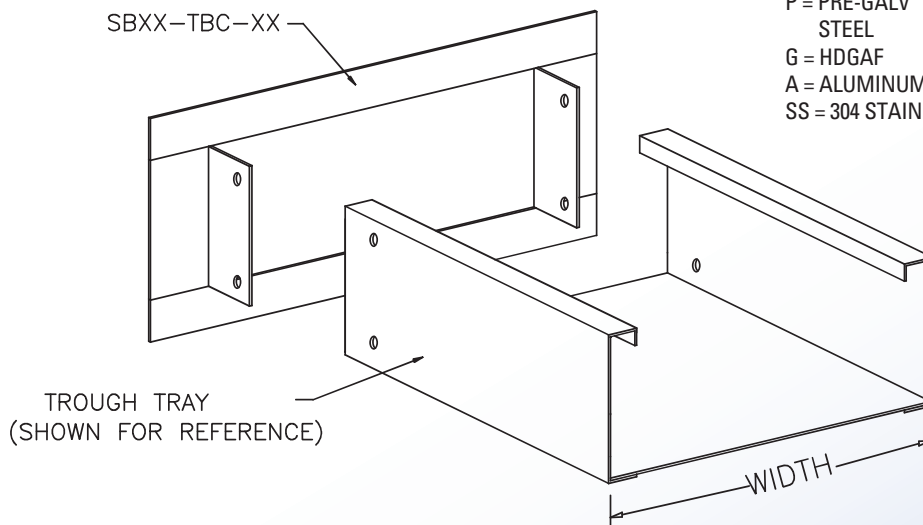

4 International Drive
Rye Brook, NY 10573
Toll Free: 1 888.764.7681
Phone: 914.934.2075
Fax: 914.934.2190
MonoSystems.com



MonoSystems™
wire management. managed.™

Cable Tray / Trough Tray SBXX-USP-XX

TroughTray™ Accessories

Manufactured in the USA by MonoSystems, Inc.



U-SPLICE PLATE

Notes

- 1.) Ordered as each. Use to junction tray sections together.
- 2.) 3/8" Mounting hardware provided.
- 3.) Recommended torque: for 3/8" fasteners: 25-35 ft-lbs [33.9-47.5 N-m].
- 4.) Views for reference - do not scale.

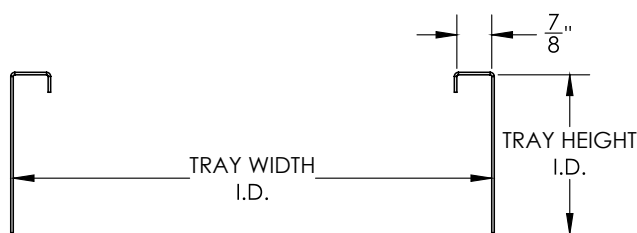
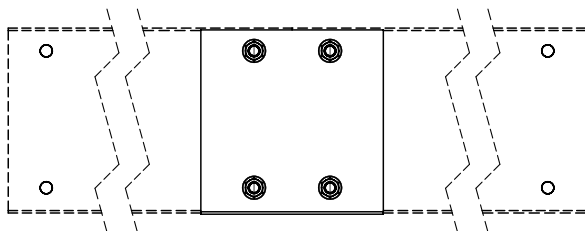

FILE: E80034
VOL.3

ORDERING DATA EXAMPLE:

SBXX-USP-XX

MATERIAL

P = STEEL
PRE-GALV
G = HDGAF
A = ALUMINUM
4SS = 304 STAINLESS STEEL
6SS = 316 STAINLESS STEEL

TRAY HEIGHT

3 = 3" HIGH
4 = 4" HIGH
6 = 6" HIGH

TRAY WIDTH

06 = 6" WIDE
09 = 9" WIDE
12 = 12" WIDE
18 = 18" WIDE
24 = 24" WIDE
36 = 36" WIDE

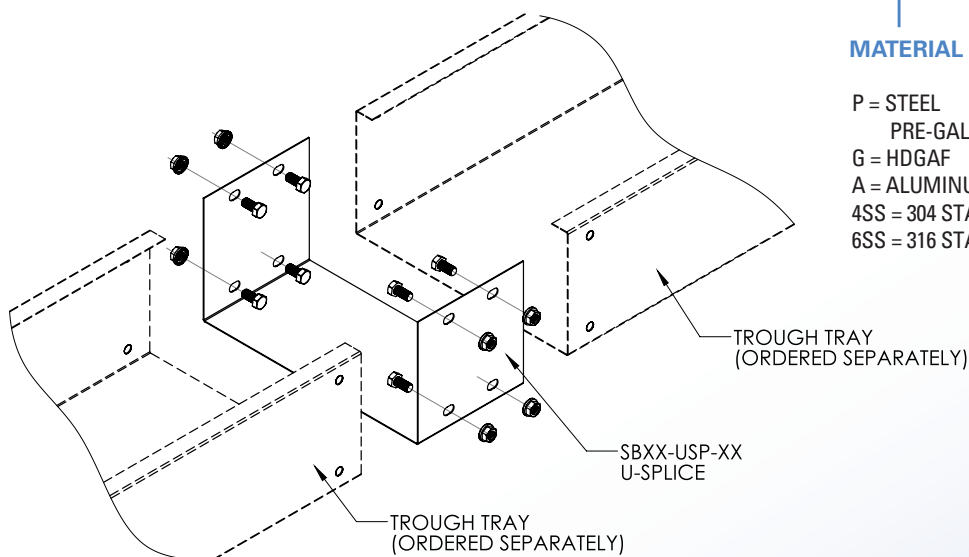

4 International Drive
Rye Brook, NY 10573
Toll Free: 1 888.764.7681
Phone: 914.934.2075
Fax: 914.934.2190
MonoSystems.com



MonoSystems™
wire management. managed.

Cable Tray / Trough Tray SBXX-XX-WPS

TroughTray™ Accessories

Manufactured in the USA by MonoSystems, Inc.



WALL PENETRATION SLEEVE

Notes

- 1.) Sold as each.
Includes: (1) 20" long trough tray base and cover section, cover tek screws and (2) trim plates.
- 2.) Splice connection plates and mounting hardware ordered separately.
- 3.) Views for reference - do not scale.

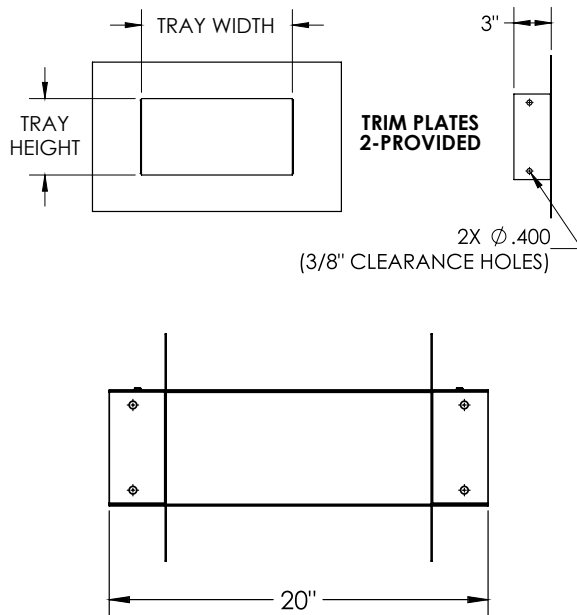

ORDERING DATA EXAMPLE:

SBXX-XX-WPS

MATERIAL TRAY HEIGHT TRAY WIDTH

P = STEEL	3 = 3" HIGH	06 = 6" WIDE
PRE-GALV	4 = 4" HIGH	09 = 9" WIDE
G = HDGAF	6 = 6" HIGH	12 = 12" WIDE
A = ALUMINUM		18 = 18" WIDE
4SS = 304 STAINLESS STEEL		24 = 24" WIDE
6SS = 316 STAINLESS STEEL		36 = 36" WIDE

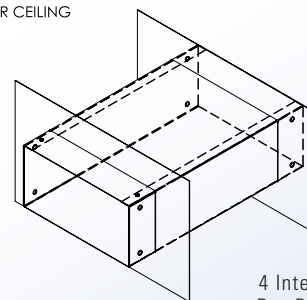
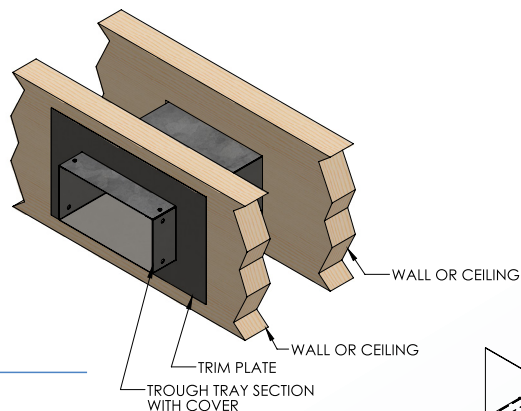

*ADDITIONAL PAINTED
OPTIONS AVAILABLE
SPEAK WITH MONOSYSTEMS
TO CHOOSE

4 International Drive
Rye Brook, NY 10573
Toll Free: 1 888.764.7681
Phone: 914.934.2075
Fax: 914.934.2190
MonoSystems.com



MonoSystems™
wire management. managed.™

Cable Tray / Trough Tray SBXX-SP

TroughTray™ Accessories

Manufactured in the USA by MonoSystems, Inc.



FLAT SPLICE PLATE

Notes

- 1.) Ordered as a pair. Use to junction tray sections together.
- 2.) Flat splice plates can be used to connect trough tray fittings where a u-splice cannot be used. Flat splice plates can be mounted on the outside or inside of the adjoining tray sections.
- 3.) 3/8" mounting hardware provided.
- 4.) Recommended torque: for 3/8" fasteners: 25-35 ft-lbs [33.9-47.5 n-m].
- 5.) Views for reference - do not scale.

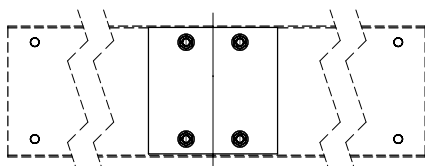

SHOWN MOUNTED ON OUTSIDE

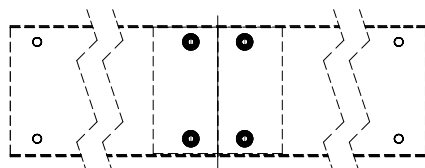

SHOWN MOUNTED ON INSIDE

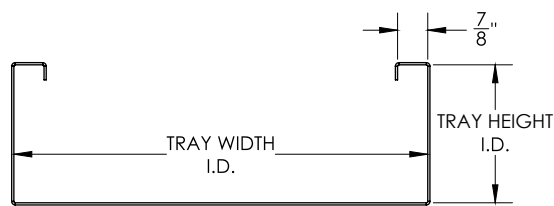

ORDERING DATA EXAMPLE:

SBXX-SP

MATERIAL

P = STEEL PRE-GALV
G = HOT DIPPED GALV.
A = ALUMINUM
4SS = 304 STAINLESS STEEL
6SS = 316 STAINLESS STEEL

HEIGHT

3 = 3" HIGH
4 = 4" HIGH
6 = 6" HIGH

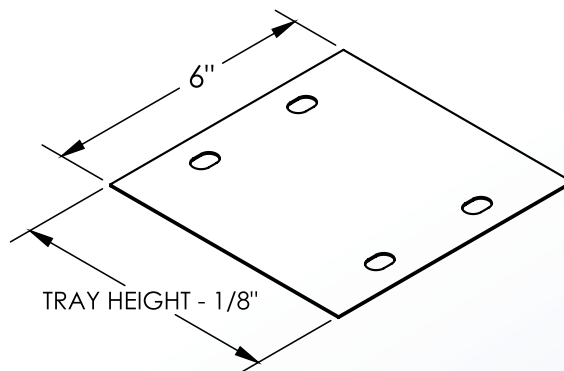

4 International Drive
Rye Brook, NY 10573
Toll Free: 1 888.764.7681
Phone: 914.934.2075
Fax: 914.934.2190
MonoSystems.com



MonoSystems™
wire management. managed.™

Cable Tray / TroughTray SUP-XT-FLR-XXHXXW

TroughTray™ Accessories

Manufactured in the USA by MonoSystems, Inc.



MULTI-TIER ADJUSTABLE CABLE TRAY FLOOR SUPPORT

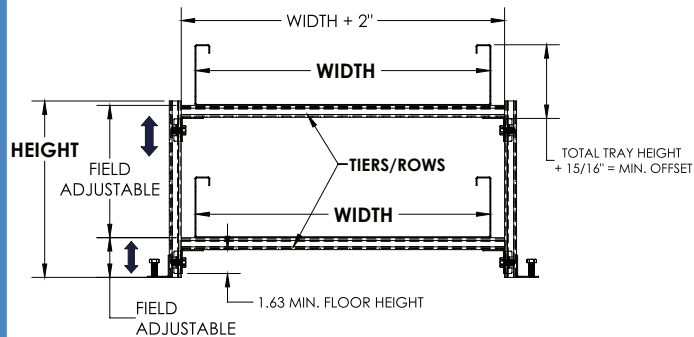

Notes

- 1.) Each support provided as (2x) vertical support posts to specified height and (1 - 4) horizontal shelf brackets provided to specified width. Shelf bracket to vertical support post hardware provided.
- 2.) Mount assembly to floor using 3/8" hardware (by others).
- 3.) Multi-tier system is universal and also suitable for power tray, mono rack, or trough tray products.
- 4.) Views for reference - do not scale.

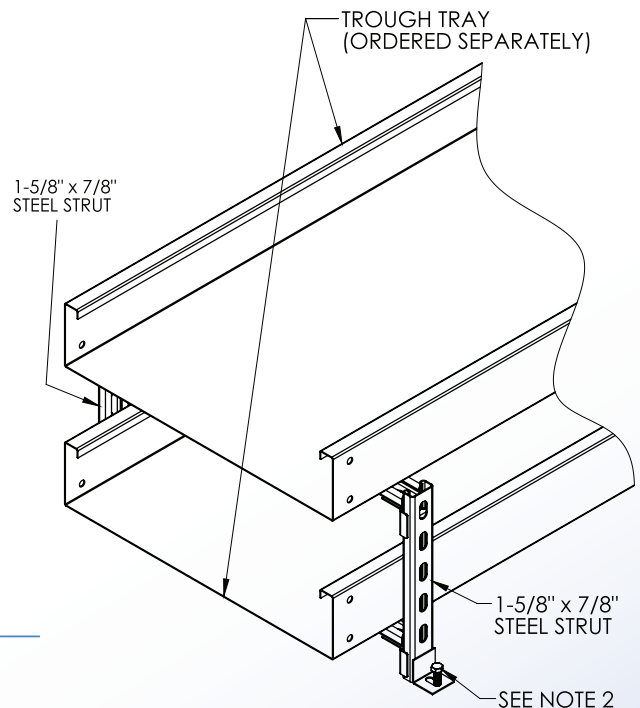
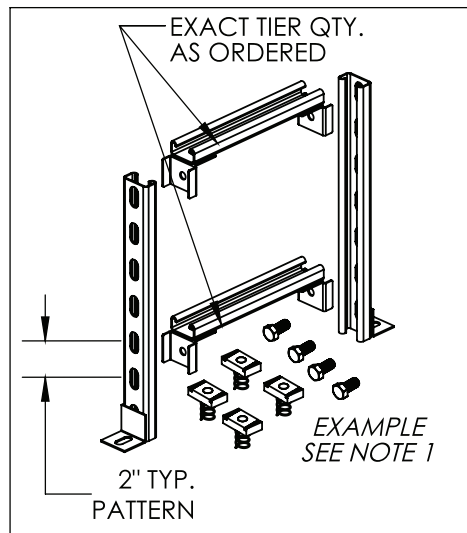
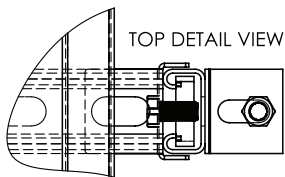

ORDERING DATA EXAMPLE:

SUP-**X**T-FLR-**XX**H**XX**W

TIERS/ROWS

- 1 = 1 TIER
- 2 = 2 TIER
- 3 = 3 TIER
- 4 = 4 TIER

HEIGHT AS REQUIRED

WIDTH

- 6 = 6"
- 9 = 9"
- 12 = 12"
- 18 = 18"
- 24 = 24"
- 36 = 36"

4 International Drive
Rye Brook, NY 10573
Toll Free: 1 888.764.7681
Phone: 914.934.2075
Fax: 914.934.2190
MonoSystems.com



MonoSystems™
wire management. managed.™

Cable Tray / Trough Tray CS-SBXX-2094-XX

TroughTray™ Accessories
Manufactured in the USA by MonoSystems, Inc.



WRAP AROUND COVER CLAMP

Notes

- 1.) Ordered as 1-clamp use to hold trough tray cover in place.
- 2.) 3/8" Mounting hardware provided.
- 3.) **To install:** Place 1 part of cover clamp around trough tray cover and tray assembly. Place 2nd part around opposite end of trough tray, align clamp holes and install hardware.
- 4.) Recommended torque: For 3/8" fasteners: 25-35 ft-lbs [33.9-47.5 N-m].
- 4.) Views for reference - Do not scale.

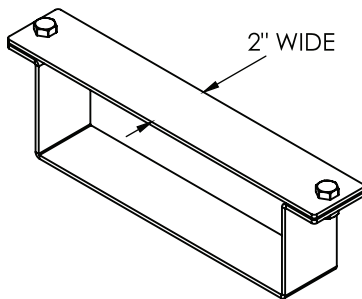
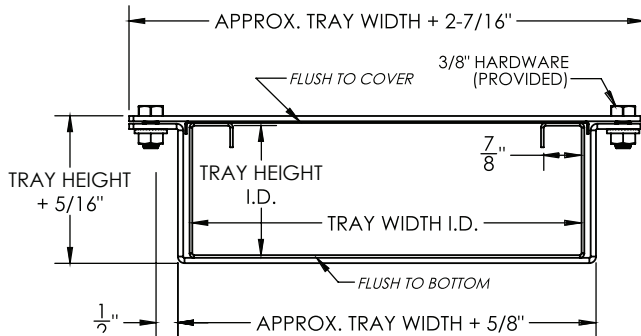

FIE: E80034

ORDERING DATA EXAMPLE:

SB-XX-2094-XX

MATERIAL

P = STEEL
PRE-GALV
G = HDGAF
A = ALUMINUM
4SS = 304 STAINLESS STEEL
6SS = 316 STAINLESS STEEL

TRAY HEIGHT

3 = 3"
4 = 4"
6 = 6"

TRAY WIDTH

06 = 6" WIDE
09 = 9" WIDE
12 = 12" WIDE
18 = 18" WIDE
24 = 24" WIDE
36 = 36" WIDE

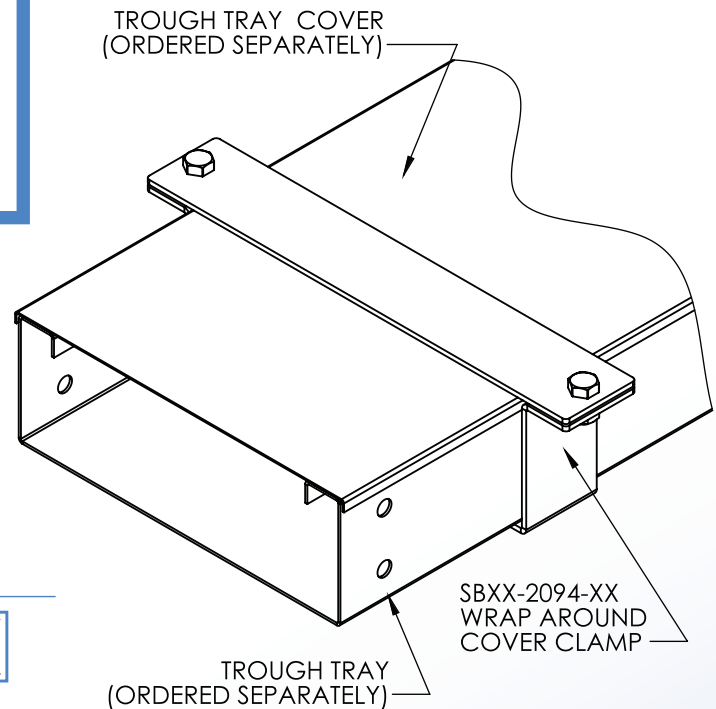

4 International Drive
Rye Brook, NY 10573
Toll Free: 1 888.764.7681
Phone: 914.934.2075
Fax: 914.934.2190
MonoSystems.com



MonoSystems™
Expect. Direct.

Cable Tray

X0-B494-XX

PowerTray™ Accessories

Manufactured in the USA by MonoSystems, Inc.



SINGLE BRACED STRUT BRACKET

Notes

- 1.) Attach strut bracket using 1/2" hardware (by others).
- 2.) Material: 3/8" steel.
- 3.) Views for reference - do not scale.

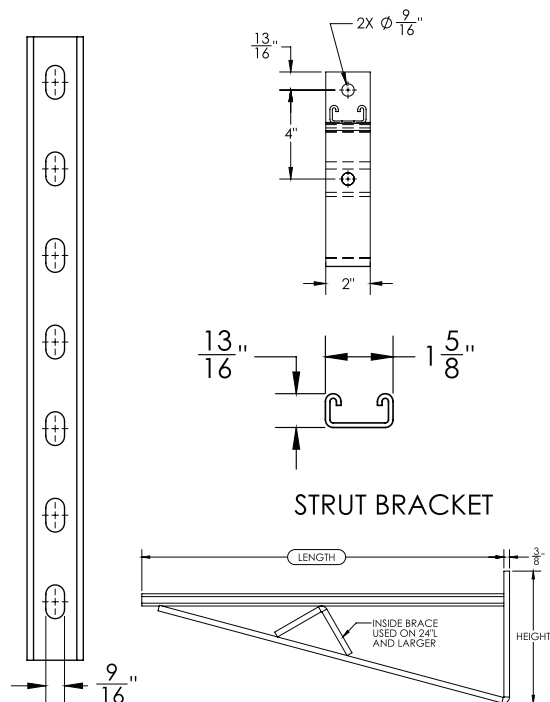

ORDERING DATA EXAMPLE:

X0-B494-XX

MATERIAL

G = HOT DIPPED
GALVANIZED STEEL
Z = ZINC PLATED
GALVANIZED STEEL

LENGTH

12 = 12" L
18 = 18" L
24 = 24" L
27 = 27" L
36 = 36" L
42 = 42" L

LENGTH	HEIGHT	UNIFORM LOAD
12"	8-3/4"	1580lbs [7.02kN]
18"	8-3/4"	1000lbs [4.45kN]
24"	8-3/4"	996lbs [4.43kN]
27"	9-1/2"	981lbs [4.36kN]
36"	11-1/4"	864lbs [3.84kN]
42"	16"	580lbs [2.58kN]

4 International Drive
Rye Brook, NY 10573
Toll Free: 1 888.764.7681
Phone: 914.934.2075
Fax: 914.934.2190
MonoSystems.com



MonoSystems
wire management. managed.

Cable Tray XX-B297-XX

PowerTray™ Accessories

Manufactured in the USA by MonoSystems, Inc.



CANTILEVER BRACKET, DOUBLE CHANNEL

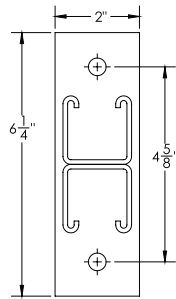
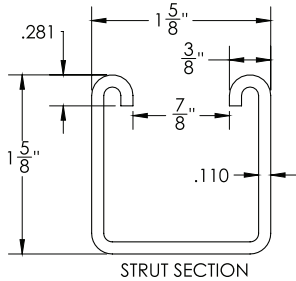

Notes

- 1.) Attach strut bracket using 3/8" hardware (by others).
- 2.) Bracket material: 3/8" thick x 2" steel. Strut material: 12ga. steel.
- 3.) Views for reference - do not scale.



ORDERING DATA EXAMPLE:

CS-X0-B297-XX

MATERIAL

G = HOT DIPPED
GALVANIZED STEEL
Z = ZINC PLATED
GALVANIZED STEEL

LENGTH

12 = 12"
18 = 18"
24 = 24"
36 = 36"
42 = 42"

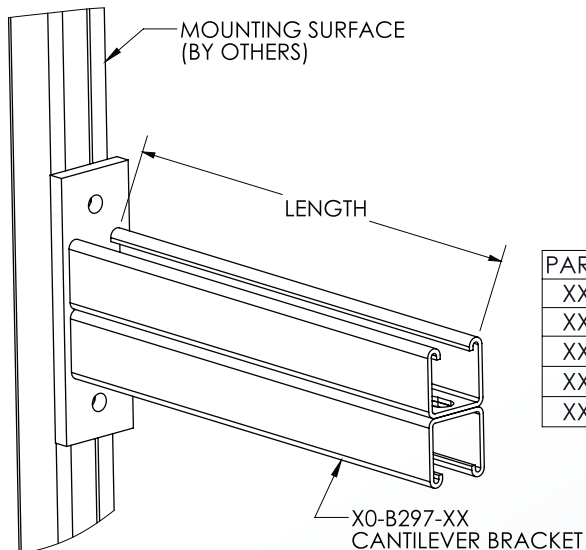

PART NUMBER	UNIFORM LOAD	TRAY WIDTH
XX-B297-12	1660 (lbs)	6 & 9
XX-B297-18	1100 (lbs)	12
XX-B297-24	835 (lbs)	18
XX-B297-30	665 (lbs)	24
XX-B297-42	465 (lbs)	36

4 International Drive
Rye Brook, NY 10573
Toll Free: 1 888.764.7681
Phone: 914.934.2075
Fax: 914.934.2190
MonoSystems.com



MonoSystems™
wire management. managed.™

Cable Tray XX-B409-XX

PowerTray™ Accessories

Manufactured in the USA by MonoSystems, Inc.



CANTILEVER BRACKET

Notes

- 1.) Attach strut bracket using 3/8" hardware (by others).
- 2.) Bracket material: 3/8" thick x 2" steel. Strut material: 12ga. steel.
- 3.) Views for reference - do not scale.

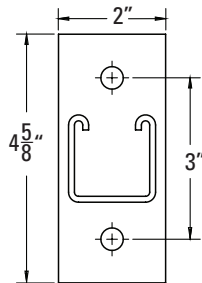
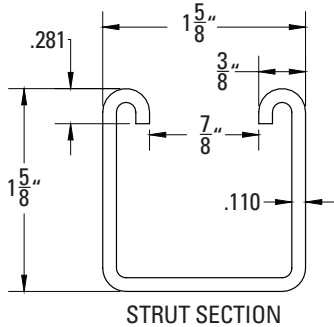

UL
C US
UL CLASSIFIED AS A
GROUNDING CONDUCTOR

ORDERING DATA EXAMPLE:

X 0-B409-XX

MATERIAL

G = HOT DIPPED
GALVANIZED STEEL
Z = ZINC PLATED
GALVANIZED STEEL

LENGTH

12 = 12"
18 = 18"
24 = 24"
30 = 30"
42 = 42"

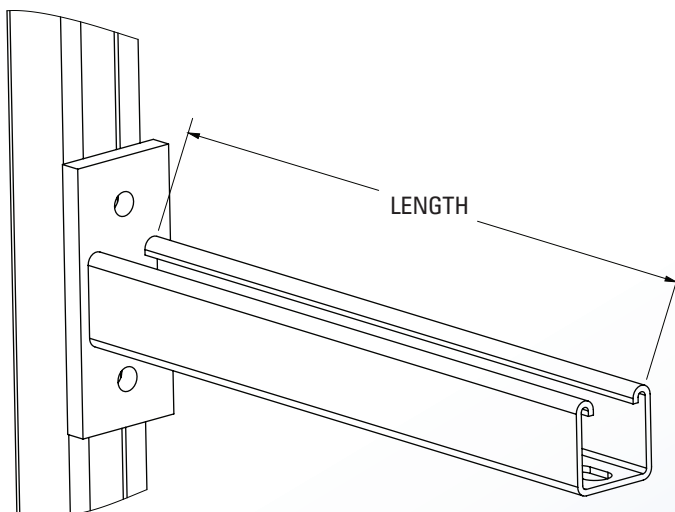

4 International Drive
Rye Brook, NY 10573
Toll Free: 1 888.764.7681
Phone: 914.934.2075
Fax: 914.934.2190
MonoSystems.com



MonoSystems™
wire management. managed.

Cable Tray / Trough Tray SBX-CTA-X

TroughTray™ Accessories

Manufactured by MonoSystems, Inc.

CONDUIT ADAPTOR PLATE

Notes:

- 1.) Use to attach a conduit feed to side of tray.
- 2.) Includes Ø 1/4" tray mounting hardware.
- 3.) Installation instructions: align conduit adaptor plate with side of tray. Be sure there is enough clearance above the top tray flange while also allowing access to tighten mounting screws within the tray. Once aligned, mark hole locations in tray using conduit adaptor as a template. Remove and field drill Ø 5/16" holes. Install conduit adaptor to side flange of tray using supplied 1/4-20 hardware as shown.
- 4.) Views for reference - do not scale.

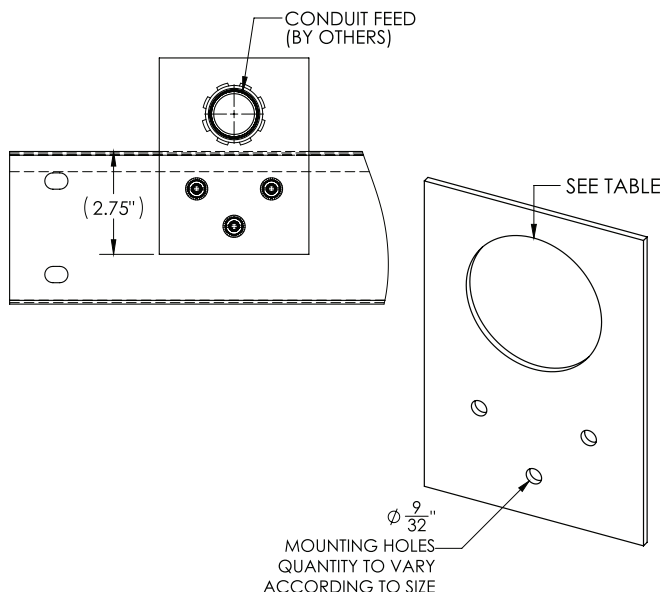

PART NUMBER	TRADE CONDUIT SIZE	HOLE DIAMETER
SBX-CTA-.5	1/2"	Ø 7/8"
SBX-CTA-.75	3/4"	Ø 1-1/8"
SBX-CTA-1	1"	Ø 1-3/8"
SBX-CTA-1.5	1-1/4"	Ø 1-3/4"
SBX-CTA-2	2"	Ø 2-1/2"
SBX-CTA-2.5	2-1/2"	Ø 3"
SBX-CTA-3	3	Ø 3-9/16"

ADDITIONAL SIZES AVAILABLE, SPEAK WITH MONOSYSTEMS

ORDERING DATA EXAMPLE:

SBX-CTA-X

MATERIAL

P = STEEL PRE-GALV
G = HDGAF
A = ALUMINUM
SS = 304 STAINLESS STEEL

CONDUIT SIZE

SEE TABLE

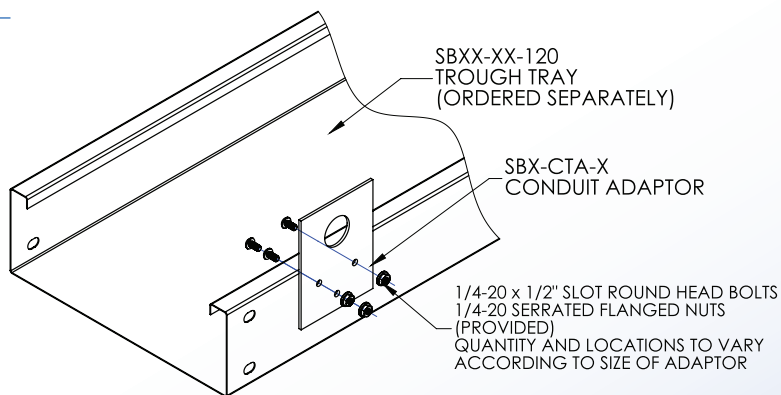

4 International Drive
Rye Brook, NY 10573
Toll Free: 1 888.764.7681
Phone: 914.934.2075
Fax: 914.934.2190
MonoSystems.com



Cable Tray / Ladder Tray CSUP-XX-XX

CableTray Accessories

Manufactured in the USA by MonoSystems, Inc.



C-SUPPORT BRACKET

Notes

- 1.) Ordered as each. For cable tray installation under ceilings or overhangs. Can be stacked for multiple levels of cable tray support.
- 2.) Bracket material: 13/16"x1-5/8" 14GA steel.
- 3.) Tray mounting hardware ordered separately. Wall or ceiling mounting hardware by others.
- 4.) Views for reference - Do not scale.

ORDERING DATA EXAMPLE:

CSUP-XX-XX

TRAY WIDTH

4 = 4" WIDE
6 = 6" WIDE
8 = 8" WIDE
9 = 9" WIDE
10 = 10" WIDE
12 = 12" WIDE
18 = 18" WIDE

MATERIAL

P = PREGALV
HD = HDGAF
PG = PAINTED GRAY
PB = PAINTED BLACK

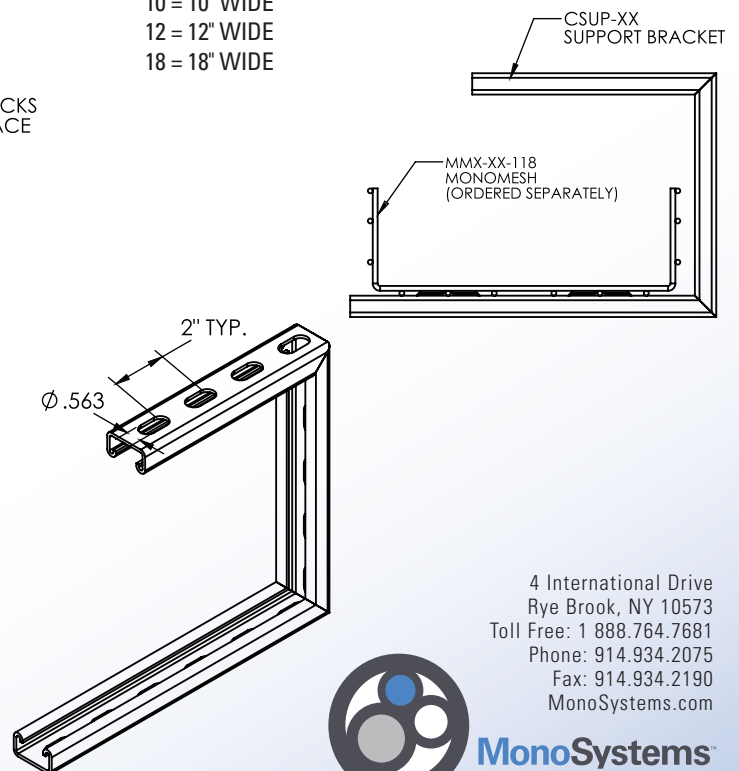
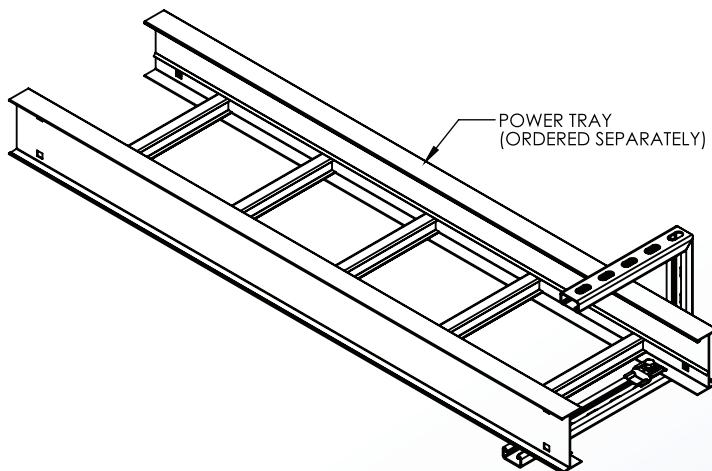
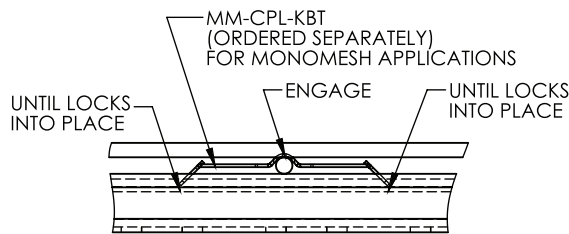
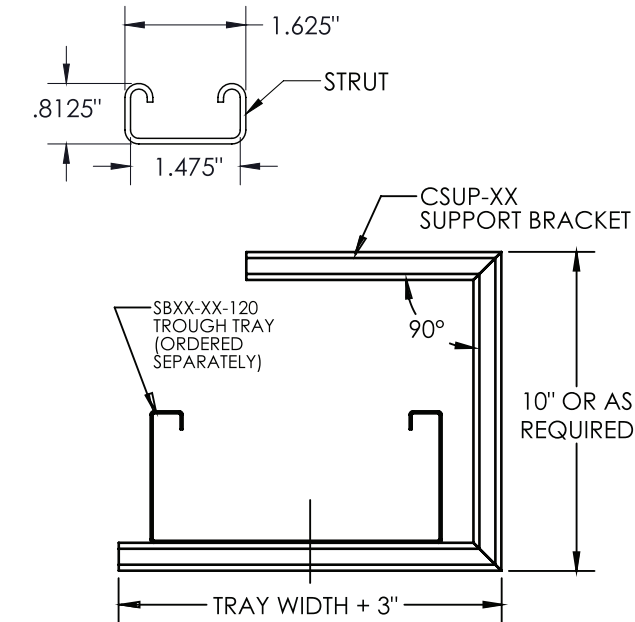

4 International Drive
Rye Brook, NY 10573
Toll Free: 1 888.764.7681
Phone: 914.934.2075
Fax: 914.934.2190
MonoSystems.com



MonoSystems
wire management. managed.

Cable Tray / Ladder Tray

DIV-CLIP-6

Cable Tray Accessories

Manufactured in the USA by MonoSystems, Inc.



DIVIDER ALIGNMENT CLIP, UNIVERSAL

Notes

- 1.) Sold as each. Standard length: 6"
- 2.) Use as a protective covering and straight Alignment clip for adjoining divider sections.
- 3.) Material: Clear PVC. Meets UL94 flame resistance requirement.
- 4.) To install:
 - Center clip about adjoining dividers
 - Snap over the seam pressing the clip completely into place
- 5.) Views for reference - Do not scale.

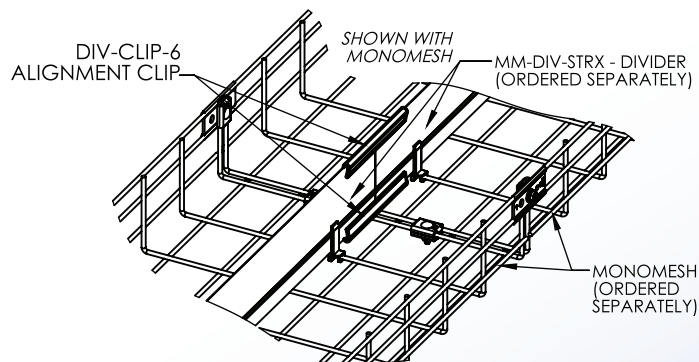
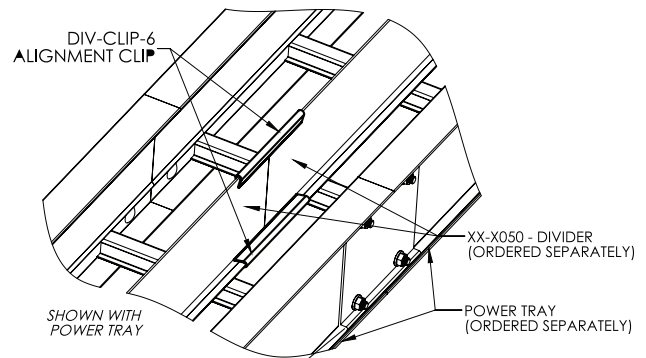
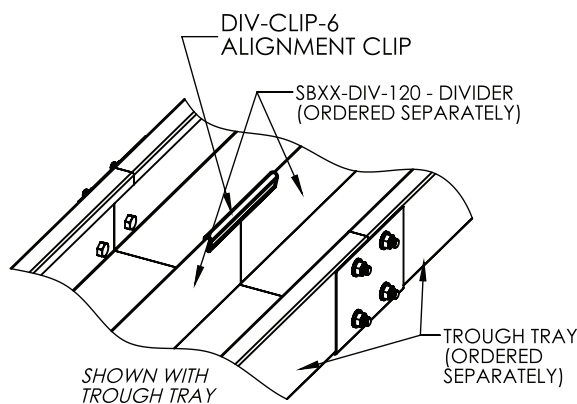
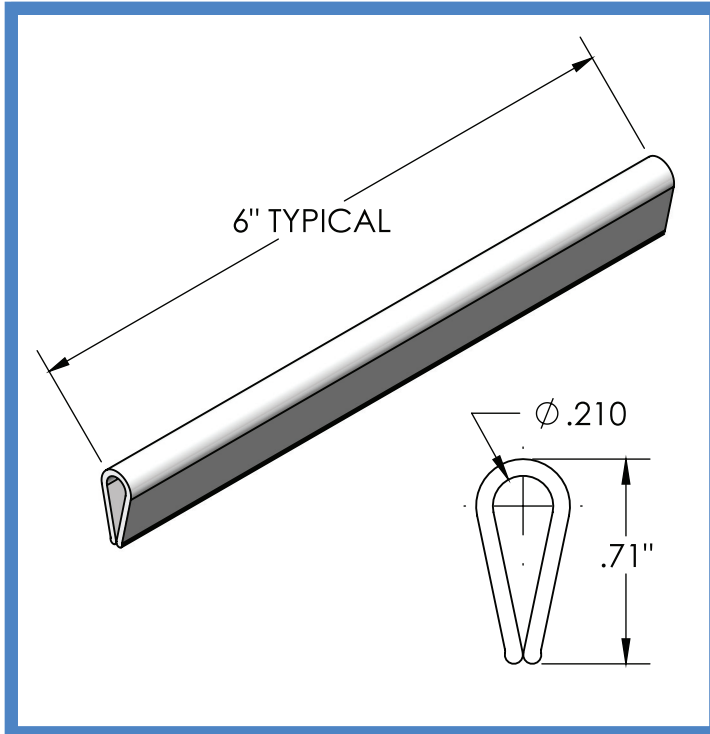

ORDERING DATA EXAMPLE:

DIV-CLIP-6

LENGTH

6 = 6" LONG

4 International Drive
Rye Brook, NY 10573
Toll Free: 1 888.764.7681
Phone: 914.934.2075
Fax: 914.934.2190
MonoSystems.com



Cable Tray / Ladder Tray X0-2027-X

PowerTray™ Accessories

Manufactured in the USA by MonoSystems, Inc.



WALL SUPPORT BRACKET

Notes

- 1.) Ordered as each.
- 2.) Bracket material: 3/16" steel or 1/4" aluminum.
- 3.) Mounting and support hardware (by others).
- 4.) Max. Uniform load 600lbs.
- 5.) Views for reference - Do not scale.

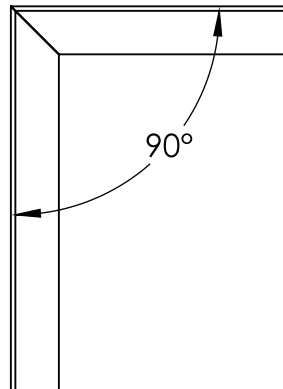
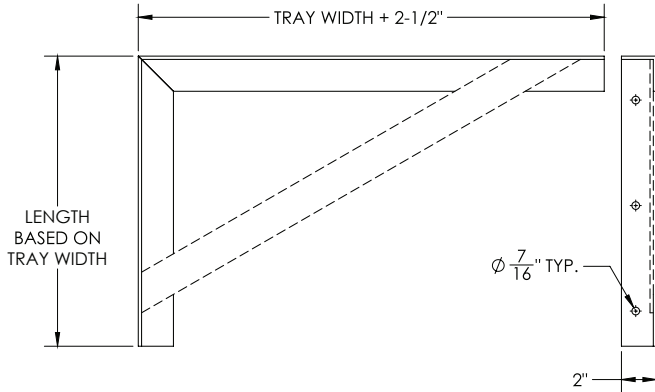

ORDERING DATA EXAMPLE:

X0-2027-XX

MATERIAL

G = H.D.G.A.F.
STEEL
Z = ZINC PLATED
STEEL
A = ALUMINUM

SERIES

06 = 6"
09 = 9"
12 = 12"
18 = 18"
24 = 24"
30 = 30"
36 = 36"

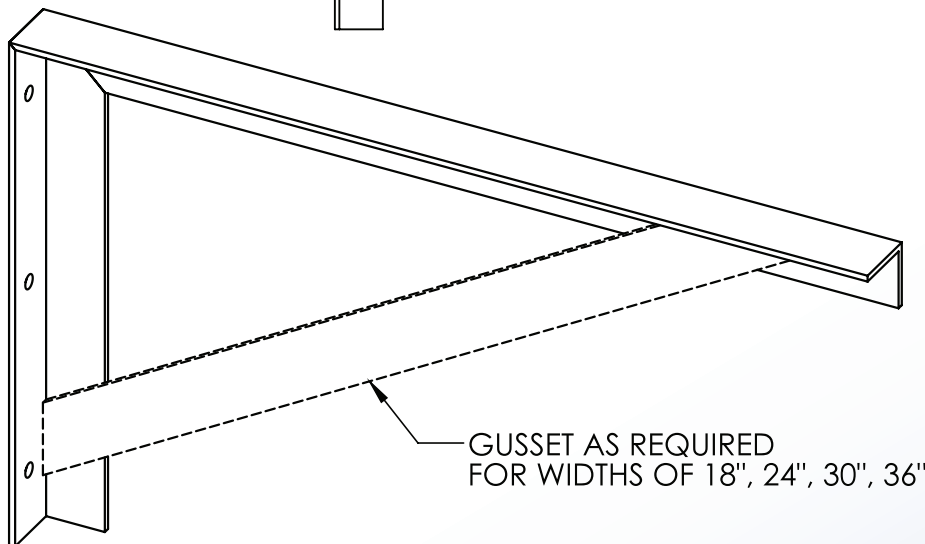

4 International Drive
Rye Brook, NY 10573
Toll Free: 1 888.764.7681
Phone: 914.934.2075
Fax: 914.934.2190
MonoSystems.com



Cable Tray / Trough Tray SBXX-2004-X

TroughTray™ Accessories

Manufactured by MonoSystems, Inc.

STEP-DOWN SPLICE CONNECTOR

Notes:

- 1.) Ordered as a pair. Use to junction tray sections of different height and the same width together.
- 2.) Step-down flat splice connectors can be mounted on the outside or inside of the adjoining tray sections.
- 3.) 3/8" Mounting hardware provided.
- 4.) Recommended torque: For 3/8" fasteners: 25-35 ft-lbs [33.9-47.5 N-M].
- 5.) Views for reference - do not scale.

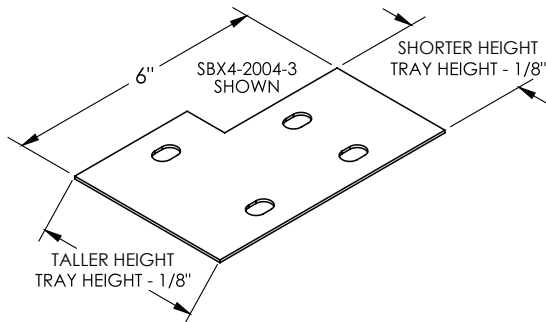
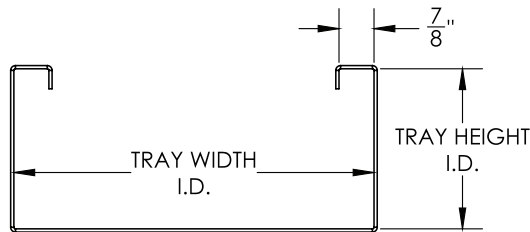

UL LISTED
FILE: E80034

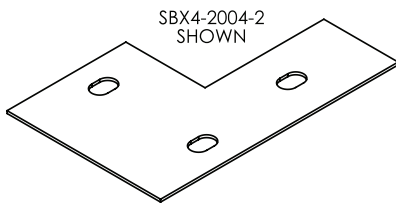
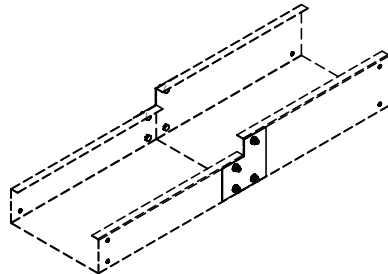

ORDERING DATA EXAMPLE:

SB X X - 2004 - X

MATERIAL

P = STEEL PRE-GALV
G = HOT DIPPED GALV.
A = ALUMINUM
4SS = 304 STAINLESS STEEL
6SS = 316 STAINLESS STEEL

TALLER HEIGHT

3 = 3"H
4 = 4"H
6 = 6"H

SHORTER HEIGHT

2 = 2"H
3 = 3"H
4 = 4"H

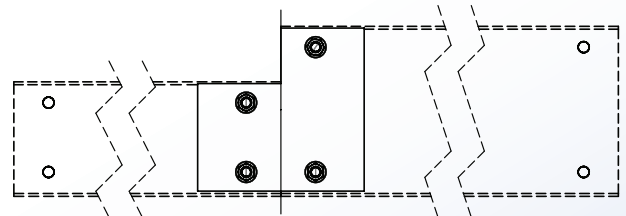
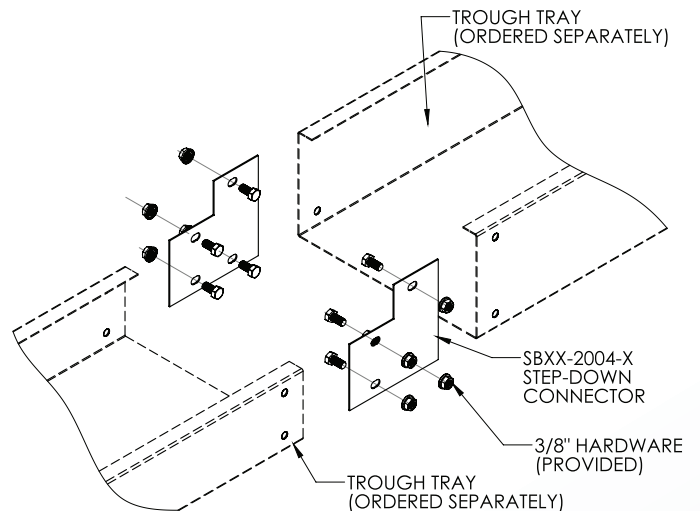

SHOWN MOUNTED ON OUTSIDE

4 International Drive
Rye Brook, NY 10573
Toll Free: 1 888.764.7681
Phone: 914.934.2075
Fax: 914.934.2190
MonoSystems.com



Cable Tray / Trough Tray

SBXX-2058

TroughTray™ Accessories
Manufactured by MonoSystems, Inc.

HORIZONTAL BEND DIVIDER (BAR-RIER STRIP) ALUMINUM AND STEEL TROUGH TRAY

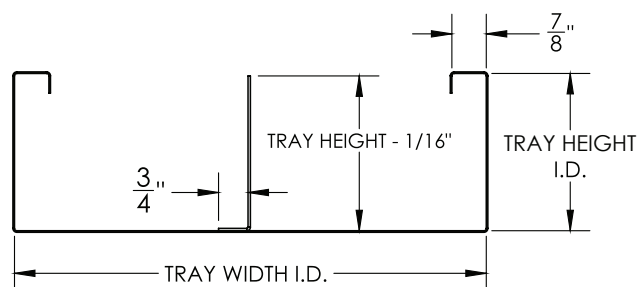

Notes:

- 1.) Ordered as each. Use to create separate compartments in a horizontal fitting.
- 2.) Supplied standard in 6ft lengths. Form into place and field-trim as needed. To prevent interference, do not secure divider on tray ends until after u-splice coupling is installed.
- 3.) Install using rivets, tek screws, or machine screws. Attachment hardware by others.
- 4.) Views for reference - do not scale.

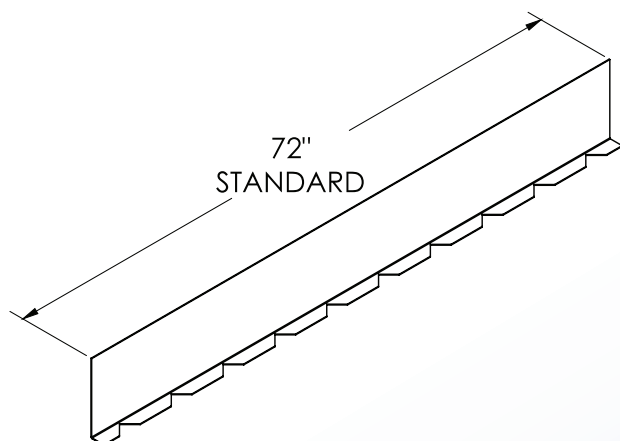
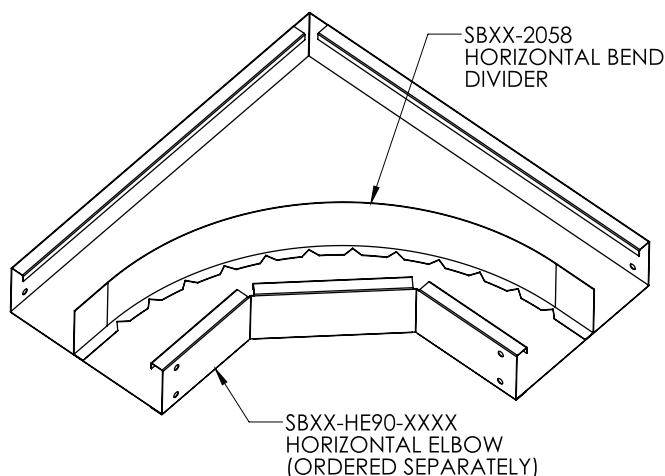

ORDERING DATA EXAMPLE:

SBXX-2058

MATERIAL

P = STEEL
PRE-GALV
G = HDGAF
A = ALUMINUM
4SS = 304 STAINLESS STEEL
6SS = 316 STAINLESS STEEL

TRAY HEIGHT

2 = 2"
3 = 3"
4 = 4"
6 = 6"

4 International Drive
Rye Brook, NY 10573
Toll Free: 1 888.764.7681
Phone: 914.934.2075
Fax: 914.934.2190
MonoSystems.com



MonoSystems™
Expect. Direct.