

Cable Tray / Channel Tray

SXX125-03-1XX

Channel Tray

Manufactured in the USA by MonoSystems, Inc.



3" Wide Channel Tray

General Information

- 1.) All straight sections come with a splice plate (sbx-1043) and 3/8" mounting hardware.
- 2.) Recommended torque: for 3/8" fasteners: 25-35 ft-lbs [33.9-47.5 N-m].
- 3.) Views for reference - do not scale.

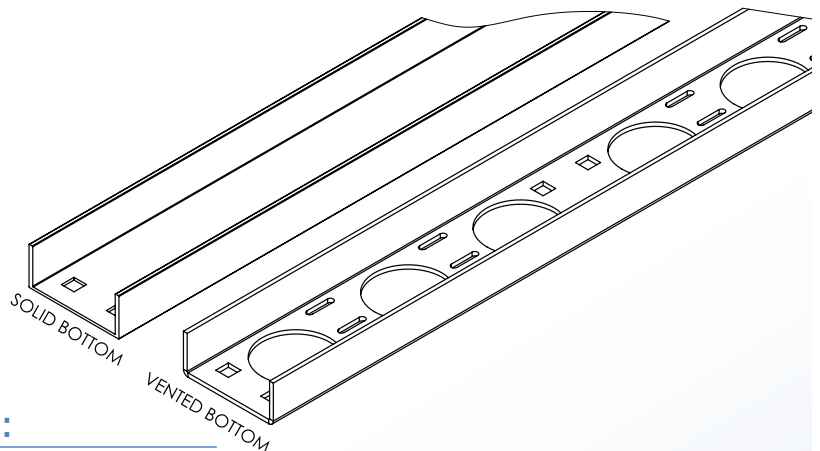
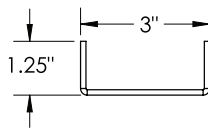
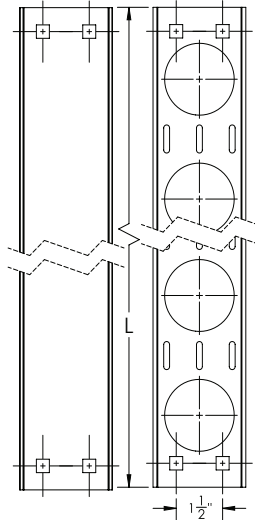

ORDERING DATA EXAMPLE:

S X X 125 - 03 - L

PATTERN

MATERIAL

TRAY HEIGHT

TRAY WIDTH

TRAY LENGTH

B = SOLID
BOTTOM
V = VENTED
BOTTOM

A = ALUMINUM
P = PREGLAV STEEL
G = HDGAF STEEL
SS4 = STAINLESS STEEL 304
SS6 = STAINLESS STEEL 316

125 = 1.25"

03 = 3"

120 = 120"
144 = 144"

4 International Drive
Rye Brook, NY 10573
Toll Free: 1 888.764.7681
Phone: 914.934.2075
Fax: 914.934.2190
MonoSystems.com



Cable Tray / Channel Tray

SXX175-04-1XX

Channel Tray

Manufactured in the USA by MonoSystems, Inc.



4" Wide Channel Tray

General Information

- 1.) All straight sections come with a splice plate (SBX-1044) and 3/8" mounting hardware.
- 2.) Recommended torque: for 3/8" fasteners: 25-35 ft-lbs [33.9-47.5 N-m].
- 3.) Views for reference - do not scale.

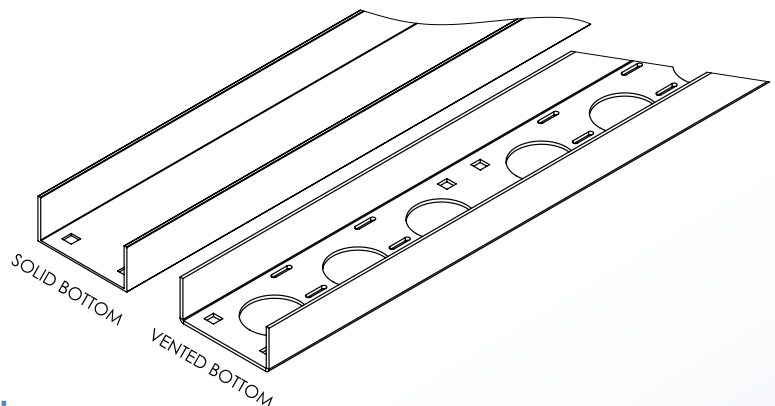
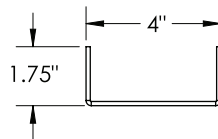
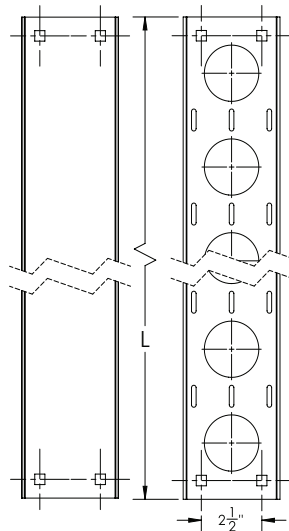

ORDERING DATA EXAMPLE:

S X X 175 - 04 - L

PATTERN

MATERIAL

TRAY HEIGHT

TRAY WIDTH

TRAY LENGTH

B = SOLID
BOTTOM
V = VENTED
BOTTOM

A = ALUMINUM
P = PREGLAV STEEL
G = HDGAF STEEL
SS4 = STAINLESS STEEL 304
SS6 = STAINLESS STEEL 316

175 = 1.75"

04 = 4"

120 = 120"
144 = 144"

4 International Drive
Rye Brook, NY 10573
Toll Free: 1 888.764.7681
Phone: 914.934.2075
Fax: 914.934.2190
MonoSystems.com



Cable Tray / Channel Tray

SXX175-06-1XX

Channel Tray

Manufactured in the USA by MonoSystems, Inc.

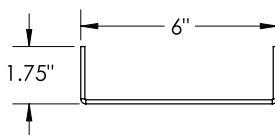
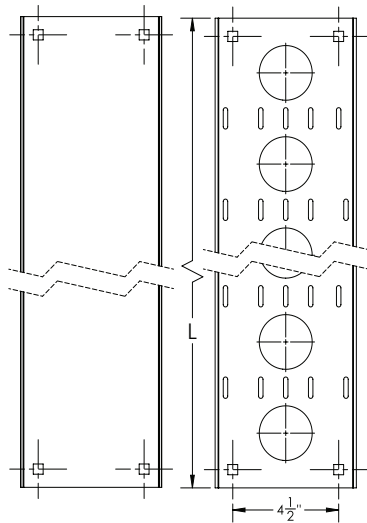

6" Wide Channel Tray

General Information

- 1.) All straight sections come with a splice plate (sbx-1046) and 3/8" mounting hardware.
- 2.) Recommended torque: for 3/8" fasteners: 25-35 ft-lbs [33.9-47.5 N-m].
- 3.) Views for reference - do not scale.

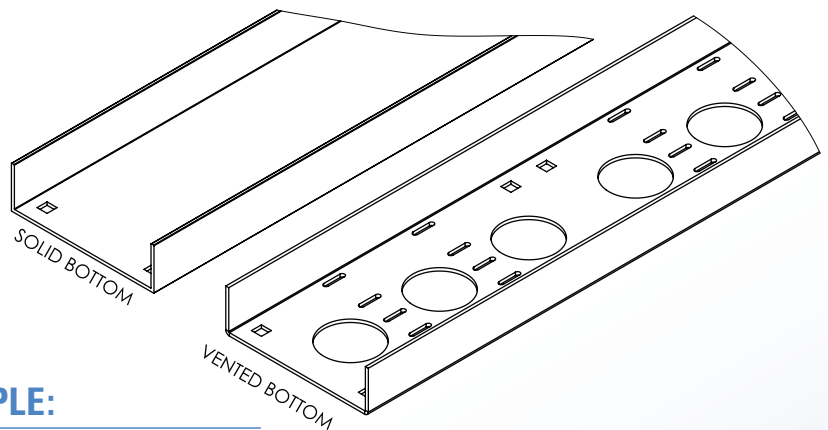

ORDERING DATA EXAMPLE:

S X X 175 - 06 - L

PATTERN

MATERIAL

TRAY HEIGHT

TRAY WIDTH

TRAY LENGTH

B = SOLID
BOTTOM
V = VENTED
BOTTOM

A = ALUMINUM
P = PREGLAV STEEL
G = HDGAF STEEL
SS4 = STAINLESS STEEL 304
SS6 = STAINLESS STEEL 316

175 = 1.75"

06 = 6"

120 = 120"
144 = 144"

4 International Drive
Rye Brook, NY 10573
Toll Free: 1 888.764.7681
Phone: 914.934.2075
Fax: 914.934.2190
MonoSystems.com



MonoSystems™
Expect. Direct.

Cable Tray / Channel Tray

SXX-XX-30HBXX

Channel Tray Fittings
Manufactured in the USA by MonoSystems, Inc.



30° Horizontal Bend

General Information

- 1.) Attach bend to channel tray using (1) supplied splice plate (sbx-104x) and provided 3/8" hardware.
- 2.) Recommended torque: for 3/8" fasteners 25-35 ft-lbs [33.9-47.5 N-m].
- 3.) Views for reference - do not scale.

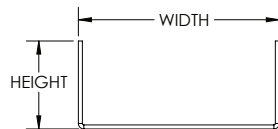
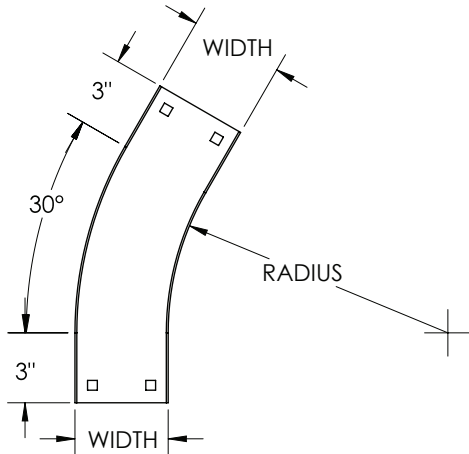

TRAY HEIGHT		TRAY WIDTH	
H		W	
IN.	MM.	IN.	MM.
1.25	32	3	76
1.75	44	4	101
1.75	44	6	152

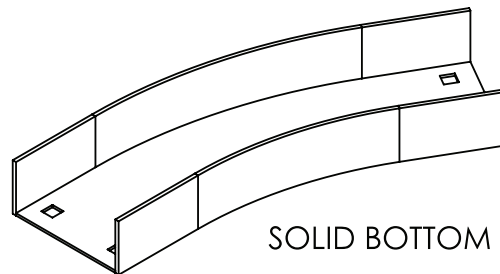

SOLID BOTTOM

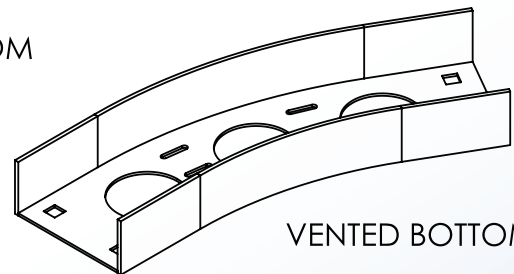

VENTED BOTTOM

ORDERING DATA EXAMPLE:

SXX - XX - 30 HB XX

PATTERN

MATERIAL

WIDTH

ANGLE

FITTING TYPE

RADIUS

B = SOLID
BOTTOM
V = VENTED
BOTTOM

A = ALUMINUM
P = PREGLAV STEEL
G = HDGAF STEEL
SS4 = STAINLESS STEEL 304
SS6 = STAINLESS STEEL 316

03 = 3"
04 = 4"
06 = 6"

30°

HB = HORIZONTAL
BEND

12 = 12"
24 = 24"
36 = 36"
48 = 48"



MonoSystems™
Expect. Direct.

4 International Drive
Rye Brook, NY 10573
Toll Free: 1 888.764.7681
Phone: 914.934.2075
Fax: 914.934.2190
MonoSystems.com

Cable Tray / Channel Tray

SXX-XX-30IVXX

Channel Tray Fittings
Manufactured in the USA by MonoSystems, Inc.



30° Inside Vertical Bend

General Information

- 1.) Attach bend to channel tray using (1) supplied splice plate (SBX-104X) and provided 3/8" hardware.
- 2.) Recommended torque: for 3/8" fasteners 25-35 ft-lbs [33.9-47.5 N-m].
- 3.) Views for reference - do not scale.

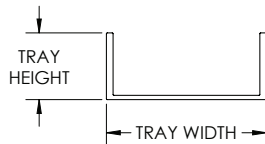
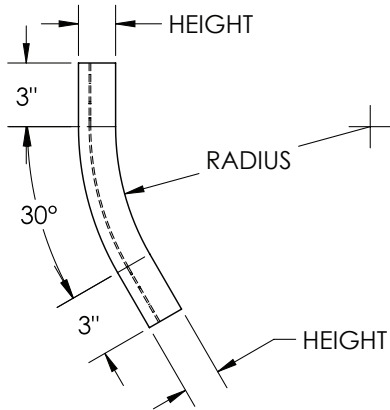

TRAY HEIGHT		TRAY WIDTH	
H		W	
IN.	MM.	IN.	MM.
1.25	32	3	76
1.75	44	4	101
1.75	44	6	152

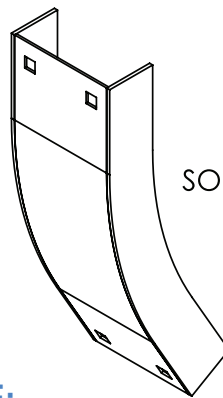

SOLID BOTTOM

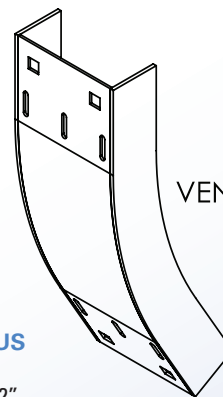

VENTED BOTTOM

ORDERING DATA EXAMPLE:

SXX - XX - 30 - IV XX

STYLE

MATERIAL

WIDTH

FITTING ANGLE

FITTING TYPE

RADIUS

B = SOLID
BOTTOM
V = VENTED
BOTTOM

A = ALUMINUM
P = PREGLAV STEEL
G = HDGAF STEEL
SS4 = STAINLESS STEEL 304
SS6 = STAINLESS STEEL 316

03 = 3"
04 = 4"
06 = 6"

30°

IV = INSIDE
VERTICAL
BEND

12 = 12"
24 = 24"
36 = 36"
48 = 48"

4 International Drive
Rye Brook, NY 10573
Toll Free: 1 888.764.7681
Phone: 914.934.2075
Fax: 914.934.2190
MonoSystems.com



MonoSystems™
Expect. Direct.

Cable Tray / Channel Tray

SXX-XX-300VXX

Channel Tray Fittings

Manufactured in the USA by MonoSystems, Inc.



30° Outside Vertical Bend

General Information

- 1.) Attach bend to channel tray using (1) supplied splice plate (sbx-104x) and provided 3/8" hardware.
- 2.) Recommended torque: for 3/8" fasteners 25-35 ft-lbs [33.9-47.5 N-m].
- 3.) Views for reference - do not scale.

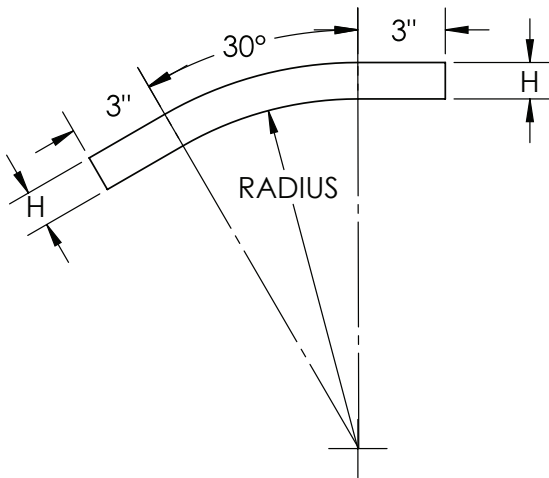

TRAY HEIGHT		TRAY WIDTH	
H		W	
IN.	MM.	IN.	MM.
1.25	32	3	76
1.75	44	4	101
1.75	44	6	152

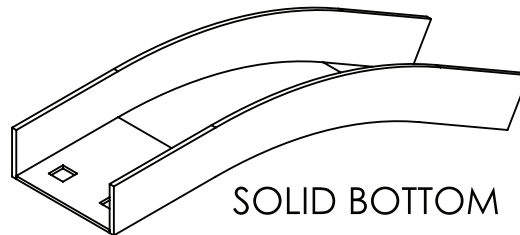

SOLID BOTTOM

ORDERING DATA EXAMPLE:

SXX - XX - 30 0V XX

STYLE

MATERIAL

WIDTH

ANGLE

FITTING TYPE

RADIUS

B = SOLID
BOTTOM
V = VENTED
BOTTOM

A = ALUMINUM
P = PREGLAV STEEL
G = HDGAF STEEL
SS4 = STAINLESS STEEL 304
SS6 = STAINLESS STEEL 316

03 = 3"
04 = 4"
06 = 6"

30=30°

0V = OUTSIDE
VERTICAL BEND

12 = 12"
24 = 24"
36 = 36"
48 = 48"

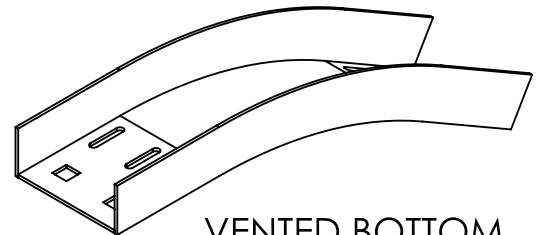

VENTED BOTTOM

4 International Drive
Rye Brook, NY 10573
Toll Free: 1 888.764.7681
Phone: 914.934.2075
Fax: 914.934.2190
MonoSystems.com



Cable Tray / Channel Tray

SXX-XX-45HBXX

Channel Tray Fittings
Manufactured in the USA by MonoSystems, Inc.



45° Horizontal Bend

General Information

- 1.) Attach bend to channel tray using (1) supplied splice plate (sbx-104x) and provided 3/8" hardware.
- 2.) Recommended torque: for 3/8" fasteners 25-35 ft-lbs [33.9-47.5 N-m].
- 3.) Views for reference - do not scale.

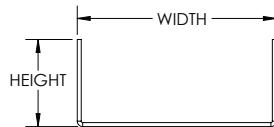
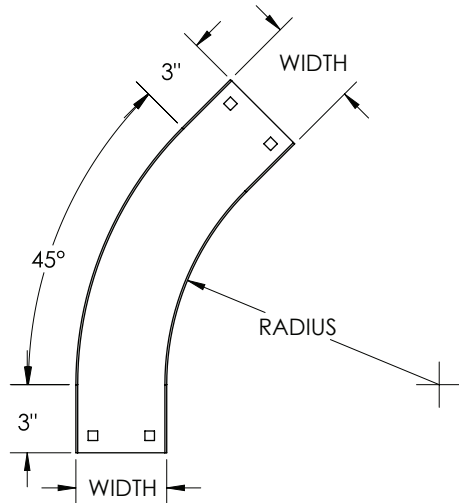

TRAY HEIGHT		TRAY WIDTH	
H		W	
IN.	MM.	IN.	MM.
1.25	32	3	76
1.75	44	4	101
1.75	44	6	152

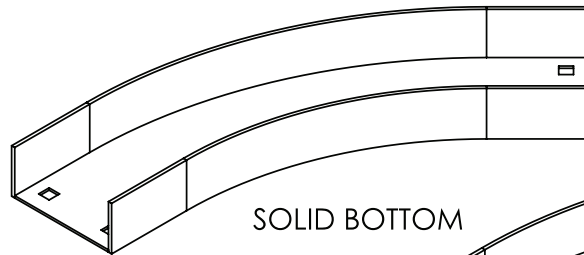

SOLID BOTTOM

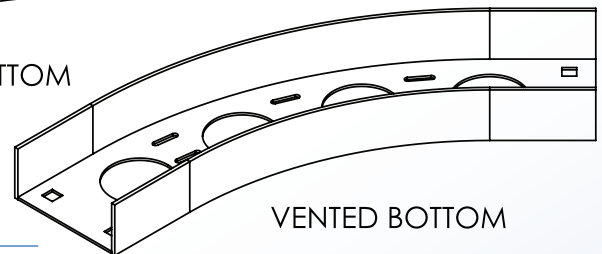

VENTED BOTTOM

ORDERING DATA EXAMPLE:

SXX - XX - 45 HB XX

PATTERN

MATERIAL

WIDTH

ANGLE

FITTING TYPE

RADIUS

B = SOLID
BOTTOM
V = VENTED
BOTTOM

A = ALUMINUM
P = PREGLAV STEEL
G = HDGAF STEEL
SS4 = STAINLESS STEEL 304
SS6 = STAINLESS STEEL 316

03 = 3"
04 = 4"
06 = 6"

45 = 45°

HB = HORIZONTAL
BEND

12
24
36
48

4 International Drive
Rye Brook, NY 10573
Toll Free: 1 888.764.7681
Phone: 914.934.2075
Fax: 914.934.2190
MonoSystems.com



Cable Tray / Channel Tray

SXX-XX-45IVXX

Channel Tray Fittings

Manufactured in the USA by MonoSystems, Inc.



45° Inside Vertical Bend

General Information

- 1.) Attach bend to channel tray using (1) supplied splice plate (sbx-104x) and provided 3/8" hardware.
- 2.) Recommended torque: for 3/8" fasteners 25-35 ft-lbs [33.9-47.5 N-m].
- 3.) Views for reference - do not scale.

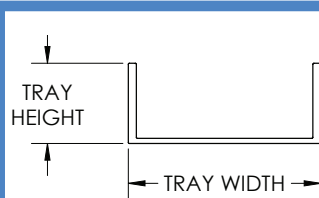
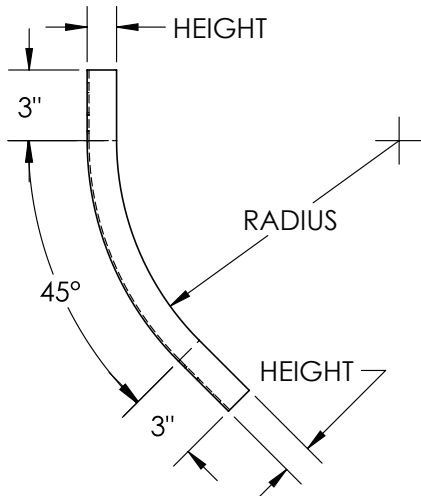

TRAY HEIGHT		TRAY WIDTH	
H		W	
IN.	MM.	IN.	MM.
1.25	32	3	76
1.75	44	4	101
1.75	44	6	152



SOLID BOTTOM

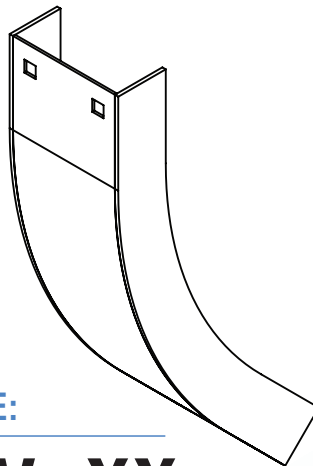

VENTED BOTTOM

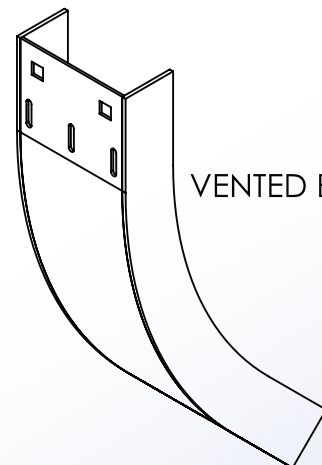

ORDERING DATA EXAMPLE:

SXX - XX - 45 IV XX

STYLE

MATERIAL

WIDTH

FITTING
ANGLE

FITTING TYPE

RADIUS

B = SOLID
BOTTOM
V = VENTED
BOTTOM

A = ALUMINUM
P = PREGLAV STEEL
G = HDGAF STEEL
SS4 = STAINLESS STEEL 304
SS6 = STAINLESS STEEL 316

03 = 3"
04 = 4"
06 = 6"

45°

IV = INSIDE
VERTICAL BEND

12 = 12"
24 = 24"
36 = 36"
48 = 48"

4 International Drive
Rye Brook, NY 10573
Toll Free: 1 888.764.7681
Phone: 914.934.2075
Fax: 914.934.2190
MonoSystems.com



MonoSystems™
Expect. Direct.

Cable Tray / Channel Tray

SXX-XX-450VXX

Channel Tray Fittings

Manufactured in the USA by MonoSystems, Inc.



45° Outside Vertical Bend

General Information

- 1.) Attach bend to channel tray using (1) supplied splice plate (sbx-104x) And provided 3/8" hardware.
- 2.) Recommended torque: for 3/8" fasteners 25-35 ft-lbs [33.9-47.5 N-m].
- 3.) Views for reference - do not scale.

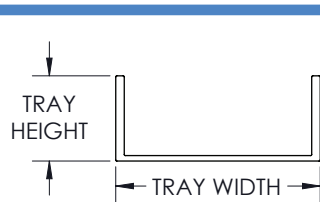
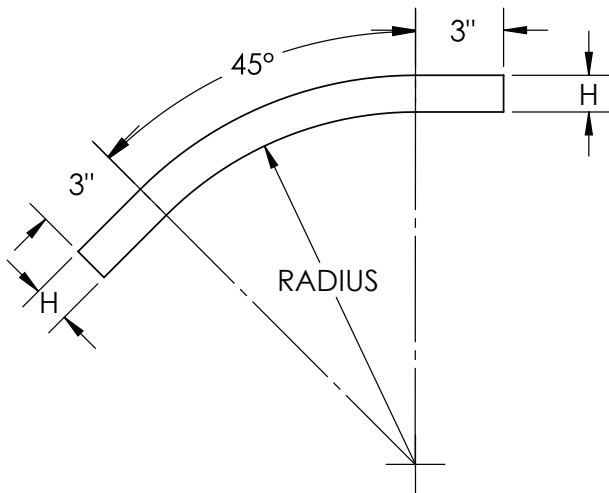

TRAY HEIGHT		TRAY WIDTH	
H		W	
IN.	MM.	IN.	MM.
1.25	32	3	76
1.75	44	4	101
1.75	44	6	152

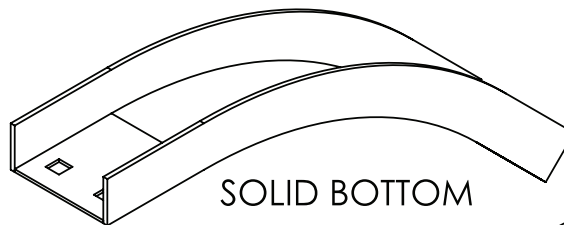

SOLID BOTTOM



VENTED BOTTOM

ORDERING DATA EXAMPLE:

SXX - XX - 45 OV XX

STYLE

MATERIAL

WIDTH

ANGLE

FITTING TYPE

RADIUS

B = SOLID
BOTTOM
V = VENTED
BOTTOM

A = ALUMINUM
P = PREGLAV STEEL
G = HDGAF STEEL
SS4 = STAINLESS STEEL 304
SS6 = STAINLESS STEEL 316

03 = 3"
04 = 4"
06 = 6"

45 = 45°

OV = OUTSIDE
VERTICAL BEND

12 = 12"
24 = 24"
36 = 36"
48 = 48"

4 International Drive
Rye Brook, NY 10573
Toll Free: 1 888.764.7681
Phone: 914.934.2075
Fax: 914.934.2190
MonoSystems.com



Cable Tray / Channel Tray

SXX-XX-60HBXX

Channel Tray Fittings
Manufactured in the USA by MonoSystems, Inc.



60° Horizontal Bend

General Information

- 1.) Attach bend to channel tray using (1) supplied splice plate (sbx-104x) and provided 3/8" hardware.
- 2.) Recommended torque: for 3/8" fasteners 25-35 ft-lbs [33.9-47.5 N-m].
- 3.) Views for reference - do not scale.

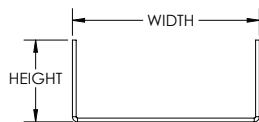
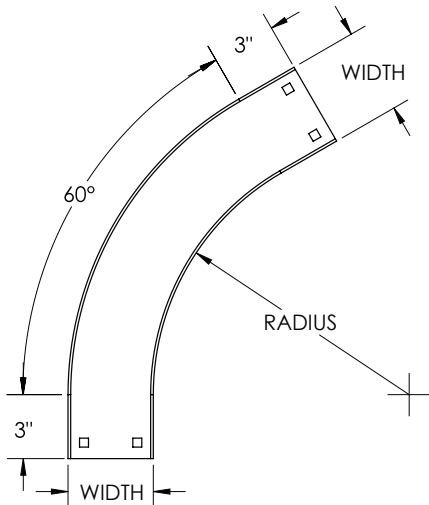

TRAY HEIGHT		TRAY WIDTH	
H		W	
IN.	MM.	IN.	MM.
1.25	32	3	76
1.75	44	4	101
1.75	44	6	152

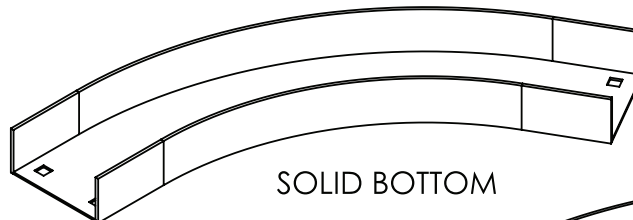

SOLID BOTTOM

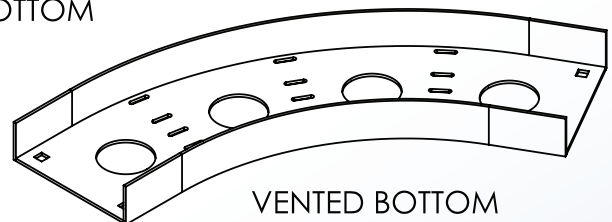

VENTED BOTTOM

ORDERING DATA EXAMPLE:

SXX - XX - 60 HB XX

PATTERN

MATERIAL

WIDTH

ANGLE

FITTING TYPE

RADIUS

B = SOLID
BOTTOM
V = VENTED
BOTTOM

A = ALUMINUM
P = PREGLAV STEEL
G = HDGAF STEEL
SS4 = STAINLESS STEEL 304
SS6 = STAINLESS STEEL 316

03 = 3"
04 = 4"
06 = 6"

60=60°

HB = HORIZONTAL
BEND

12
24
36
48

4 International Drive
Rye Brook, NY 10573
Toll Free: 1 888.764.7681
Phone: 914.934.2075
Fax: 914.934.2190
MonoSystems.com



MonoSystems™
Expect. Direct.

Cable Tray / Channel Tray

SXX-XX-60IVXX

Channel Tray Fittings

Manufactured in the USA by MonoSystems, Inc.



60° Inside Vertical Bend

General Information

- 1.) Attach bend to channel tray using (1) supplied splice plate (sbx-104x) and provided 3/8" hardware.
- 2.) Recommended torque: for 3/8" fasteners 25-35 ft-lbs [33.9-47.5 N-m].
- 3.) Views for reference - do not scale.

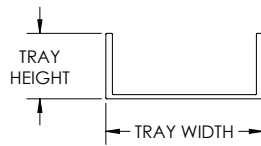
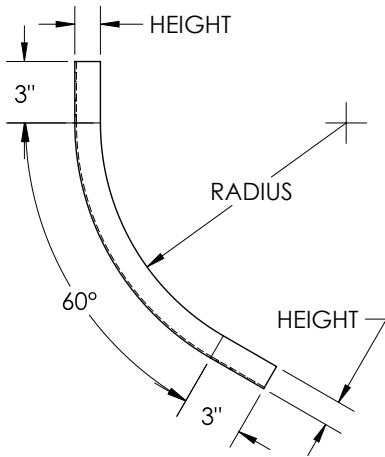

TRAY HEIGHT		TRAY WIDTH	
H		W	
IN.	MM.	IN.	MM.
1.25	32	3	76
1.75	44	4	101
1.75	44	6	152



SOLID BOTTOM

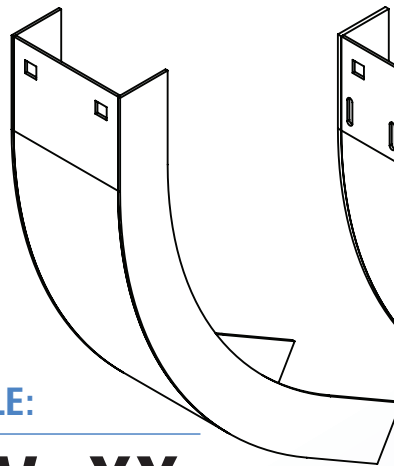

VENTED BOTTOM

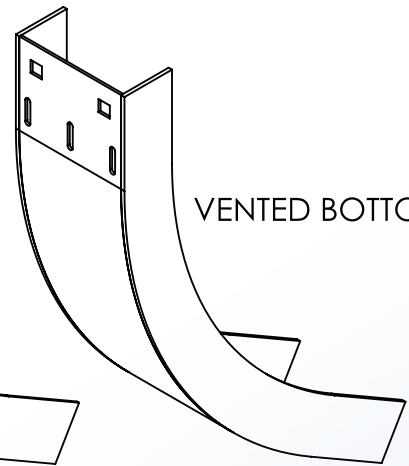

ORDERING DATA EXAMPLE:

SXX - XX - 60 IV XX

STYLE

MATERIAL

WIDTH

FITTING
ANGLE

FITTING TYPE

RADIUS

B = SOLID
BOTTOM
V = VENTED
BOTTOM

A = ALUMINUM
P = PREGLAV STEEL
G = HDGAF STEEL
SS4 = STAINLESS STEEL 304
SS6 = STAINLESS STEEL 316

03 = 3"
04 = 4"
06 = 6"

60°

IV = INSIDE
VERTICAL
BEND

12 = 12"
24 = 24"
36 = 36"
48 = 48"

4 International Drive
Rye Brook, NY 10573
Toll Free: 1 888.764.7681
Phone: 914.934.2075
Fax: 914.934.2190
MonoSystems.com



MonoSystems™
Expect. Direct.

Cable Tray / Channel Tray

SXX-XX-600VXX

Channel Tray Fittings

Manufactured in the USA by MonoSystems, Inc.



60° Outside Vertical Bend

General Information

- 1.) Attach bend to channel tray using (1) supplied splice plate (sbx-104x) and provided 3/8" hardware.
- 2.) Recommended torque: for 3/8" fasteners 25-35 ft-lbs [33.9-47.5 N-m].
- 3.) Views for reference - do not scale.

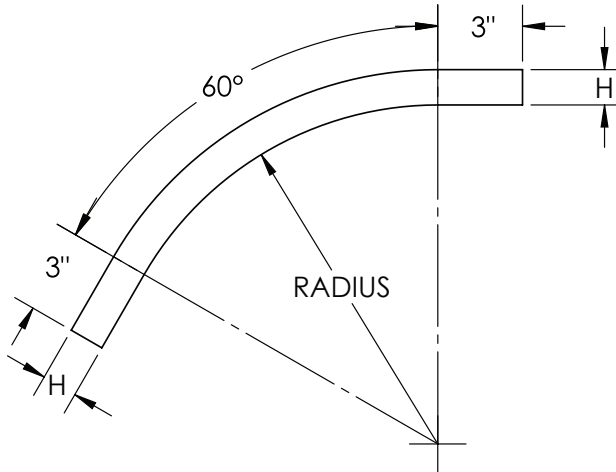

TRAY HEIGHT		TRAY WIDTH	
H		W	
IN.	MM.	IN.	MM.
1.25	32	3	76
1.75	44	4	101
1.75	44	6	152

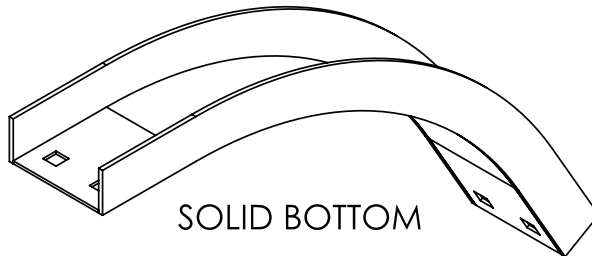

SOLID BOTTOM



VENTED BOTTOM

ORDERING DATA EXAMPLE:

SXX - XX - 60 OV XX

STYLE

MATERIAL

WIDTH

ANGLE

FITTING TYPE

RADIUS

B = SOLID
BOTTOM
V = VENTED
BOTTOM

A = ALUMINUM
P = PREGLAV STEEL
G = HDGAF STEEL
SS4 = STAINLESS STEEL 304
SS6 = STAINLESS STEEL 316

03 = 3"
04 = 4"
06 = 6"

60 = 60°

OV = OUTSIDE
VERTICAL
BEND

12 = 12"
24 = 24"
36 = 36"
48 = 48"

4 International Drive
Rye Brook, NY 10573
Toll Free: 1 888.764.7681
Phone: 914.934.2075
Fax: 914.934.2190
MonoSystems.com



MonoSystems™
Expect. Direct.

Cable Tray / Channel Tray

SXX-XX-90HBXX

Channel Tray Fittings
Manufactured in the USA by MonoSystems, Inc.



90° Horizontal Bend

General Information

- 1.) Attach bend to channel tray using (1) supplied splice plate (sbx-104x) and provided 3/8" hardware.
- 2.) Recommended torque: for 3/8" fasteners 25-35 ft-lbs [33.9-47.5 N-m].
- 3.) Views for reference - do not scale.

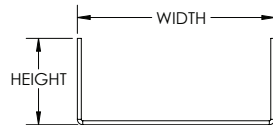
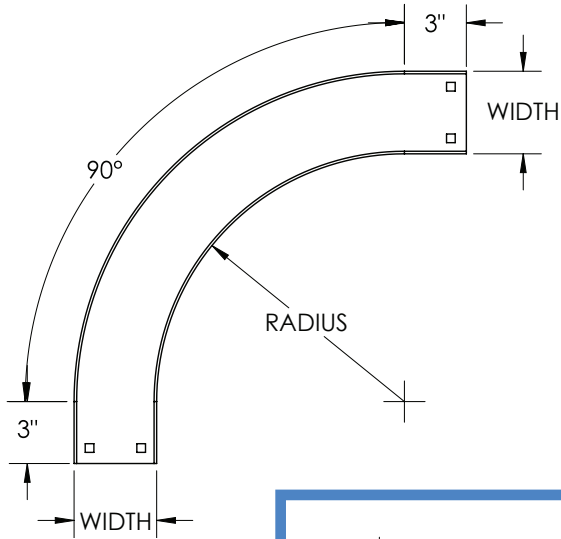

TRAY HEIGHT		TRAY WIDTH	
H		W	
IN.	MM.	IN.	MM.
1.25	32	3	76
1.75	44	4	101
1.75	44	6	152

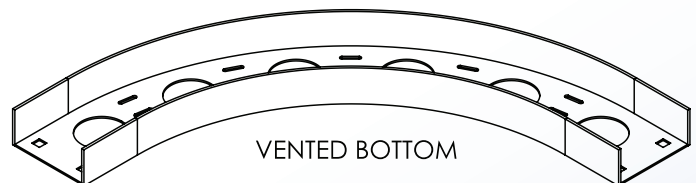
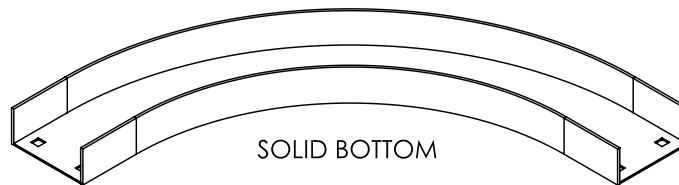

ORDERING DATA EXAMPLE:

SXX - XX - 90 HB XX

PATTERN

MATERIAL

WIDTH

ANGLE

FITTING TYPE

RADIUS

B = SOLID
BOTTOM
V = VENTED
BOTTOM

A = ALUMINUM
P = PREGLAV STEEL
G = HDGAF STEEL
SS4 = STAINLESS STEEL 304
SS6 = STAINLESS STEEL 316

03 = 3"
04 = 4"
06 = 6"

90 = 90°

HB = HORIZONTAL
BEND

12 = 12"
24 = 24"
36 = 36"
48 = 48"

4 International Drive
Rye Brook, NY 10573
Toll Free: 1 888.764.7681
Phone: 914.934.2075
Fax: 914.934.2190
MonoSystems.com



MonoSystems™
Expect. Direct.

Cable Tray / Channel Tray

SXX-XX-90IVXX

Channel Tray Fittings

Manufactured in the USA by MonoSystems, Inc.



90° Inside Vertical Bend

General Information

- 1.) Attach bend to channel tray using (1) supplied splice plate (sbx-104x) and provided 3/8" hardware.
- 2.) Recommended torque: for 3/8" fasteners 25-35 ft-lbs [33.9-47.5 N-m].
- 3.) Views for reference - do not scale.

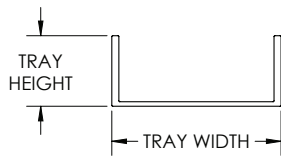
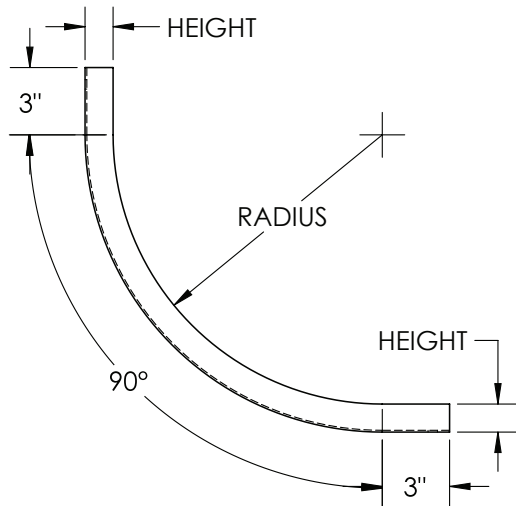

TRAY HEIGHT		TRAY WIDTH	
H		W	
IN.	MM.	IN.	MM.
1.25	32	3	76
1.75	44	4	101
1.75	44	6	152

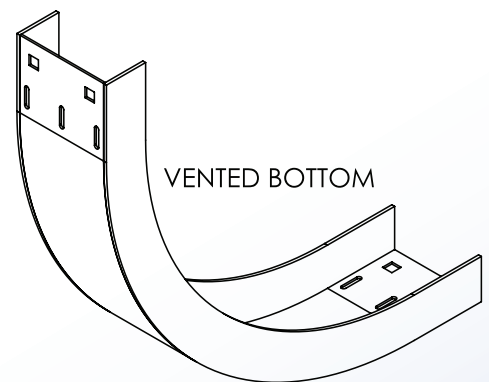
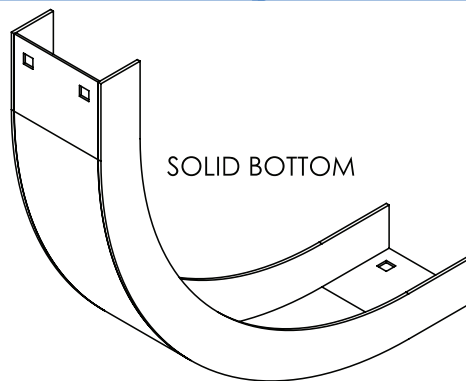

ORDERING DATA EXAMPLE:

SXX - XX - 90 IV XX

STYLE

MATERIAL

WIDTH

FITTING
ANGLE

FITTING TYPE

RADIUS

B = SOLID
BOTTOM
V = VENTED
BOTTOM

A = ALUMINUM
P = PREGLAV STEEL
G = HDGAF STEEL
SS4 = STAINLESS STEEL 304
SS6 = STAINLESS STEEL 316

03 = 3"
04 = 4"
06 = 6"

90°

IV = INSIDE
VERTICAL
BEND

12 = 12"
24 = 24"
36 = 36"
48 = 48"

4 International Drive
Rye Brook, NY 10573
Toll Free: 1 888.764.7681
Phone: 914.934.2075
Fax: 914.934.2190
MonoSystems.com



MonoSystems™
Expect. Direct.

Cable Tray / Channel Tray

SXX-XX-90VXX

Channel Tray Fittings

Manufactured in the USA by MonoSystems, Inc.



90° Outside Vertical Bend

General Information

- 1.) Attach bend to channel tray using (1) supplied splice plate (SBX-104X) and provided 3/8" hardware.
- 2.) Recommended torque: for 3/8" fasteners 25-35 ft-lbs [33.9-47.5 N-m].
- 3.) Views for reference - do not scale.

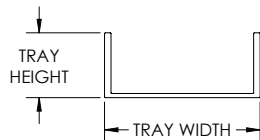
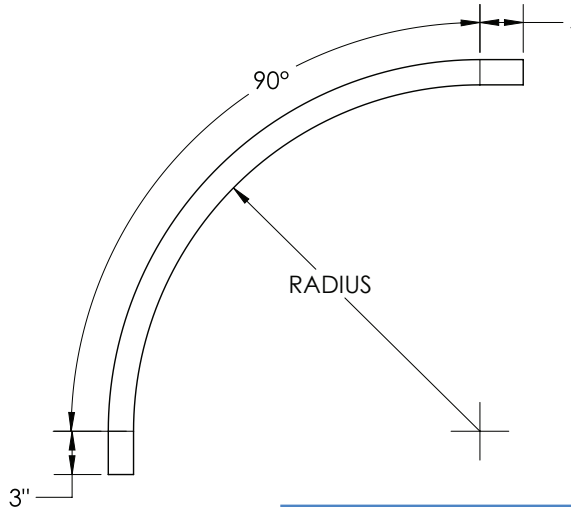

TRAY HEIGHT		TRAY WIDTH	
H		W	
IN.	MM.	IN.	MM.
1.25	32	3	76
1.75	44	4	101
1.75	44	6	152

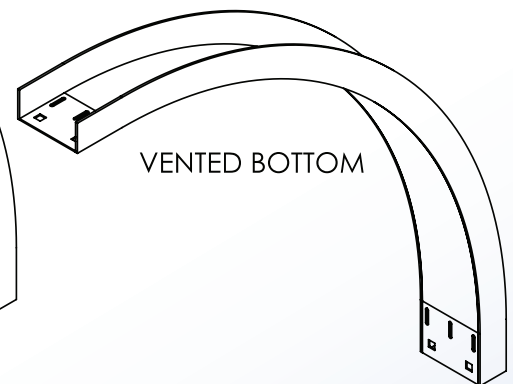
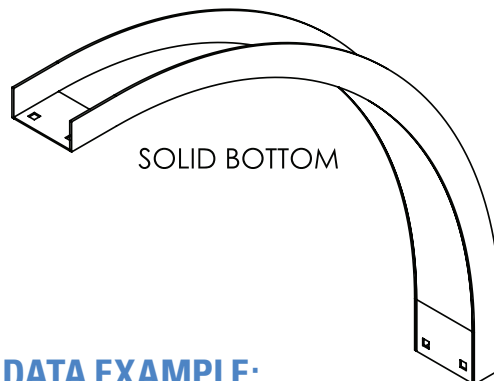

ORDERING DATA EXAMPLE:

SXX - XX - 90 OV XX

STYLE

MATERIAL

WIDTH

ANGLE

FITTING TYPE

RADIUS

B = SOLID
BOTTOM
V = VENTED
BOTTOM

A = ALUMINUM
P = PREGLAV STEEL
G = HDGAF STEEL
SS4 = STAINLESS STEEL 304
SS6 = STAINLESS STEEL 316

03 = 3"
04 = 4"
06 = 6"

90°

OV = OUTSIDE
VERTICAL
BEND

12 = 12"
24 = 24"
36 = 36"
48 = 48"

4 International Drive
Rye Brook, NY 10573
Toll Free: 1 888.764.7681
Phone: 914.934.2075
Fax: 914.934.2190
MonoSystems.com



Cable Tray / Channel Tray

SX-XX-90VC06

Channel Tray Fittings
Manufactured in the USA by MonoSystems, Inc.



Vertical 90° Bend, 6" Rad Plate, Channel Tray

General Information

1. Attach radius plate to channel tray using provided 3/8" hardware as shown.
- 2.) Recommended torque: for 3/8" fasteners
25-35 ft-lbs [33.9-47.5 N-m].
- 3.) Views for reference - do not scale.

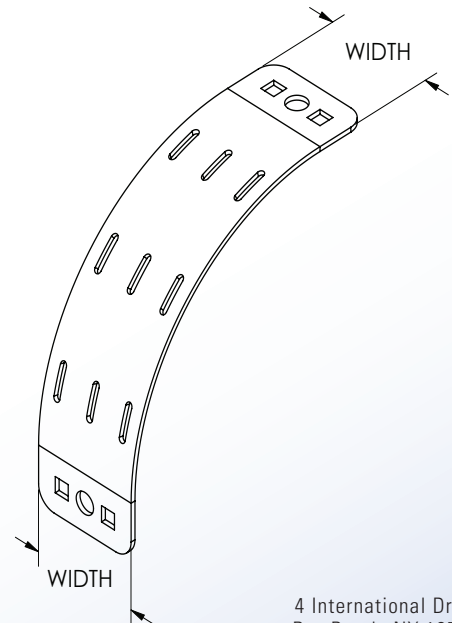
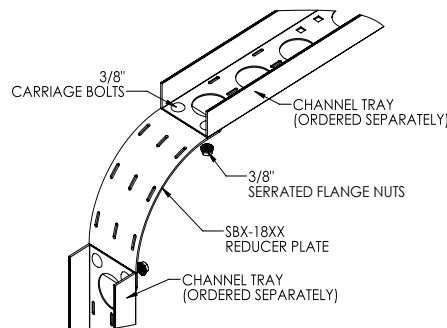
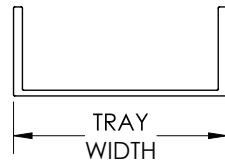
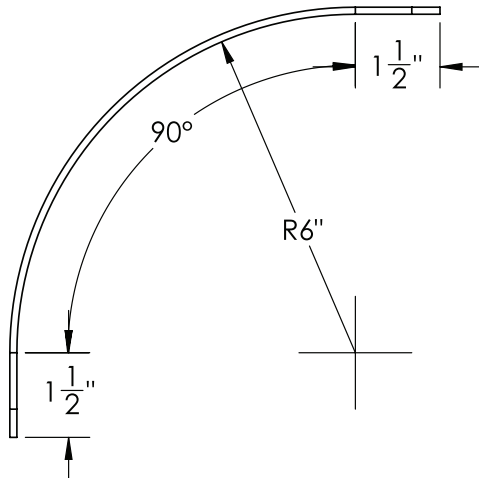

ORDERING DATA EXAMPLE:

SX - XX - 90 VC06

MATERIAL

A = ALUMINUM [100"]
P = PREGLAV STEEL [14GA]
G = HDGAF STEEL [14GA]
SS4 = STAINLESS STEEL 304 [14GA]
SS6 = STAINLESS STEEL 316 [14GA]

CHANNEL WIDTH

03 = 3"
04 = 4"
06 = 6"

FITTING ANGLE 90°BEND

FITTING RADIUS

VERTICAL
CONNECTOR
6" RADIUS

4 International Drive
Rye Brook, NY 10573
Toll Free: 1 888.764.7681
Phone: 914.934.2075
Fax: 914.934.2190
MonoSystems.com



Cable Tray / Channel Tray SBXCOV-0X-1XX

Channel Tray Fittings
Manufactured in the USA by MonoSystems, Inc.



CHANNEL TRAY COVER

Notes

- 1.) Cover can be attached in place by using a
 - SBX-COVCL-0X (cover clip)
 - SBX-903X (cover clamp)
 - SBX-902X (hold down clamp)
 All accessories are ordered separately.
- 2.) Views for reference - do not scale.

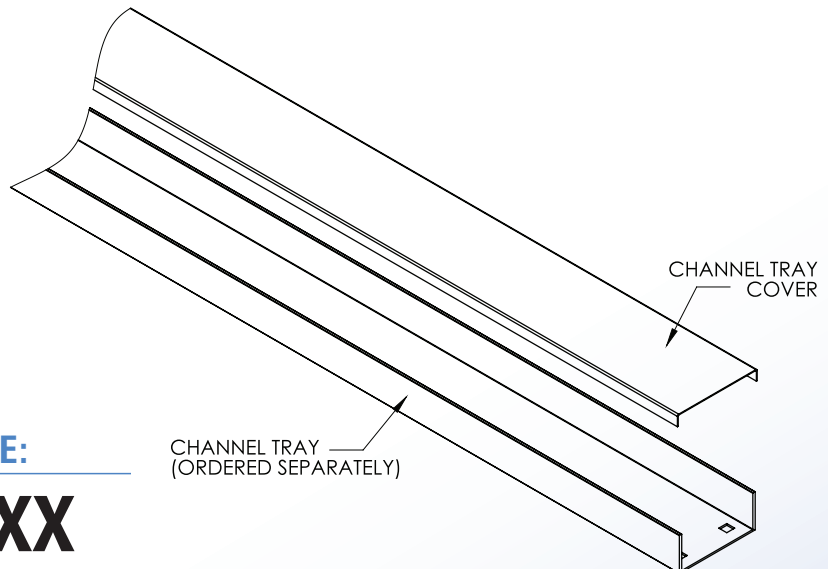
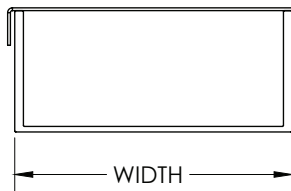
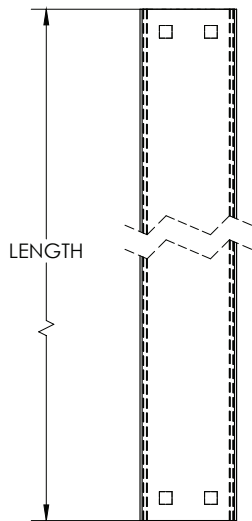

ORDERING DATA EXAMPLE:

SB X COV-0X-1XX

MATERIAL

A = ALUMINUM
P = PREGLAV STEEL
G = HDGAF STEEL
SS4 = STAINLESS STEEL 304
SS6 = STAINLESS STEEL 316

WIDTH

03 = 3" WIDE
04 = 4" WIDE
06 = 6" WIDE

LENGTH

120 = 10ft
144 = 12ft

4 International Drive
Rye Brook, NY 10573
Toll Free: 1 888.764.7681
Phone: 914.934.2075
Fax: 914.934.2190
MonoSystems.com



Cable Tray / Channel Tray

SBXCOV-0X-XCXX

Channel Tray Fittings

Manufactured in the USA by MonoSystems, Inc.



Horizontal Cross Cover, Channel Tray

General Information

1.) Cover can be attached in place by using a

- sbx-covcl-0x (cover clip)
- sbx-903x (cover clamp)
- sbx-902x (hold down clamp)

All accessories are ordered separately.

2.) Views for reference - do not scale.

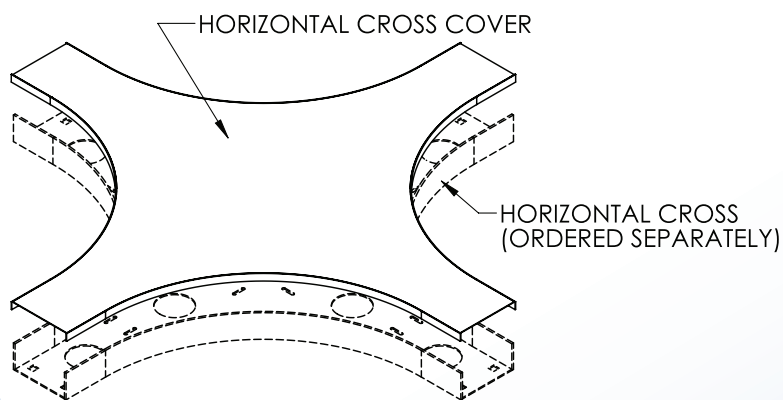
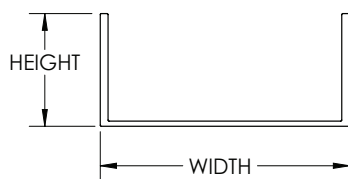
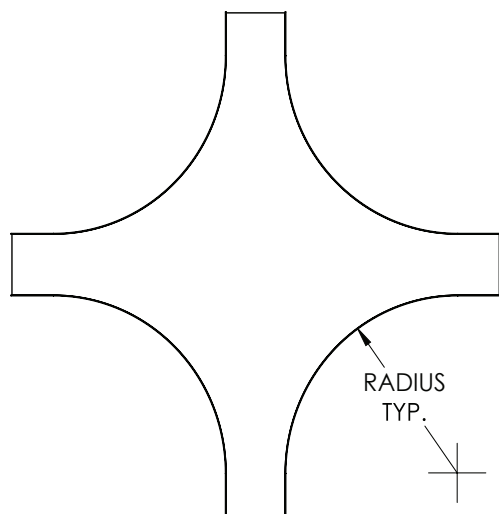

ORDERING DATA EXAMPLE:

SB X COV - 0X - HC XX

MATERIAL

A = ALUMINUM
P = PREGLAV STEEL
G = HDGAF STEEL
SS4 = STAINLESS STEEL 304
SS6 = STAINLESS STEEL 316

WIDTH

03 = 3"
04 = 4"
06 = 6"

RADIUS

12 = 12"
24 = 24"
36 = 36"
48 = 48"

4 International Drive
Rye Brook, NY 10573
Toll Free: 1 888.764.7681
Phone: 914.934.2075
Fax: 914.934.2190
MonoSystems.com



Cable Tray / Channel Tray

SBXCOV-0X-HTXX

Channel Tray Fittings
Manufactured in the USA by MonoSystems, Inc.



Horizontal TeeCover, Channel Tray

General Information

1.) Cover can be attached in place by using a

- SBX-COVCL-0X (cover clip)
- SBX-903X (cover clamp)
- SBX-902X (hold down clamp)

All accessories are ordered separately.

2.) Views for reference - do not scale.

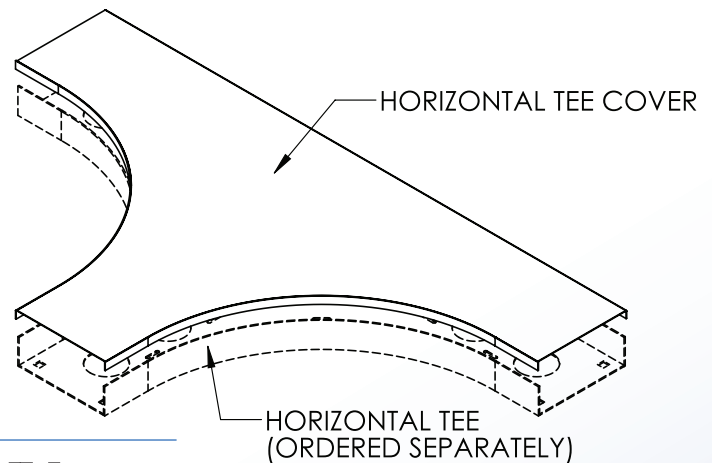
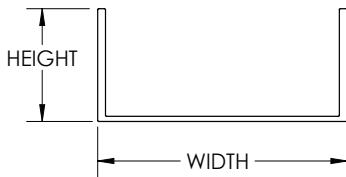
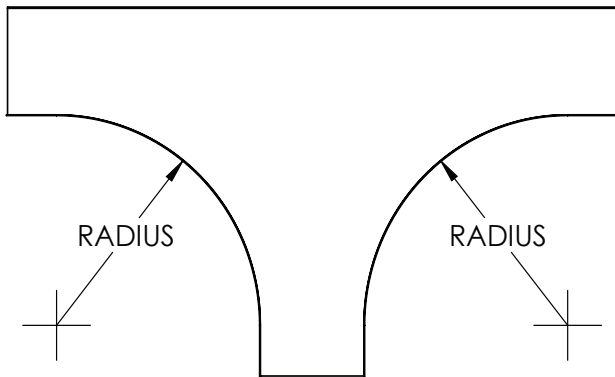

ORDERING DATA EXAMPLE:

SB X COV - 0X - HT XX

MATERIAL

A = ALUMINUM
P = PREGLAV STEEL
G = HDGAF STEEL
SS4 = STAINLESS STEEL 304
SS6 = STAINLESS STEEL 316

WIDTH

03 = 3"
04 = 4"
06 = 6"

RADIUS

12 = 12"
24 = 24"
36 = 36"
48 = 48"

4 International Drive
Rye Brook, NY 10573
Toll Free: 1 888.764.7681
Phone: 914.934.2075
Fax: 914.934.2190
MonoSystems.com



Cable Tray / Channel Tray

SBXCOV-0X-XXHBXX

Channel Tray Fittings
Manufactured in the USA by MonoSystems, Inc.



Horizontal Bend Cover, Channel Tray

General Information

- 1.) Cover can be attached in place by using a
 - SBX-COVCL-0X (cover clip)
 - SBX-903X (cover clamp)
 - SBX-902X (hold down clamp)
 All accessories are ordered separately.
- 2.) Views for reference - do not scale.

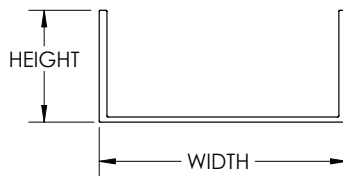
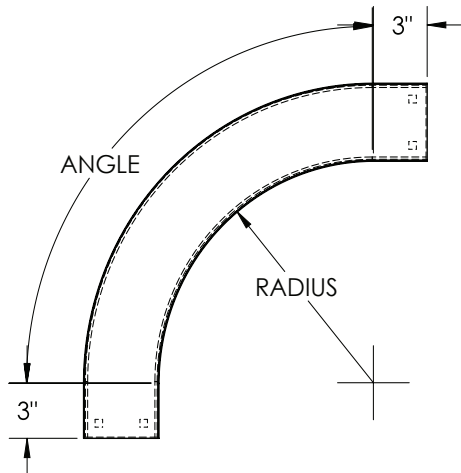

HORIZONTAL BEND COVER

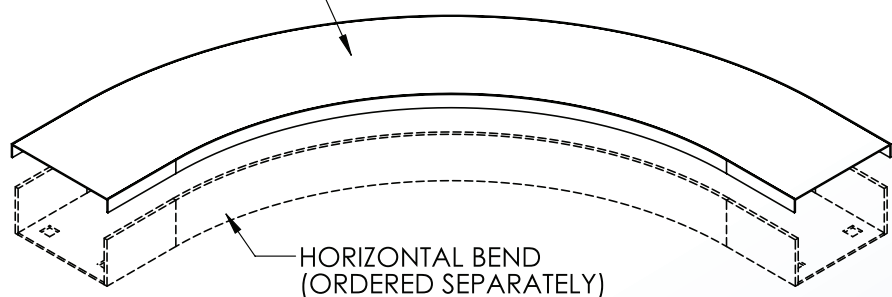

HORIZONTAL BEND
(ORDERED SEPARATELY)

ORDERING DATA EXAMPLE:

SB X COV - 0X - XX HB XX

MATERIAL

A = ALUMINUM
P = PREGLAV STEEL
G = HDGAF STEEL
SS4 = STAINLESS STEEL 304
SS6 = STAINLESS STEEL 316

WIDTH

03 = 3"
04 = 4"
06 = 6"

ANGLE

30 = 30°
45 = 45°
60 = 60°
90 = 90°

RADIUS

12 = 12"
24 = 24"
36 = 36"
48 = 48"

4 International Drive
Rye Brook, NY 10573
Toll Free: 1 888.764.7681
Phone: 914.934.2075
Fax: 914.934.2190
MonoSystems.com



Cable Tray / Channel Tray

SBXCOV-0X-XXIVXX

Channel Tray Fittings
Manufactured in the USA by MonoSystems, Inc.



Inside Vertical Riser Cover, Channel Tray

General Information

- 1.) Cover can be attached in place by using a
 - sbx-covcl-0x (cover clip)
 - sbx-903x (cover clamp)
 - sbx-902x (hold down clamp)
- 2.) Views for reference - do not scale.

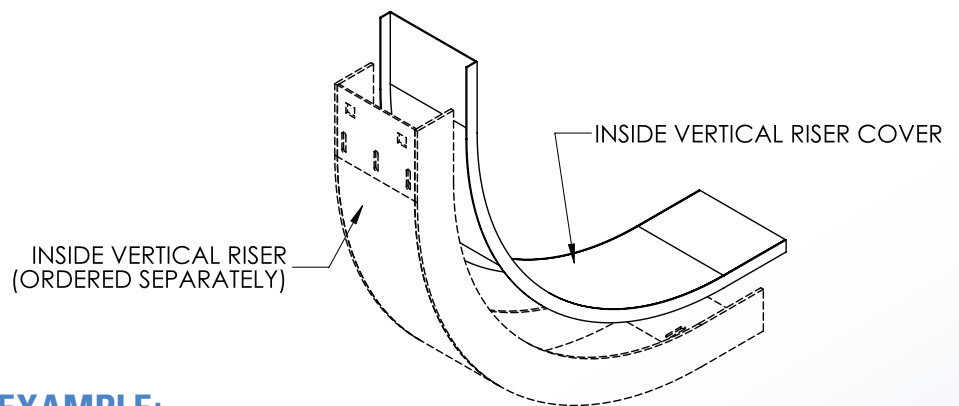
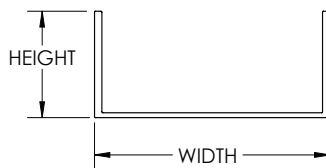
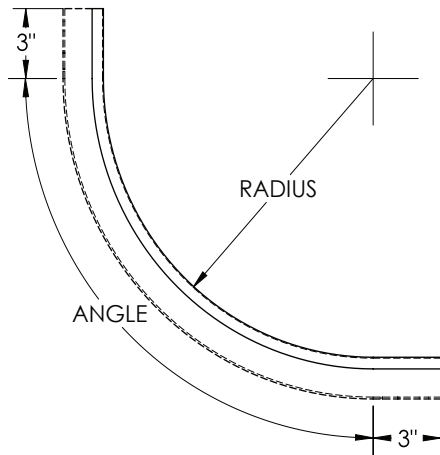

ORDERING DATA EXAMPLE:

SB X COV - 0X - XX IV XX

MATERIAL

A = ALUMINUM
P = PREGLAV STEEL
G = HDGAF STEEL
SS4 = STAINLESS STEEL 304
SS6 = STAINLESS STEEL 316

WIDTH

03 = 3"
04 = 4"
06 = 6"

ANGEL

30 = 30°
45 = 45°
60 = 60°
90 = 90°

RADIUS

12 = 12"
24 = 24"
36 = 36"
48 = 48"

4 International Drive
Rye Brook, NY 10573
Toll Free: 1 888.764.7681
Phone: 914.934.2075
Fax: 914.934.2190
MonoSystems.com



Cable Tray / Channel Tray

SBXCOV-0X-XXOVXX

Channel Tray Fittings
Manufactured in the USA by MonoSystems, Inc.



Outside Vertical Riser Cover, Channel Tray

General Information

1.) Cover can be attached in place by using a

- sbx-covcl-0x (cover clip)
- sbx-903x (cover clamp)
- sbx-902x (hold down clamp)

All accessories are ordered separately

2.) Views for reference - do not scale.

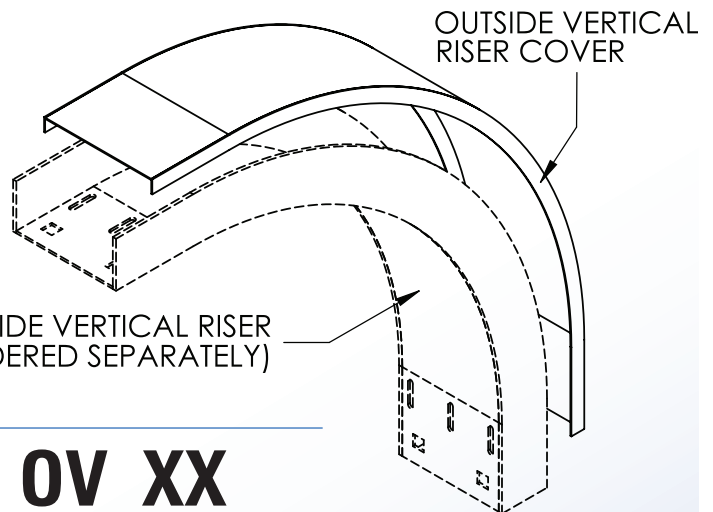
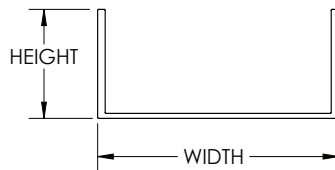
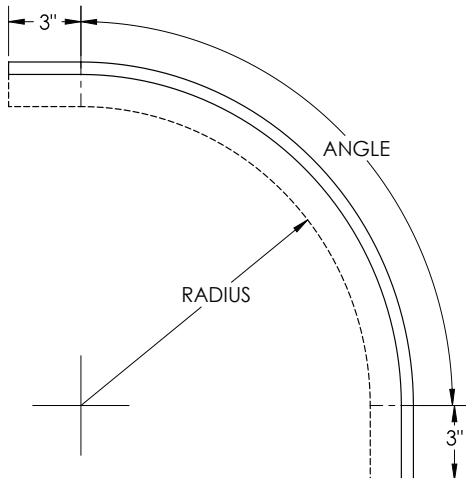

ORDERING DATA EXAMPLE:

SB X COV - 0X - XX OV XX

MATERIAL

A = ALUMINUM
P = PREGLAV STEEL
G = HDGAF STEEL
SS4 = STAINLESS STEEL 304
SS6 = STAINLESS STEEL 316

WIDTH

03 = 3"
04 = 4"
06 = 6"

ANGEL

30 = 30°
45 = 45°
60 = 60°
90 = 90°

RADIUS

12 = 12"
24 = 24"
36 = 36"
48 = 48"

4 International Drive
Rye Brook, NY 10573
Toll Free: 1 888.764.7681
Phone: 914.934.2075
Fax: 914.934.2190
MonoSystems.com



Cable Tray / Channel Tray

SBX-XX-HCXX

Channel Tray Fittings
Manufactured in the USA by MonoSystems, Inc.



Horizontal Cross Fitting - Solid Bottom

General Information

- 1.) Attach fitting to channel tray using splice plates (sbx-104x) and 3/8" mounting hardware. (3) Splice plates included.
- 2.) Recommended torque: for 3/8" fasteners 25-35 ft_lbs [33.9-47.5 N-m].
- 3.) Views for reference - do not scale.

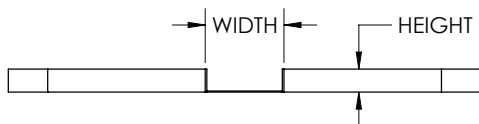
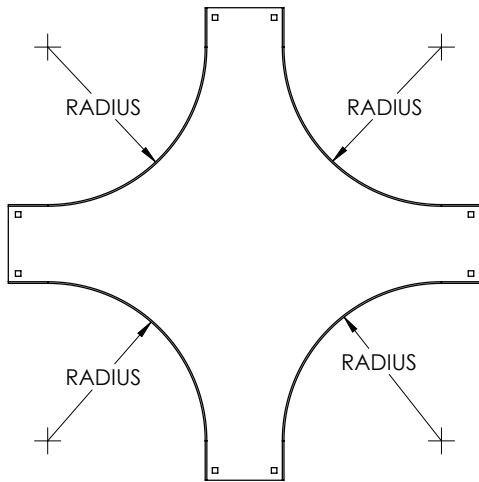

TRAY HEIGHT		TRAY WIDTH	
H		W	
IN.	MM.	IN.	MM.
1.25	32	3	76
1.75	44	4	101
1.75	44	6	152

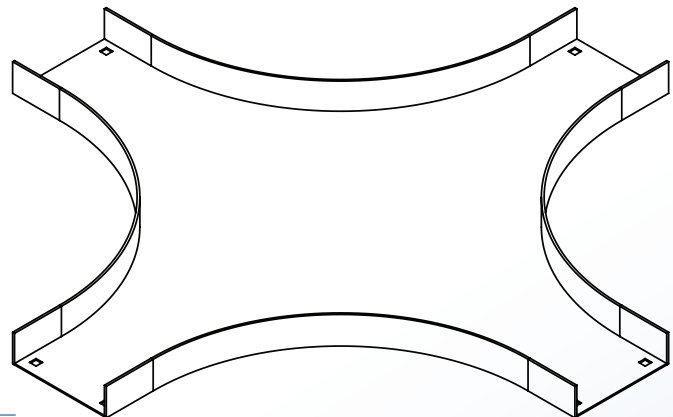

ORDERING DATA EXAMPLE:

SB X - XX - HC XX

STYLE

SOLID
BOTTOM

MATERIAL

A = ALUMINUM
P = PREGLAV STEEL
G = HDGAF STEEL
SS4 = STAINLESS STEEL 304
SS6 = STAINLESS STEEL 316

WIDTH

03 = 3"
04 = 4"
06 = 6"

FITTING TYPE

HC = HORIZONTAL
CROSS

RADIUS

12
24
36
48

4 International Drive
Rye Brook, NY 10573
Toll Free: 1 888.764.7681
Phone: 914.934.2075
Fax: 914.934.2190
MonoSystems.com



Cable Tray / Channel Tray

SVX-03-90HBXX

Channel Tray Fittings
Manufactured in the USA by MonoSystems, Inc.



3" Wide, Vented, 90° Horizontal Bend

General Information

- 1.) Includes (1) splice plate (sbx-1043) and provided 3/8" hardware.
- 2.) Recommended torque: for 3/8" fasteners 25-35 ft-lbs [33.9-47.5 N-m]
- 3.) Views for reference - do not scale.

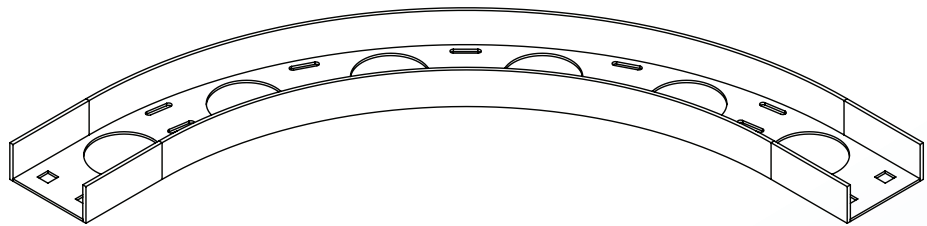
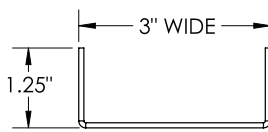
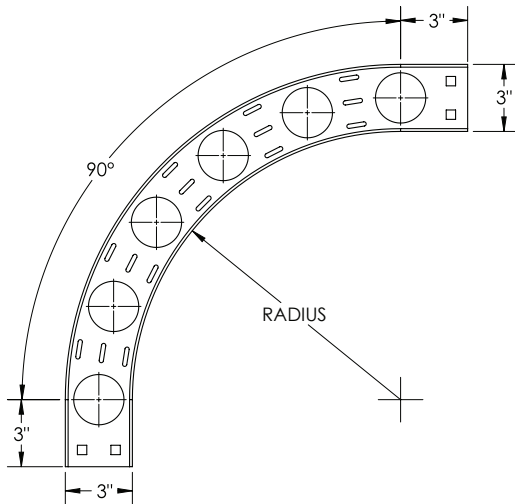

ORDERING DATA EXAMPLE:

PATTERN	MATERIAL	TRAY WIDTH	ANGLE	FITTING TYPE	RADIUS
SV VENTED BOTTOM	X - 04 A = ALUMINUM P = PREGLAV STEEL G = HDGAF STEEL SS4 = STAINLESS STEEL 304 SS6 = STAINLESS STEEL 316	- 03 = 3"	- 90 = 90°	HB = HORIZONTAL BEND	XX 12 24 36 48

4 International Drive
Rye Brook, NY 10573
Toll Free: 1 888.764.7681
Phone: 914.934.2075
Fax: 914.934.2190
MonoSystems.com



Cable Tray / Channel Tray

SVX-06-90HBXX

Channel Tray Fittings
Manufactured in the USA by MonoSystems, Inc.



6" Wide, Vented, 90° Horizontal Bend

General Information

1. Includes (1) splice plate (sbx-1046) and provided 3/8" hardware.
- 2.) Recommended torque: for 3/8" fasteners 25-35 ft-lbs [33.9-47.5 N-m].
- 3.) Views for reference - do not scale.

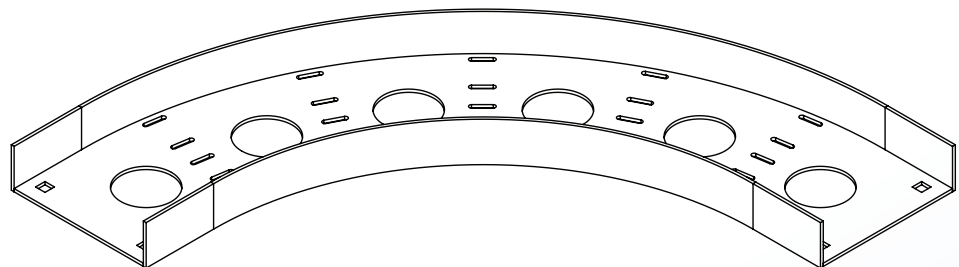
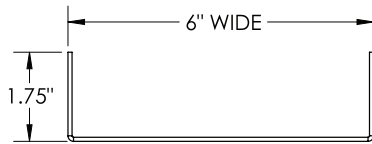
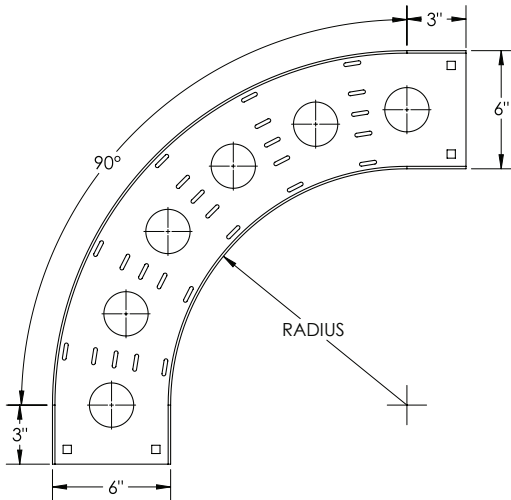

ORDERING DATA EXAMPLE:

SV X - 06 - 90 HB XX

PATTERN

VENTED
BOTTOM

MATERIAL

A = ALUMINUM
P = PREGLAV STEEL
G = HDGAF STEEL
SS4 = STAINLESS STEEL 304
SS6 = STAINLESS STEEL 316

TRAY WIDTH

04 = 6"

ANGLE

90 = 90°

FITTING TYPE

HB = HORIZONTAL
BEND

RADIUS

12
24
36
48

4 International Drive
Rye Brook, NY 10573
Toll Free: 1 888.764.7681
Phone: 914.934.2075
Fax: 914.934.2190
MonoSystems.com



MonoSystems™
Expect. Direct.

Cable Tray / Channel Tray

SBX-XX-HTXX

Channel Tray Fittings
Manufactured in the USA by MonoSystems, Inc.



Horizontal Tee Fitting - Solid Bottom

General Information

- 1.) Attach fitting to channel tray using splice plates (sbx-104x) and 3/8" mounting hardware. (2) Splice plates included.
- 2.) Recommended torque: for 3/8" fasteners 25-35 ft-lbs [33.9-47.5 N-m].
- 3.) Views for reference - do not scale.

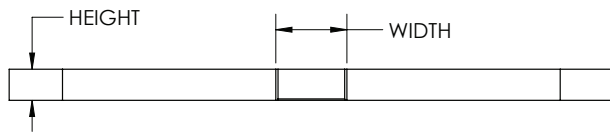
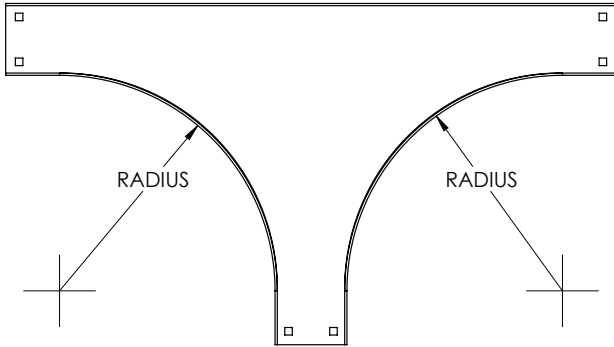

TRAY HEIGHT		TRAY WIDTH	
H		W	
IN.	MM.	IN.	MM.
1.25	32	3	76
1.75	44	4	101
1.75	44	6	152

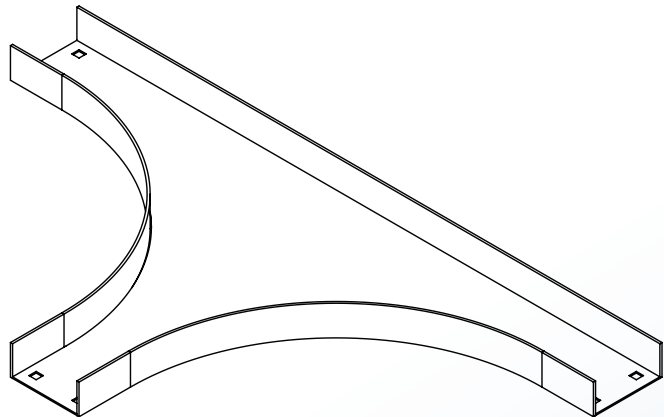

ORDERING DATA EXAMPLE:

SB X - XX - HT XX

STYLE

VENTED
BOTTOM

MATERIAL

A = ALUMINUM
P = PREGLAV STEEL
G = HDGAF STEEL
SS4 = STAINLESS STEEL 304
SS6 = STAINLESS STEEL 316

WIDTH

03 = 3"
04 = 4"
06 = 6"

FITTING TYPE

HT = HORIZONTAL
TEE

RADIUS

12
24
36
48

4 International Drive
Rye Brook, NY 10573
Toll Free: 1 888.764.7681
Phone: 914.934.2075
Fax: 914.934.2190
MonoSystems.com



Cable Tray / Channel Tray

SVX-XX-HCXX

Channel Tray Fittings
Manufactured in the USA by MonoSystems, Inc.



Horizontal Cross Fitting - Vented Bottom

General Information

- 1.) Attach fitting to channel tray using splice plates (sbx-104x) and 3/8" mounting hardware. (3) Splice plates included.
- 2.) Recommended torque: for 3/8" fasteners 25-35 ft-lbs [33.9-47.5 N-m].
- 3.) Views for reference - do not scale.

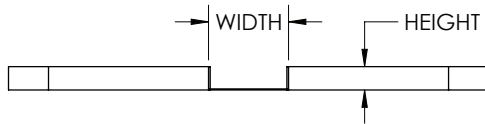
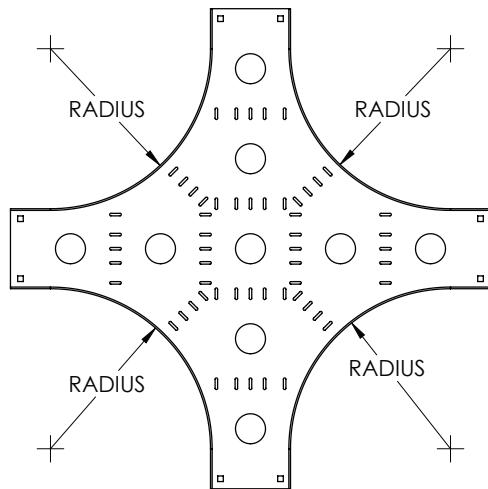

TRAY HEIGHT		TRAY WIDTH	
H		W	
IN.	MM.	IN.	MM.
1.25	32	3	76
1.75	44	4	101
1.75	44	6	152



ORDERING DATA EXAMPLE:

SV X - XX - HC XX

STYLE

MATERIAL

WIDTH

FITTING TYPE

RADIUS

SV = VENTED
BOTTOM

A = ALUMINUM
P = PREGLAV STEEL
G = HDGAF STEEL
SS4 = STAINLESS STEEL 304
SS6 = STAINLESS STEEL 316

03 = 3"
04 = 4"
06 = 6"

HC = HORIZONTAL
CROSS

12
24
36
48

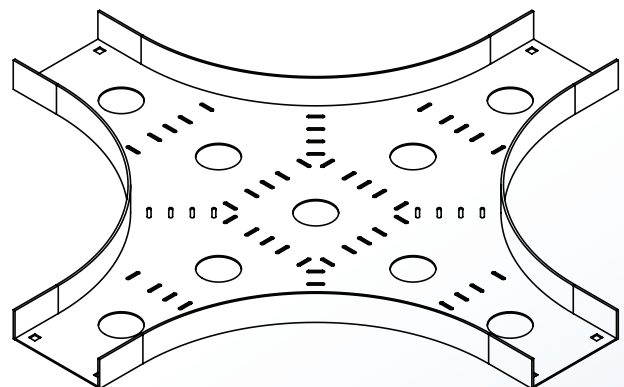

4 International Drive
Rye Brook, NY 10573
Toll Free: 1 888.764.7681
Phone: 914.934.2075
Fax: 914.934.2190
MonoSystems.com



Cable Tray / Channel Tray

SVX-XX-HTXX

Channel Tray Fittings
Manufactured in the USA by MonoSystems, Inc.



Horizontal Tee Fitting - Vented Bottom

General Information

- 1.) Attach fitting to channel tray using splice plates (sbx-104x) and 3/8" mounting hardware. (2) Splice plates included.
- 2.) Recommended torque: for 3/8" fasteners 25-35 ft-lbs [33.9-47.5 N-m].
- 3.) Views for reference - do not scale.

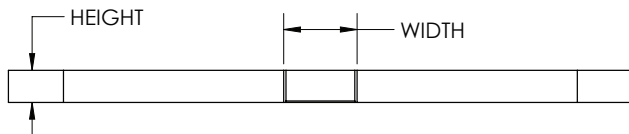
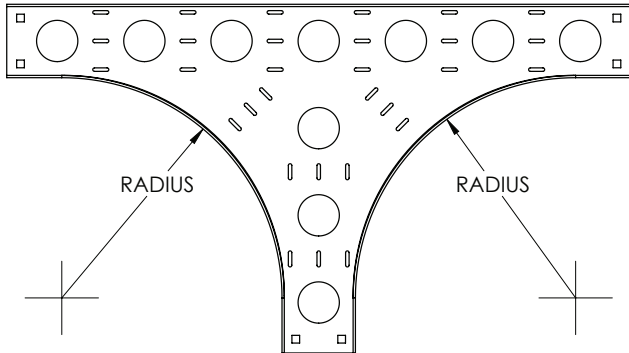

TRAY HEIGHT		TRAY WIDTH	
H		W	
IN.	MM.	IN.	MM.
1.25	32	3	76
1.75	44	4	101
1.75	44	6	152



ORDERING DATA EXAMPLE:

SV X - XX - HT XX

STYLE

MATERIAL

WIDTH

FITTING TYPE

RADIUS

SV = VENTED
BOTTOM

A = ALUMINUM
P = PREGLAV STEEL
G = HDGAF STEEL
SS4 = STAINLESS STEEL 304
SS6 = STAINLESS STEEL 316

03 = 3"
04 = 4"
06 = 6"

HT = HORIZONTAL
TEE

12
24
36
48

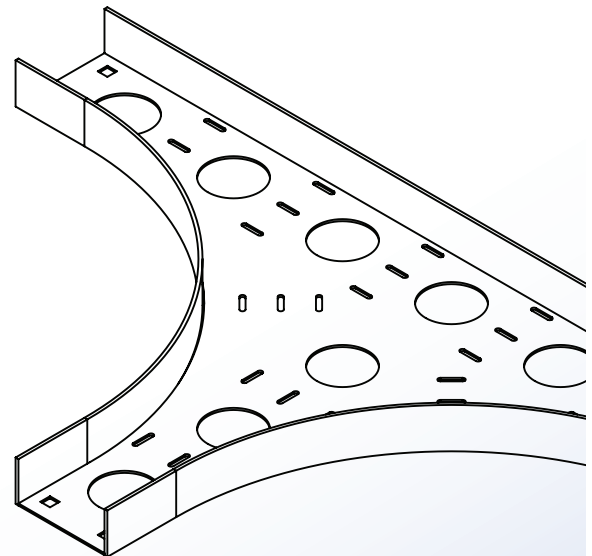

4 International Drive
Rye Brook, NY 10573
Toll Free: 1 888.764.7681
Phone: 914.934.2075
Fax: 914.934.2190
MonoSystems.com



Cable Tray / Channel Tray SBX1XX-DIV-1XX

Channel Tray Fittings
Manufactured in the USA by MonoSystems, Inc.



CHANNEL TRAY STRAIGHT DIVIDER

Notes:

- 1.) Align divider and attach to channel tray using #8 tek screws as shown.
- 2.) Views for reference - Do not scale.

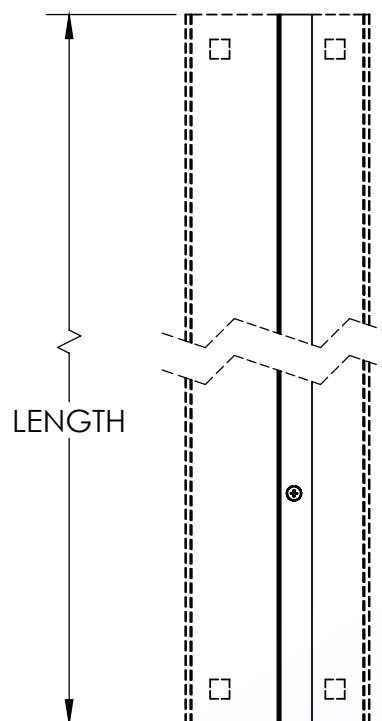
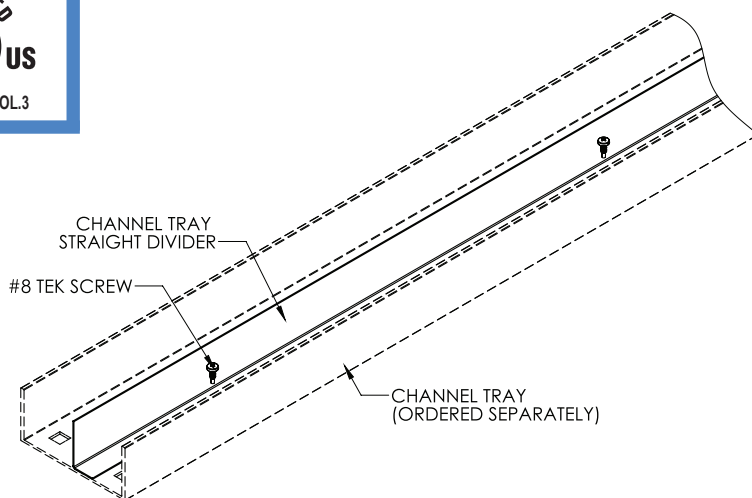
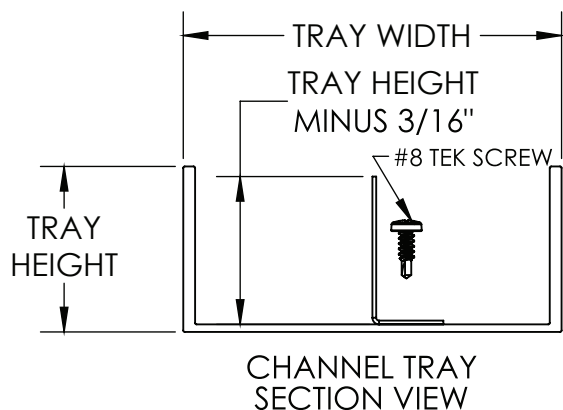

ORDERING DATA EXAMPLE:

SB X 1 XX-DIV-1XX

MATERIAL

A = ALUMINUM
P = PREGLAV STEEL
G = HDGAF STEEL
SS4 = STAINLESS STEEL 304
SS6 = STAINLESS STEEL 316

TRAY HEIGHT

125 = 1.25" HIGH
(3" WIDE)
175 = 1.75" HIGH
(4" WIDE OR 6" WIDE)

LENGTH

120 = 10ft
144 = 12ft

4 International Drive
Rye Brook, NY 10573
Toll Free: 1 888.764.7681
Phone: 914.934.2075
Fax: 914.934.2190
MonoSystems.com



MonoSystems™
Expect. Direct.

Cable Tray / Channel Tray SBX1XX-DIV-XXHB-XXXX

Channel Tray Fittings
Manufactured in the USA by MonoSystems, Inc.



CHANNEL TRAY DIVIDER, HORIZONTAL BEND

Notes:

- 1.) Attach divider to channel tray using #8 tek screws as shown.
- 2.) Views for reference - Do not scale.

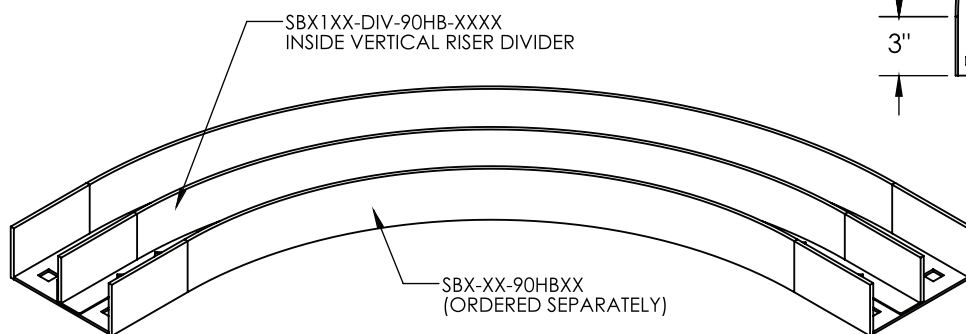
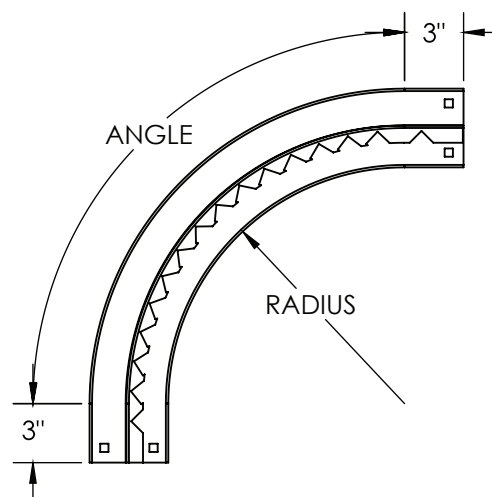
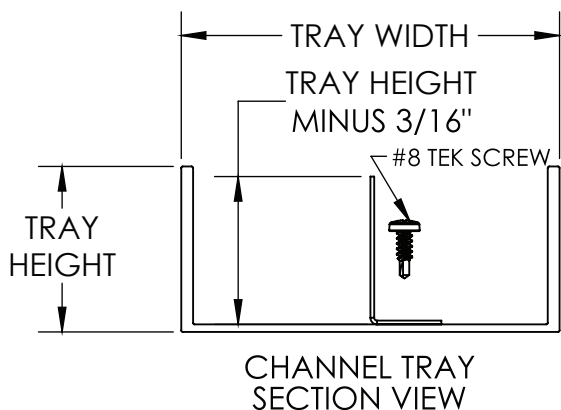

ORDERING DATA EXAMPLE:

SB X 1 XX - DIV - 90 HB - XX XX

MATERIAL

A = ALUMINUM
P = PREGLAV STEEL
G = HDGAF STEEL
SS4 = STAINLESS STEEL 304
SS6 = STAINLESS STEEL 316

TRAY HEIGHT

125 = 1.25" HIGH
(3" WIDE)
175 = 1.75" HIGH
(4" WIDE OR 6" WIDE)

ANGLE

90 = 90°
60 = 60°
45 = 45°
30 = 30°

TYPE

HB = HORIZONTAL
BEND

RADIUS

12 = 12"
24 = 24"
36 = 36"
48 = 48"

WIDTH

03 = 3"
04 = 4"
06 = 6"

4 International Drive
Rye Brook, NY 10573
Toll Free: 1 888.764.7681
Phone: 914.934.2075
Fax: 914.934.2190
MonoSystems.com



MonoSystems™
Expect. Direct.

Cable Tray / Channel Tray SBX1XX-DIV-XXXV-XX

Channel Tray Fittings
Manufactured in the USA by MonoSystems, Inc.



CHANNEL TRAY DIVIDER, OVR / IVR

Notes:

- 1.) Attach divider to channel tray using #8 tek screws as shown.
- 2.) Views for reference - Do not scale.

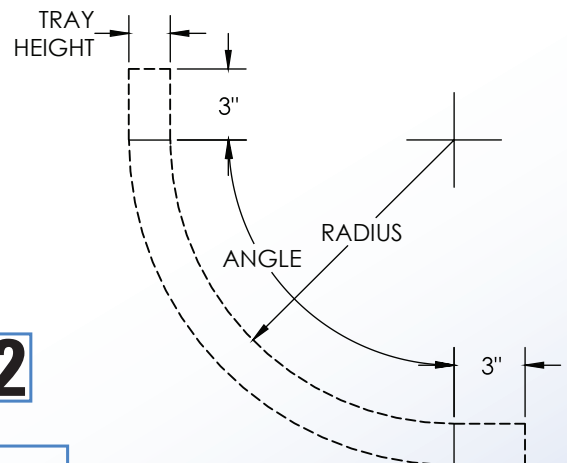
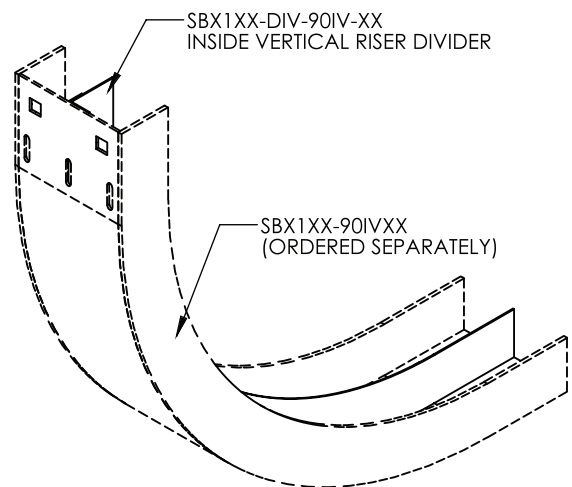
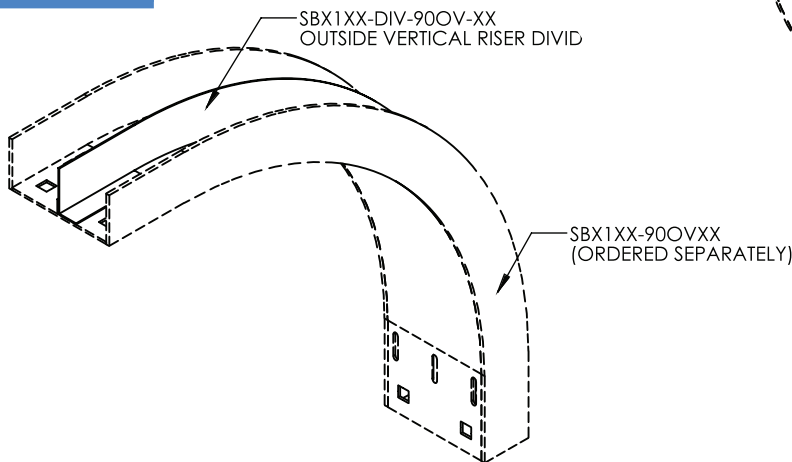
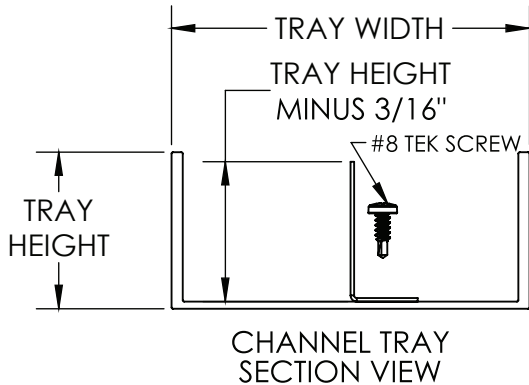

ORDERING DATA EXAMPLE:

SB X 1 XX - DIV - 90 XV - 12

MATERIAL

A = ALUMINUM
P = PREGLAV STEEL
G = HDGAF STEEL
SS4 = STAINLESS STEEL 304
SS6 = STAINLESS STEEL 316

TRAY HEIGHT

125 = 1.25" HIGH
(3" WIDE)
175 = 1.75" HIGH
(4" WIDE OR 6" WIDE)

ANGLE

90 = 90°
60 = 60°
45 = 45°
30 = 30°

TYPE

IV = INSIDE
VERTICAL RISER
OV = OUTSIDE
VERTICAL RISER

RADIUS

12 = 12"
24 = 24"
36 = 36"
48 = 48"

4 International Drive
Rye Brook, NY 10573
Toll Free: 1 888.764.7681
Phone: 914.934.2075
Fax: 914.934.2190
MonoSystems.com



Cable Tray / Channel Tray

SX-XX-90HC060

Channel Tray Accessories

Manufactured in the USA by MonoSystems, Inc.



90° Horizontal Connector

General Information

- 1.) Attach connector to channel tray using provided 3/8" hardware.
- 2.) Recommended torque: for 3/8" fasteners: 25-35 ft-lbs [33.9-47.5 N-m].
- 3.) Views for reference - do not scale.

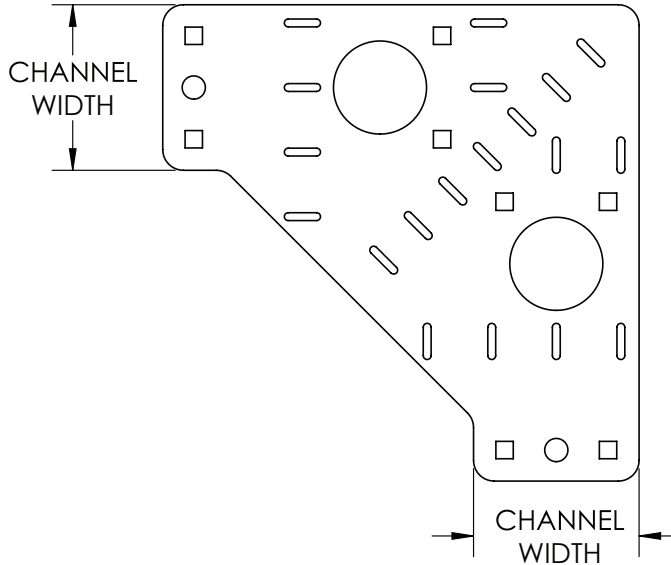

ORDERING DATA EXAMPLE:

S X - XX - 90 HC 060

MATERIAL

WIDTH

WIDTH

FITTING TYPE

A = ALUMINUM
P = PREGLAV STEEL
G = HDGAF STEEL
SS4 = STAINLESS STEEL 304
SS6 = STAINLESS STEEL 316

03 = 3"
04 = 4"
06 = 6"

90°

HC = HORIZONTAL
CONNECTOR

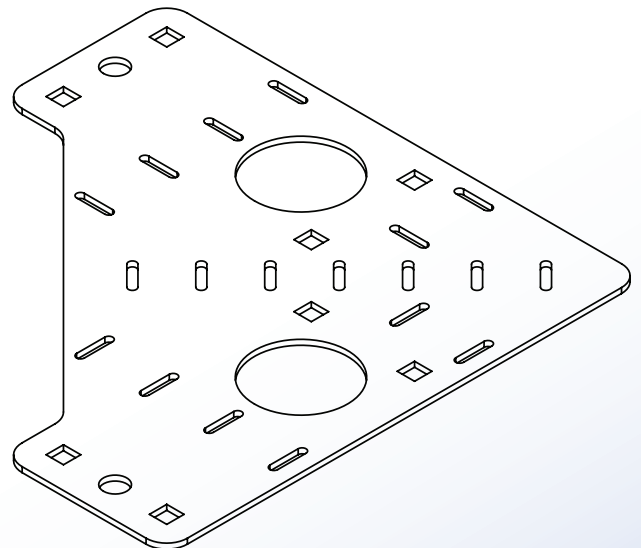

4 International Drive
Rye Brook, NY 10573
Toll Free: 1 888.764.7681
Phone: 914.934.2075
Fax: 914.934.2190
MonoSystems.com



Cable Tray / Channel Tray

SX-XX-90VC00

Channel Tray Accessories

Manufactured in the USA by MonoSystems, Inc.



Vertical Connector

General Information

- 1.) Attach connector to channel tray using provided 3/8" hardware.
- 2.) Recommended torque: for 3/8" fasteners: 25-35 ft-lbs [33.9-47.5 N-m].
- 3.) Views for reference - do not scale.

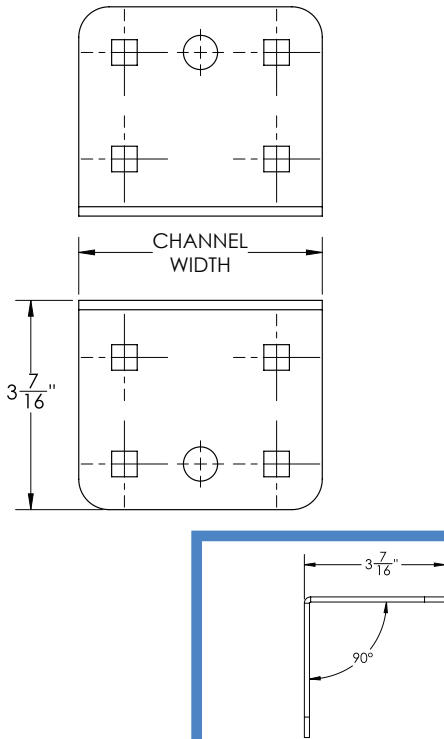

ORDERING DATA EXAMPLE:

SX - XX - 90 VC 00

MATERIAL

CHANNEL WIDTH

ANGLE

FITTING TYPE

A = ALUMINUM
P = PREGLAV STEEL
G = HDGAF STEEL
SS4 = STAINLESS STEEL 304
SS6 = STAINLESS STEEL 316

03 = 3"
04 = 4"
06 = 6"

90 = 90°

VC = 90° VERTICAL
CONNECTOR

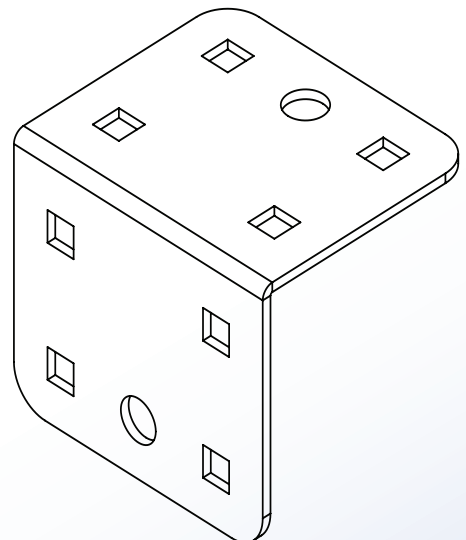

4 International Drive
Rye Brook, NY 10573
Toll Free: 1 888.764.7681
Phone: 914.934.2075
Fax: 914.934.2190
MonoSystems.com



Cable Tray / Channel Tray

SB-COVCL-03

Channel Tray Accessories

Manufactured in the USA by MonoSystems, Inc.



COVER CLIP, 3" WIDE CHANNEL TRAY

Notes

- 1.) **To install:** attach cover clip around channel tray cover and tray assembly. Adjust each end around channel tray bottom until tension holds the clip in place.
To remove: insert a flat head screw driver (or similar) into slot in bottom angled flange and gently pry outward until clip is no longer captured around channel tray base.
- 2.) Clip material: 16ga 301 stainless steel.
- 3.) Ordered as each. For use with any material 3" wide channel tray.
- 4.) Views for reference - do not scale.

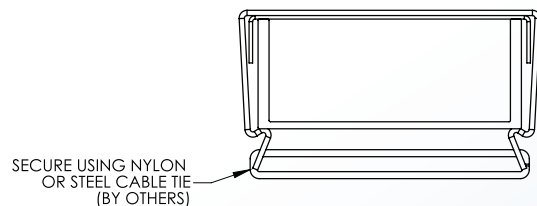
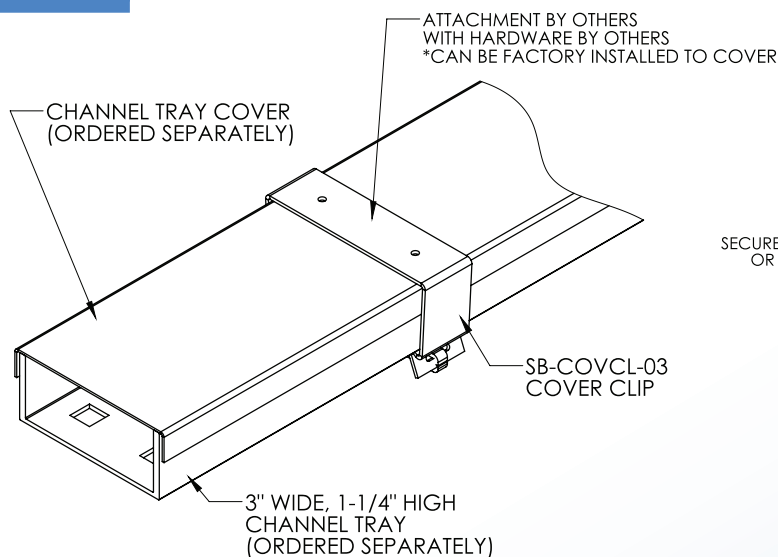
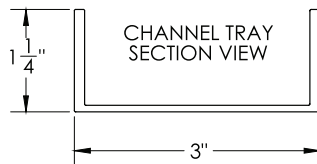
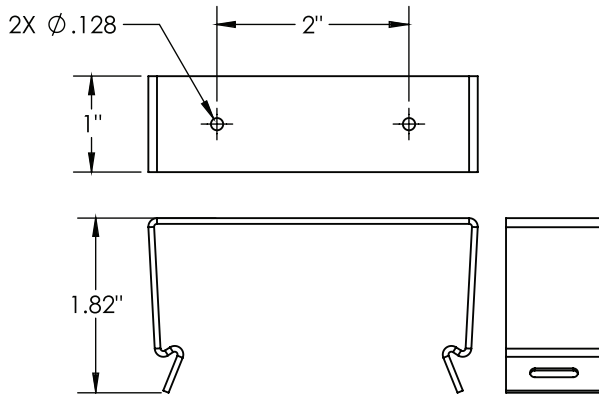

4 International Drive
Rye Brook, NY 10573
Toll Free: 1 888.764.7681
Phone: 914.934.2075
Fax: 914.934.2190
MonoSystems.com



Cable Tray / Channel Tray

SB-COVCL-04

Channel Tray Accessories

Manufactured in the USA by MonoSystems, Inc.



COVER CLIP, 4" WIDE CHANNEL TRAY

Notes

- 1.) **To install:** attach cover clip around channel tray cover and tray assembly. Adjust each end around channel tray bottom until tension holds the clip in place.
To remove: insert a flat head screw driver (or similar) into slot in bottom angled flange and gently pry outward until clip is no longer captured around channel tray base.
- 2.) Clip material: 16ga 301 stainless steel.
- 3.) Ordered as each. for use with any material 4" wide channel tray.
- 4.) Views for reference - do not scale.

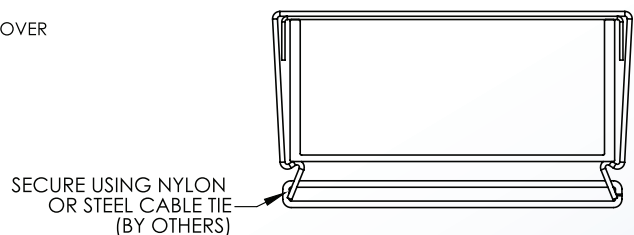
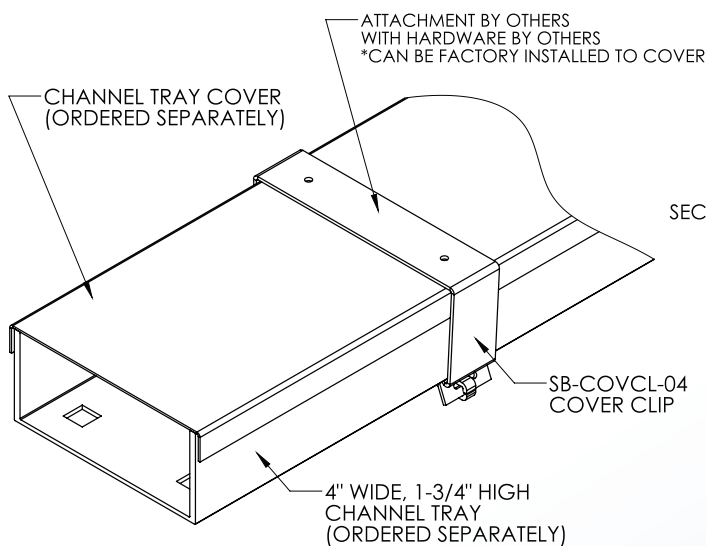
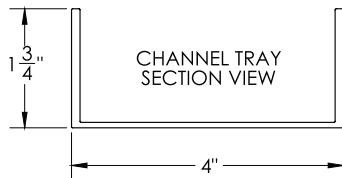
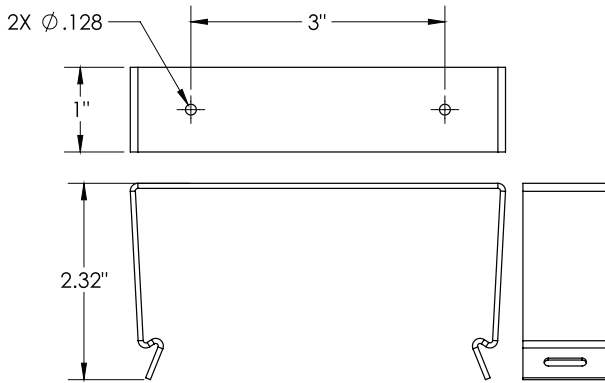

4 International Drive
 Rye Brook, NY 10573
 Toll Free: 1 888.764.7681
 Phone: 914.934.2075
 Fax: 914.934.2190
 MonoSystems.com



Cable Tray / Channel Tray

SB-COVCL-06

Channel Tray Accessories

Manufactured in the USA by MonoSystems, Inc.



COVER CLIP, 6" WIDE CHANNEL TRAY

Notes

- 1.) **To install:** attach cover clip around channel tray cover and tray assembly. Adjust each end around channel tray bottom until tension holds the clip in place.
To remove: insert a flat head screw driver (or similar) into slot in bottom angled flange and gently pry outward until clip is no longer captured around channel tray base.
- 2.) Clip material: 16ga 301 stainless steel.
- 3.) Ordered as each. For use with any material 6" wide channel tray.
- 4.) Views for reference - do not scale.

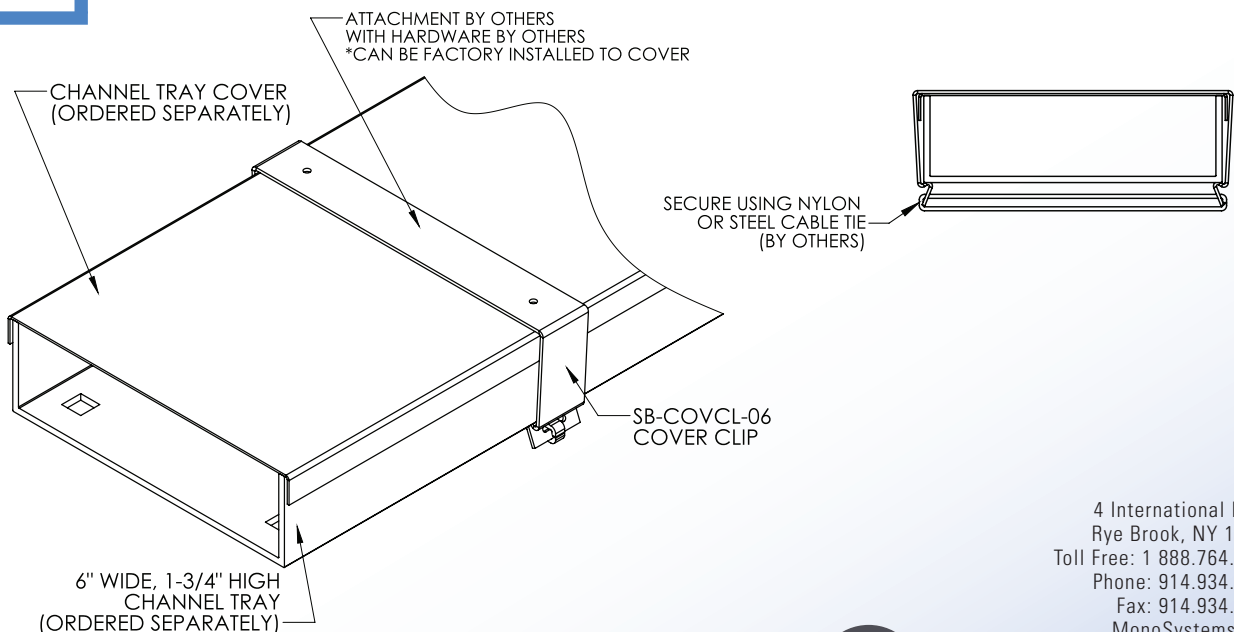
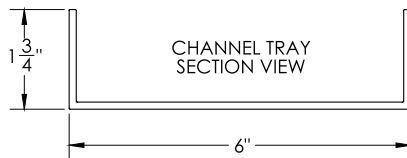
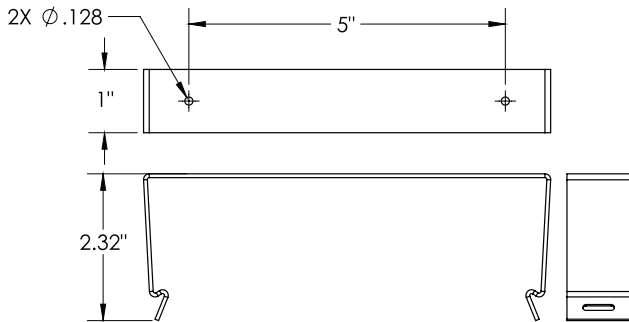

4 International Drive
Rye Brook, NY 10573
Toll Free: 1 888.764.7681
Phone: 914.934.2075
Fax: 914.934.2190
MonoSystems.com



Cable Tray / Channel Tray

SBX-18XX

Channel Tray Accessories

Manufactured in the USA by MonoSystems, Inc.



Reducer Plate, Channel Tray

General Information

- 1.) Attach reducer plate to channel tray using provided 3/8" hardware as shown.
- 2.) Recommended torque: for 3/8" fasteners: 25-35 ft-lbs [33.9-47.5 N-m].
- 3.) Views for reference - do not scale.

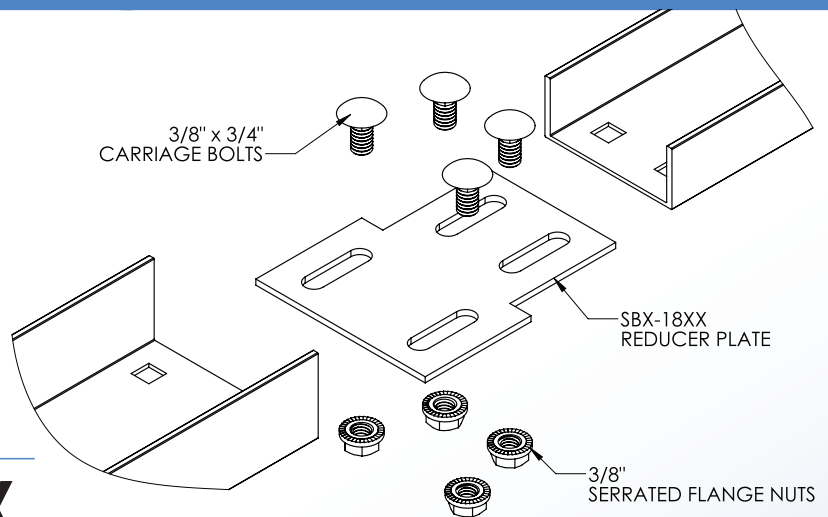
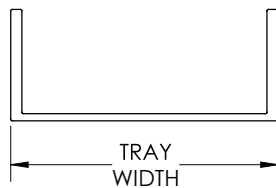
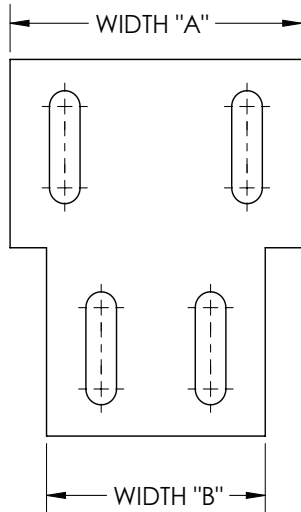

ORDERING DATA EXAMPLE:

SB X - 18 X X

MATERIAL

A = ALUMINUM
P = PREGLAV STEEL
G = HDGAF STEEL
SS4 = STAINLESS STEEL 304
SS6 = STAINLESS STEEL 316

CHANNEL WIDTH "A"

04 = 4"
06 = 6"

CHANNEL WIDTH "B"

03 = 3"
04 = 4"

4 International Drive
Rye Brook, NY 10573
Toll Free: 1 888.764.7681
Phone: 914.934.2075
Fax: 914.934.2190
MonoSystems.com



MonoSystems™
Expect. Direct.

Cable Tray / Channel Tray

SBX-104X

Channel Tray Accessories

Manufactured in the USA by MonoSystems, Inc.



Channel Tray Splice Plate

General Information

- 1.) Attach splice plate to channel tray using provided 3/8" hardware as shown.
- 2.) Recommended torque: for 3/8" fasteners 25-35 ft-lbs [33.9-47.5 N-m].
- 3.) Views for reference - do not scale.

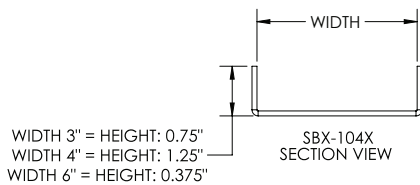
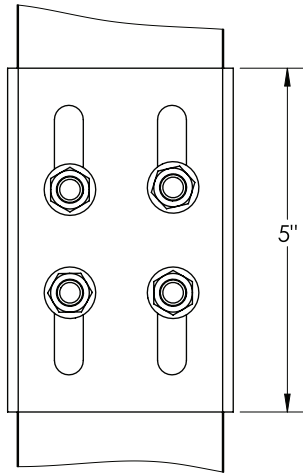

ORDERING DATA EXAMPLE:

SB X - 104 X

MATERIAL

TRAY WIDTH

A = ALUMINUM
P = PREGLAV STEEL
G = HDGAF STEEL
SS4 = STAINLESS STEEL 304
SS6 = STAINLESS STEEL 316

3 = 3"
4 = 4"
6 = 6"

4X 3/8" x 3/4" CARRIAGE BOLTS

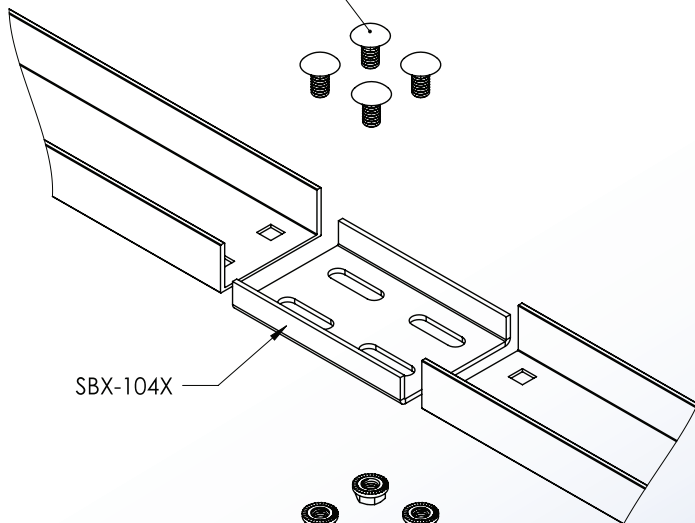

4X 3/8" SERRATED FLANGE NUTS

4 International Drive
Rye Brook, NY 10573
Toll Free: 1 888.764.7681
Phone: 914.934.2075
Fax: 914.934.2190
MonoSystems.com



Cable Tray / Channel Tray

SBX-154X

Channel Tray Accessories

Manufactured in the USA by MonoSystems, Inc.



Channel Tray To Box Connector Bracket

General Information

- 1.) Attach reducer plate to channel tray using provided 3/8" hardware as shown.
- 2.) Recommended torque: for 3/8" fasteners: 25-35 ft-lbs [33.9-47.5 N-m].
- 3.) Views for reference - do not scale.

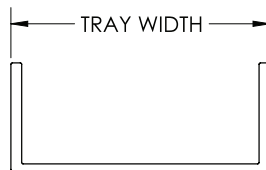
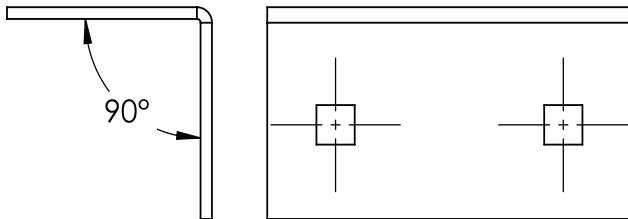

CHANNEL TRAY
(ORDERED SEPARATELY)

SBX-154X
CHANNEL TRAY
TO BOX CONNECTOR

3/8" HARDWARE

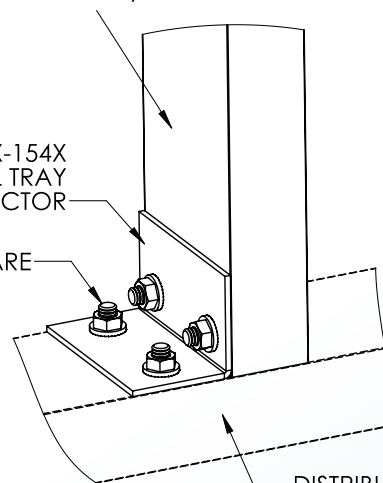

DISTRIBUTION BOX OR
CONTROL CENTER
(BY OTHERS)

ORDERING DATA EXAMPLE:

SB X - 154 - X

MATERIAL

WIDTH

A = ALUMINUM
P = PREGLAV STEEL
G = HDGAF STEEL
SS4 = STAINLESS STEEL 304
SS6 = STAINLESS STEEL 316

03 = 3"
04 = 4"
06 = 6"

4 International Drive
Rye Brook, NY 10573
Toll Free: 1 888.764.7681
Phone: 914.934.2075
Fax: 914.934.2190
MonoSystems.com



Cable Tray / Channel Tray

SBX-158X

Channel Tray Accessories

Manufactured in the USA by MonoSystems, Inc.



End Plate, Channel Tray

General Information

- 1.) Attach end plate to channel tray using provided 3/8" hardware as shown.
- 2.) Recommended torque: for 3/8" fasteners 25-35 ft-lbs [33.9-47.5 N-m].
- 3.) Views for reference - do not scale.

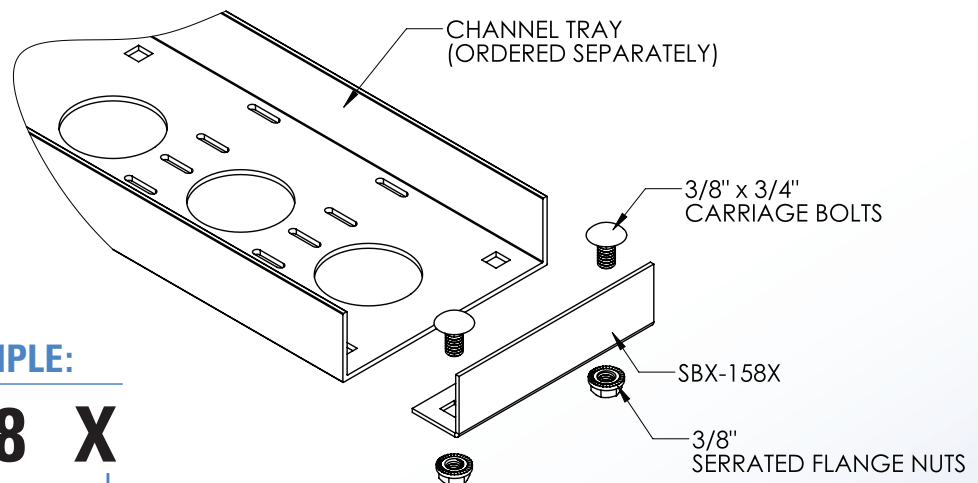
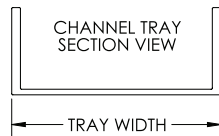
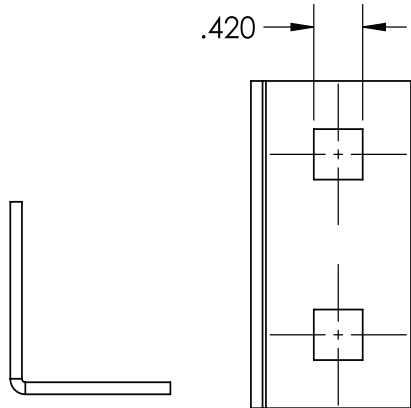

ORDERING DATA EXAMPLE:

SB X - 158 X

MATERIAL

A = ALUMINUM
P = PREGLAV STEEL
G = HDGAF STEEL
SS4 = STAINLESS STEEL 304
SS6 = STAINLESS STEEL 316

WIDTH

03 = 3"
04 = 4"
06 = 6"

4 International Drive
Rye Brook, NY 10573
Toll Free: 1 888.764.7681
Phone: 914.934.2075
Fax: 914.934.2190
MonoSystems.com



Cable Tray / Channel Tray

SBX-164X

Channel Tray Accessories

Manufactured by MonoSystems, Inc.

VERTICAL ADJUSTABLE SPLICE PLATE

Notes:

- 1.) Attach splice plate to channel using provided 3/8" hardware as shown.
- 2.) Recommended Torque: for 3/8" fasteners 25-35 ft-lbs [33.9-47.5 N-M].
- 3.) Views for reference - do not scale.

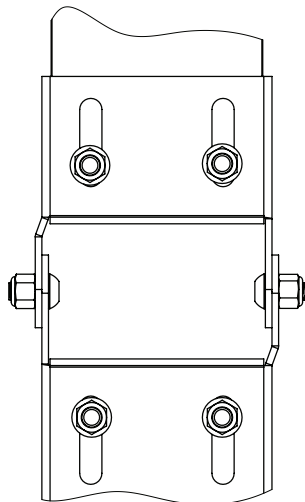
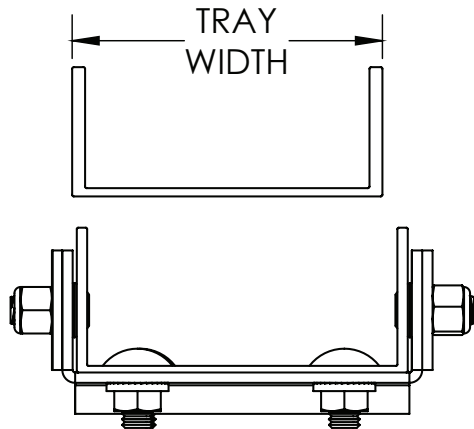

ORDERING DATA EXAMPLE:

SB X - 164 X

MATERIAL

A = ALUMINUM
P = PREGLAV STEEL
G = HDGAF STEEL
SS4 = STAINLESS STEEL 304
SS6 = STAINLESS STEEL 316

WIDTH

3 = 3'
4 = 4'
6 = 6'

MUST BE SUPPORTED WITHIN
24" OF EACH SIDE OF PIVOT
(SUPPORTS BY OTHERS)

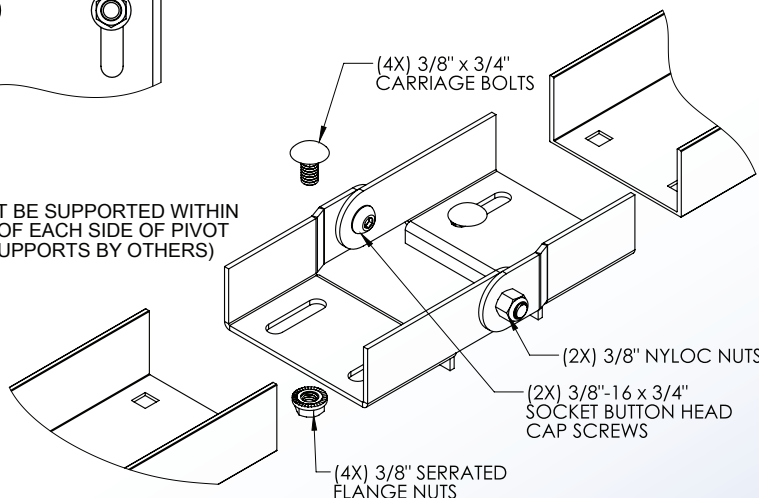

4 International Drive
Rye Brook, NY 10573
Toll Free: 1 888.764.7681
Phone: 914.934.2075
Fax: 914.934.2190
MonoSystems.com



Cable Tray / Channel Tray

SBX-174X

Channel Tray™ Accessories

Manufactured by MonoSystems, Inc.

HORIZONTAL ADJUSTABLE SPLICE PLATE

Notes

- 1.) Includes (1) set of brackets and (4) 3/8-16 x 3/4" carriage bolts, (4) 3/8-16 serrated flange nuts, (2) 3/8-16 nylon lock nuts and (2) 3/8-16 X 3/4" socket button head cap screws.
- 2.) Recommended torque: for 3/8" fasteners 35 ft-lbs [47.5 N-m].
- 3.) Tray must be supported within 12" of each side of pivot (supports by others).
- 4.) Views for reference - do not scale.

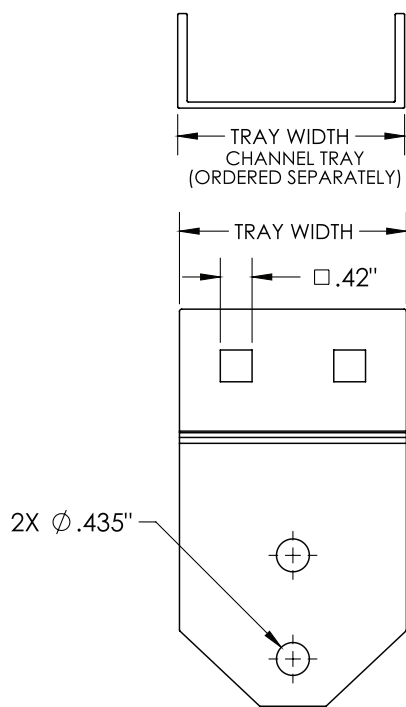

ORDERING DATA EXAMPLE:

SBX-174X

MATERIAL

A = ALUMINUM
P = PRE GALV STEEL
G = HDGAF STEEL
SS4 = STAINLESS STEEL 304
SS6 = STAINLESS STEEL 316

WIDTH

3 = 3"
4 = 4"
6 = 6"



FILE:E80034 Vol.3

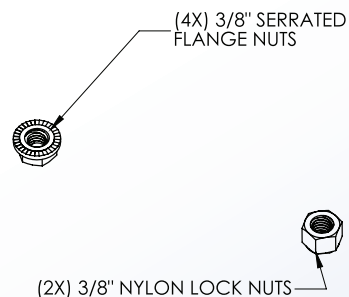
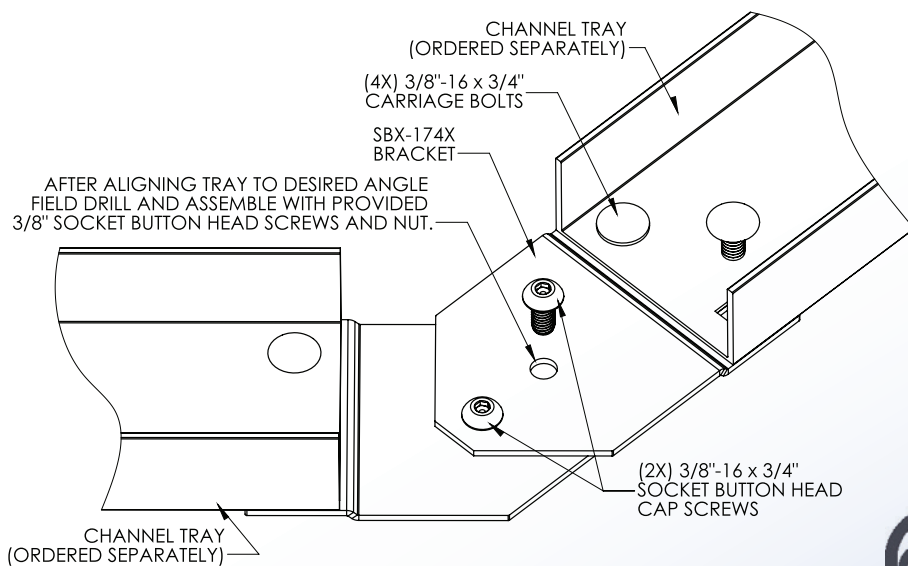
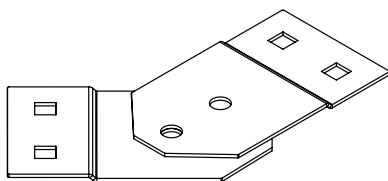

4 International Drive
Rye Brook, NY 10573
Toll Free: 1 888.764.7681
Phone: 914.934.2075
Fax: 914.934.2190
MonoSystems.com



Cable Tray / Channel Tray

SBX-409-X

Channel Tray Accessories

Manufactured in the USA by MonoSystems, Inc.



Channel Tray Strut Bracket

General Information

- 1.) Attach strut bracket using 3/8" hardware (by others).
- 2.) Views for reference - do not scale.

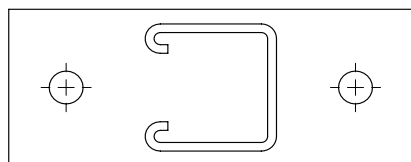
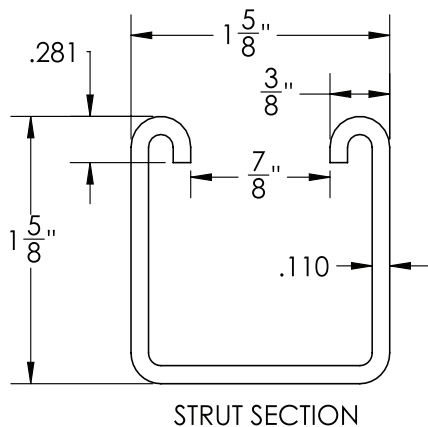

PART NUMBER	UNIFORM LOAD	TRAY WIDTH
SBX-409-6	1920 (lbs)	6
SBX-409-9	1280 (lbs)	9



ORDERING DATA EXAMPLE:

SB X - 409 - X

MATERIAL

LENGTH

P = PREGLAV STEEL
G = HDGAF STEEL

6"
9"

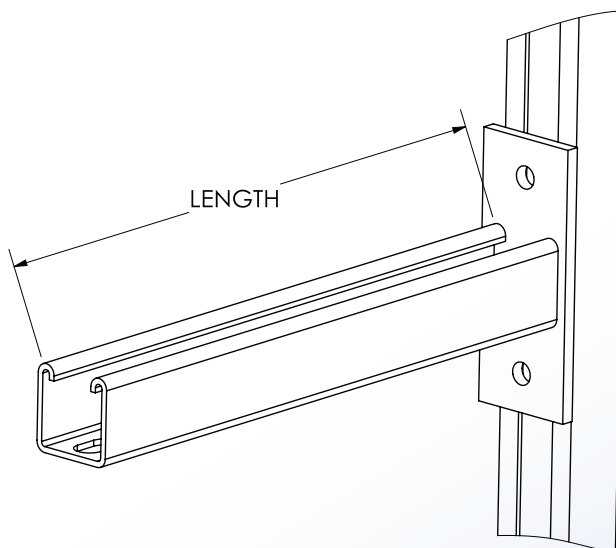

4 International Drive
Rye Brook, NY 10573
Toll Free: 1 888.764.7681
Phone: 914.934.2075
Fax: 914.934.2190
MonoSystems.com



Cable Tray / Channel Tray

SBX-902X

Channel Tray Accessories

Manufactured in the USA by MonoSystems, Inc.



Combination Hold-Down & Cover Clamp

General Information

- 1.) Furnished As One Clamp. 1/4" Mounting Hardware Ordered Separately.
- 2.) Views For Reference - Do Not Scale.

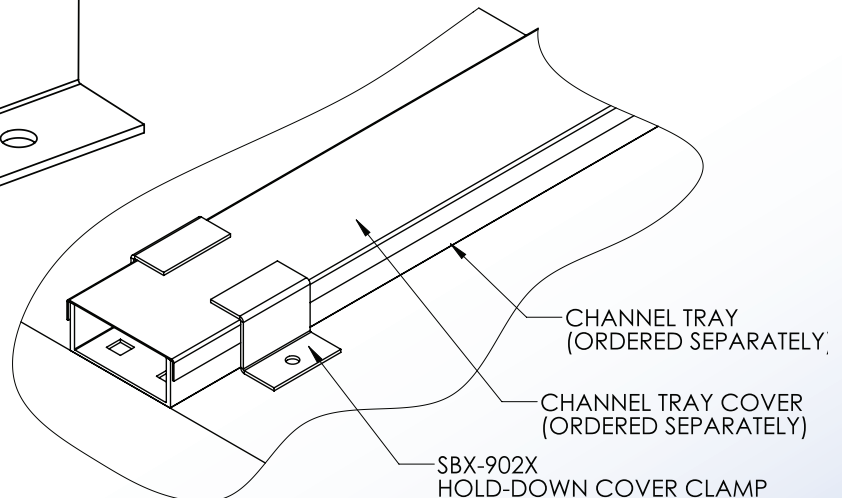
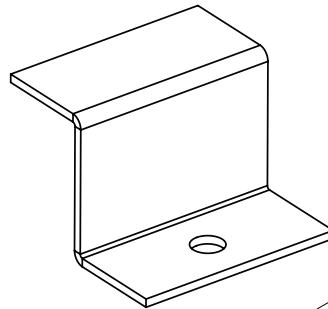
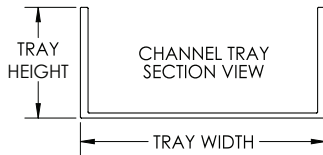
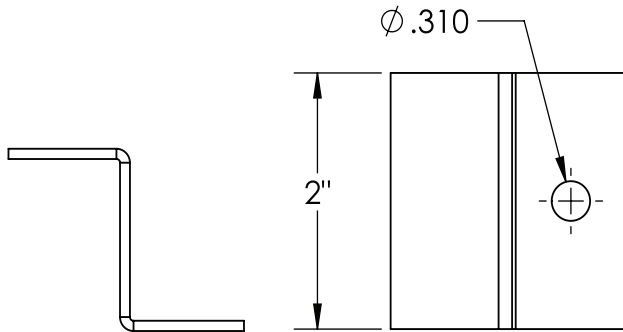

ORDERING DATA EXAMPLE:

SB X - 902 - X

MATERIAL

WIDTH

A = ALUMINUM
P = PREGLAV STEEL
G = HDGAF STEEL
SS4 = STAINLESS STEEL 304
SS6 = STAINLESS STEEL 316

3 = 3"
4 = 4"
6 = 6"

4 International Drive
Rye Brook, NY 10573
Toll Free: 1 888.764.7681
Phone: 914.934.2075
Fax: 914.934.2190
MonoSystems.com



Cable Tray / Channel Tray

SBX-903X

Channel Tray Accessories

Manufactured in the USA by MonoSystems, Inc.



Wrap-Around Cover Clamp, Channel Tray

General information

- 1.) **To install:** place 1 part of cover clamp around channel tray cover and tray assembly. Place 2nd part around opposite end of channel tray, align clamp holes and install hardware.
- 2.) Furnished as one complete clamp with 1/4" hardware.
- 3.) Views for reference - do not scale.

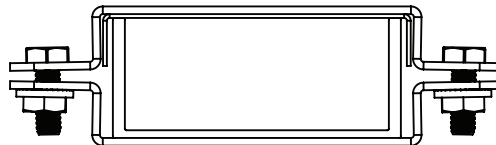
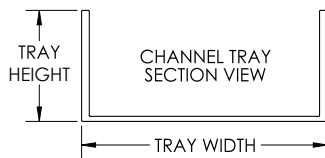
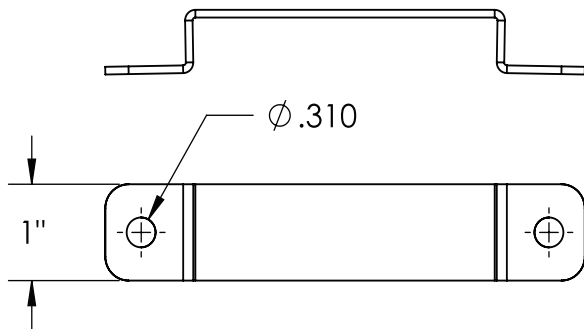

ORDERING DATA EXAMPLE:

SB X - 903 - X

MATERIAL

A = ALUMINUM
P = PREGLAV STEEL
G = HDGAF STEEL
SS4 = STAINLESS STEEL 304
SS6 = STAINLESS STEEL 316

WIDTH

3 = 3"
4 = 4"
6 = 6"

CHANNEL TRAY COVER
(ORDERED SEPARATELY)

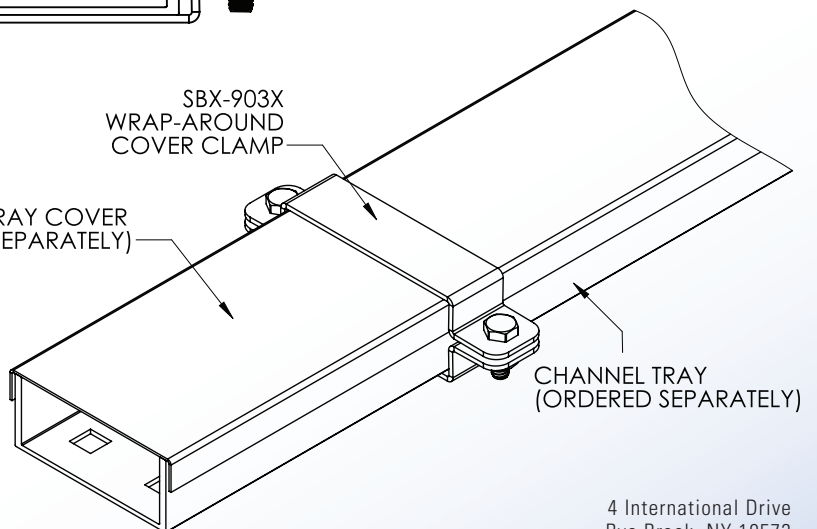

4 International Drive
Rye Brook, NY 10573
Toll Free: 1 888.764.7681
Phone: 914.934.2075
Fax: 914.934.2190
MonoSystems.com



Cable Tray / Channel Tray

SBX-1237-X

Channel Tray Accessories

Manufactured in the USA by MonoSystems, Inc.



Channel To Tray Mounting Bracket

General Information

- 1.) Furnished as one bracket.
- 2.) Attach bracket plate to power tray using 3/8" hardware (by others). Attach bracket plate to channel tray using 3/8" hardware.
- 3.) Recommended torque: for 3/8" fasteners: 25-35 ft-lbs [33.9-47.5 N-m].
- 4.) Views for reference - do not scale.

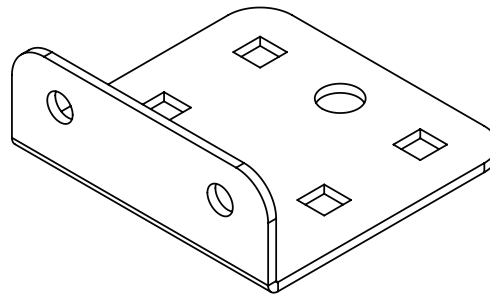
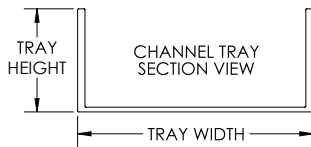
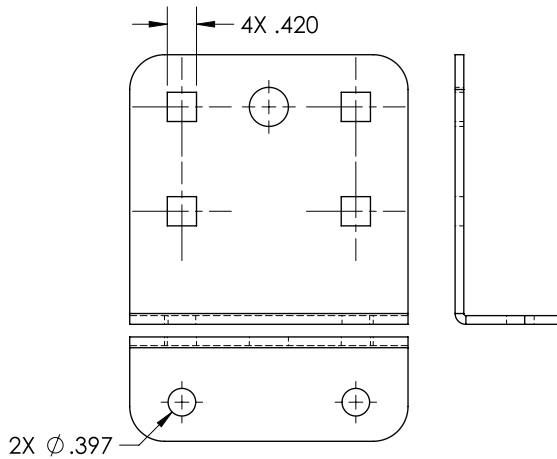

ORDERING DATA EXAMPLE:

SB X - 1237 - X

MATERIAL

A = ALUMINUM
P = PREGLAV STEEL
G = HDGAF STEEL
SS4 = STAINLESS STEEL 304
SS6 = STAINLESS STEEL 316

WIDTH

03 = 3"
04 = 4"
06 = 6"

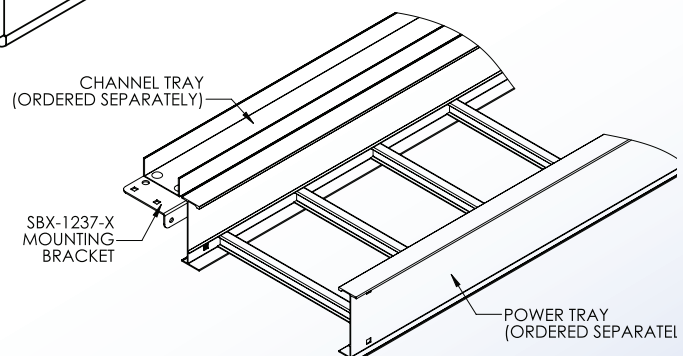

4 International Drive
Rye Brook, NY 10573
Toll Free: 1 888.764.7681
Phone: 914.934.2075
Fax: 914.934.2190
MonoSystems.com



Cable Tray / Channel Tray

SBX-1261-X

Channel Tray Accessories

Manufactured in the USA by MonoSystems, Inc.



Channel To Channel Or Tray Bracket

General Information

- 1.) Attach bracket plate to channel tray using provided 3/8" hardware as shown.
- 2.) Recommended torque: for 3/8" fasteners 25-35 ft-lbs [33.9-47.5 N-m].
- 3.) Views for reference - do not scale.

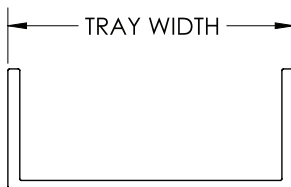
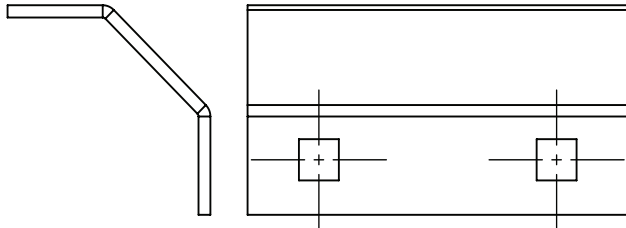

ORDERING DATA EXAMPLE:

SB X - 1261 - X

MATERIAL

TRAY WIDTH

A = ALUMINUM
P = PREGLAV STEEL
G = HDGAF STEEL
SS4 = STAINLESS STEEL 304
SS6 = STAINLESS STEEL 316

03 = 3"
04 = 4"
06 = 6"

ISOMETRIC VIEW
WHEN USED TO CONNECT
CHANNEL TO CHANNEL

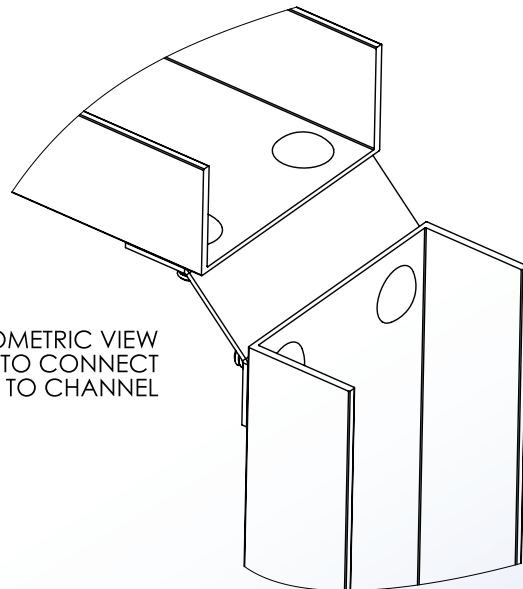

4 International Drive
Rye Brook, NY 10573
Toll Free: 1 888.764.7681
Phone: 914.934.2075
Fax: 914.934.2190
MonoSystems.com



MonoSystems™
Expect. Direct.

Cable Tray / Channel Tray

SBX-3305-X

Channel Tray Accessories

Manufactured in the USA by MonoSystems, Inc.



Channel To Floor Base Plate

General Information

- 1.) Ordered as each. All hardware ordered separately.
- 2.) Views for reference - do not scale.

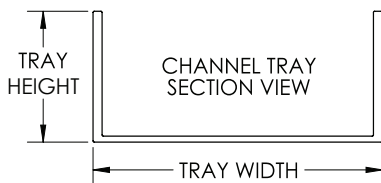
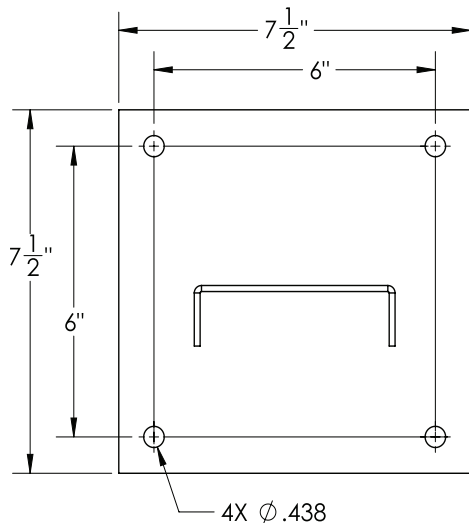

ORDERING DATA EXAMPLE:

SB X - 3305 - X

MATERIAL

WIDTH

A = ALUMINUM
P = PREGLAV STEEL
G = HDGAF STEEL
SS4 = STAINLESS STEEL 304
SS6 = STAINLESS STEEL 316

3 = 3"
4 = 4"
6 = 6"

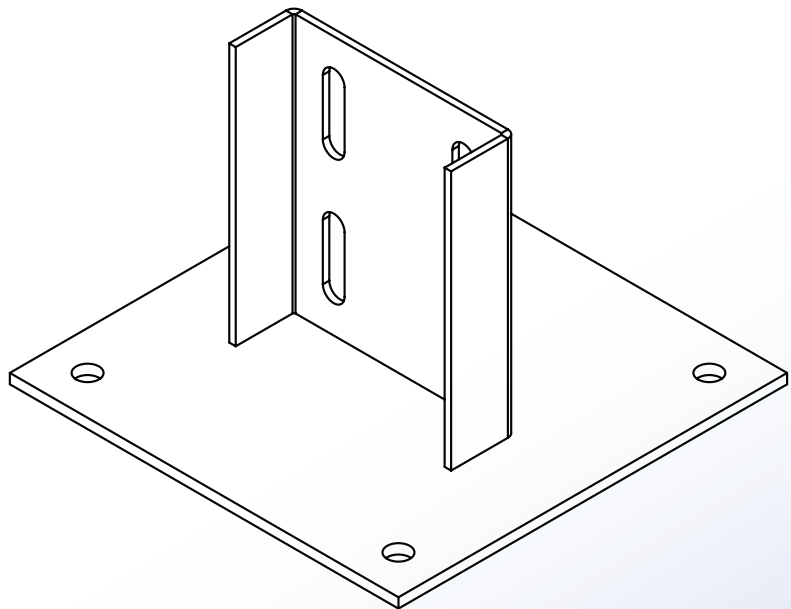

4 International Drive
Rye Brook, NY 10573
Toll Free: 1 888.764.7681
Phone: 914.934.2075
Fax: 914.934.2190
MonoSystems.com



Cable Tray / Channel Tray

SVX-04-90HBXX

Channel Tray Accessories

Manufactured in the USA by MonoSystems, Inc.



4" Wide, Vented, 90° Horizontal Bend

General Information

- 1.) Includes (1) splice plate (sbx-1044) and provided 3/8" hardware.
- 2.) Recommended torque: for 3/8" fasteners 25-35ft-lbs [33.9-47.5 N-m].
- 3.) Views for reference - do not scale.

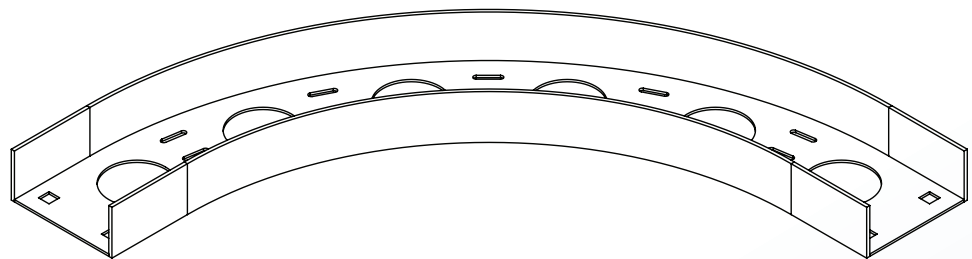
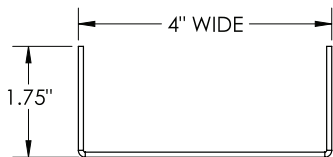
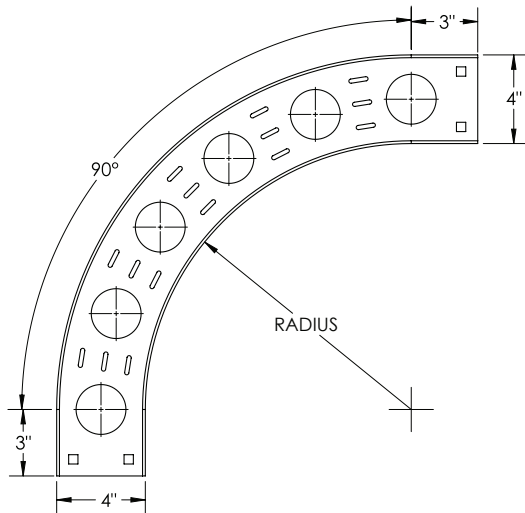

ORDERING DATA EXAMPLE:

SV X - 04 - 90 HB XX

PATTERN

VENTED
BOTTOM

MATERIAL

A = ALUMINUM
P = PREGLAV STEEL
G = HDGAF STEEL
SS4 = STAINLESS STEEL 304
SS6 = STAINLESS STEEL 316

TRAY WIDTH

04 = 4"

ANGLE

90 = 90°

FITTING TYPE

HB = HORIZONTAL
BEND

RADIUS

12
24
36
48

4 International Drive
Rye Brook, NY 10573
Toll Free: 1 888.764.7681
Phone: 914.934.2075
Fax: 914.934.2190
MonoSystems.com



MonoSystems™
Expect. Direct.

Cable Tray / Channel Tray

SVX-1125

Channel Tray Accessories

Manufactured in the USA by MonoSystems, Inc.



Cable Channel Bushing

General Information

The Cable Channel Bushing is a snap-in plastic bushing used to protect cable insulation from mechanical wear

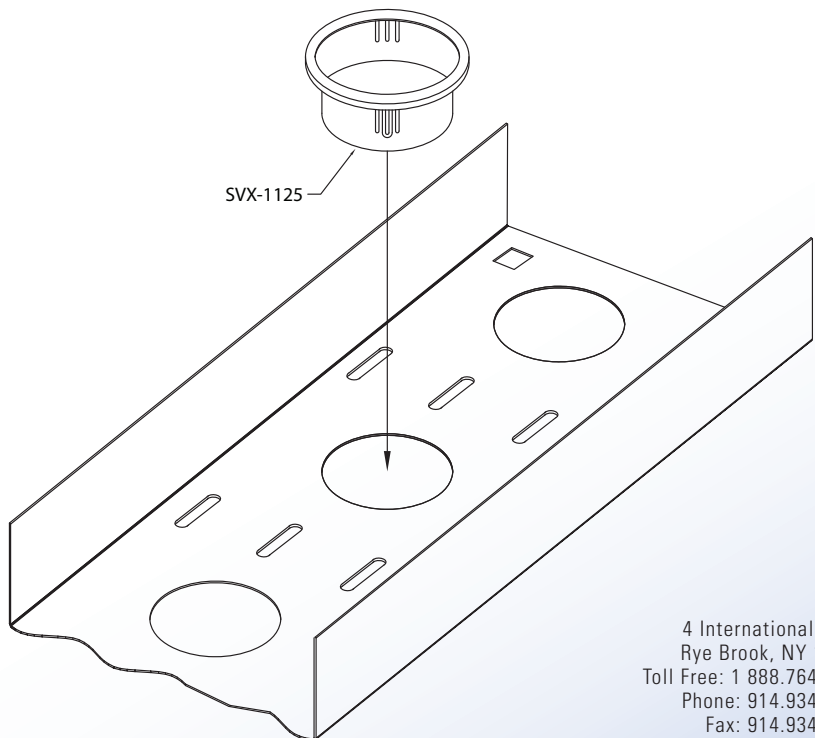
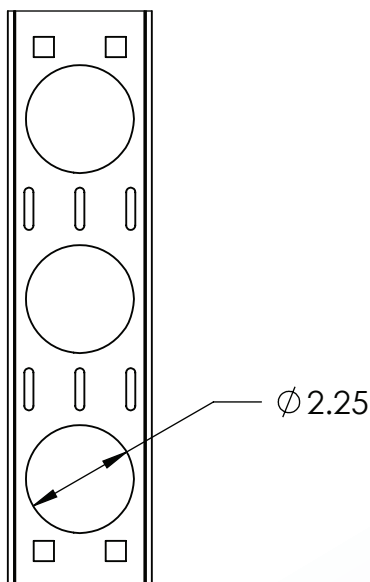
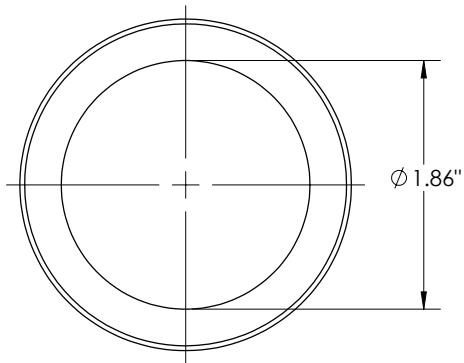

4 International Drive
Rye Brook, NY 10573
Toll Free: 1 888.764.7681
Phone: 914.934.2075
Fax: 914.934.2190
MonoSystems.com



Cable Tray / Channel Tray

SX-XX-HXC060

Channel Tray Accessories

Manufactured in the USA by MonoSystems, Inc.



Horizontal Cross Connector

General Information

- 1.) Attach Connector To Channel Tray Using Channel Provided 3/8" Hardware.
- 2.) Recommended Torque: For 3/8" Fasteners 25-35 Ft-Lbs [33.9-47.5 N-M].
- 3.) Views For Reference - Do Not Scale.

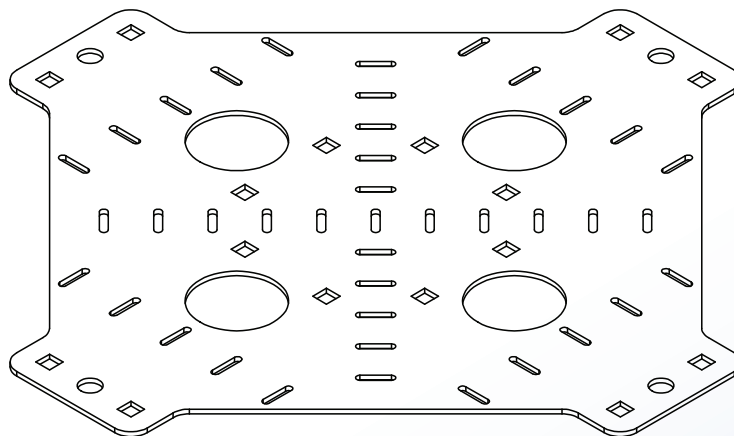
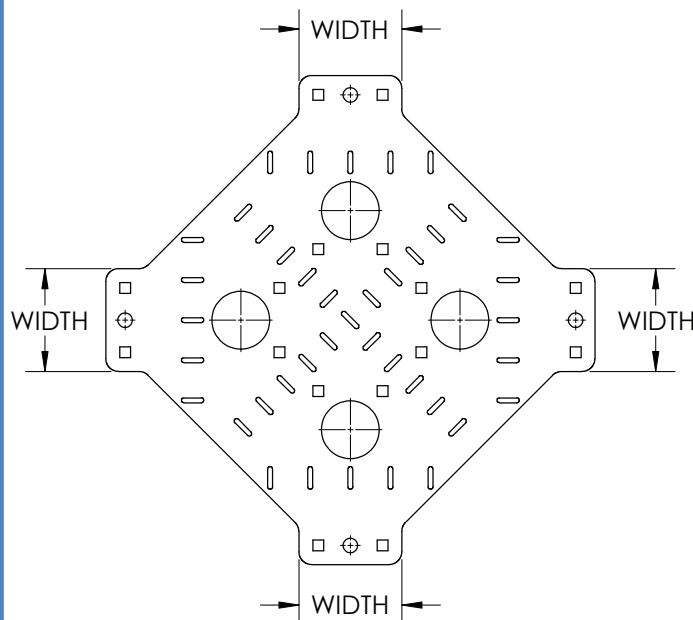

ORDERING DATA EXAMPLE:

S X - XX - HXC 060

MATERIAL

A = ALUMINUM
G = HDGAF STEEL

WIDTH

03 = 3"
04 = 4"
06 = 6"

FITTING TYPE

HXC = HORIZONTAL
CROSS CONNECTOR

4 International Drive
Rye Brook, NY 10573
Toll Free: 1 888.764.7681
Phone: 914.934.2075
Fax: 914.934.2190
MonoSystems.com



Cable Tray / Channel Tray

SX-XX-HTC060

Channel Tray Accessories

Manufactured in the USA by MonoSystems, Inc.



Horizontal Tee Connector

General Information

- 1.) Attach bend to channel tray using (1) supplied splice plate (sbx-104x) and provided 3/8" hardware.
- 2.) Recommended torque: for 3/8" fasteners 25-35 ft-lbs [33.9-47.5 N-m].
- 3.) Views for reference - do not scale.

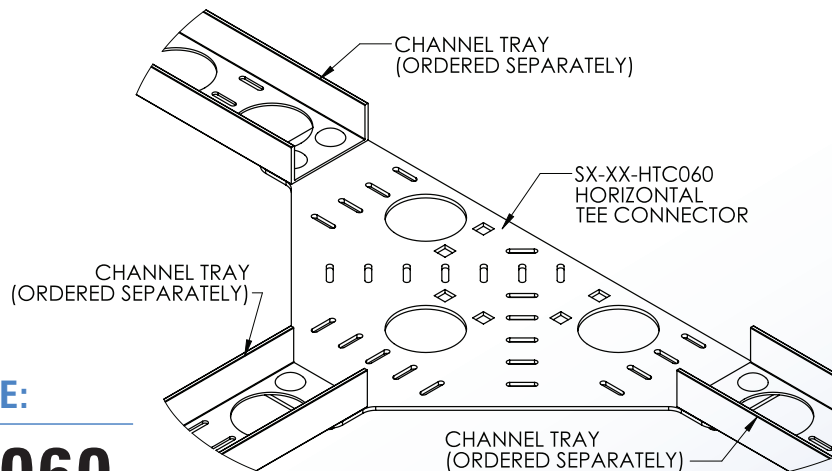
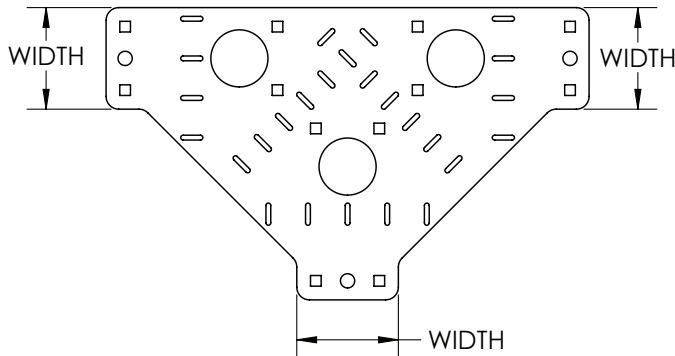

ORDERING DATA EXAMPLE:

SX - XX - HTC 060

MATERIAL

A= ALUMINUM
P= PREGLAV STEEL
G= HDGAF STEEL
SS4= STAINLESS STEEL 304
SS6= STAINLESS STEEL 316

WIDTH

03 = 3"
04 = 4"
06 = 6"

FITTING TYPE

HTC = HORIZONTAL
TEE CONNECTOR

4 International Drive
Rye Brook, NY 10573
Toll Free: 1 888.764.7681
Phone: 914.934.2075
Fax: 914.934.2190
MonoSystems.com



Cable Tray / Channel Tray

SXX1XX-XX-1XX

Channel Tray Accessories

Manufactured in the USA by MonoSystems, Inc.



Channel Tray

General Information

- 1.) All straight sections come with a splice plate (sbx-104x) and 3/8" mounting hardware.
- 2.) Recommended torque: for 3/8" fasteners: 25-35 ft-lbs [33.9-47.5 N-m].
- 3.) Views for reference - do not scale.

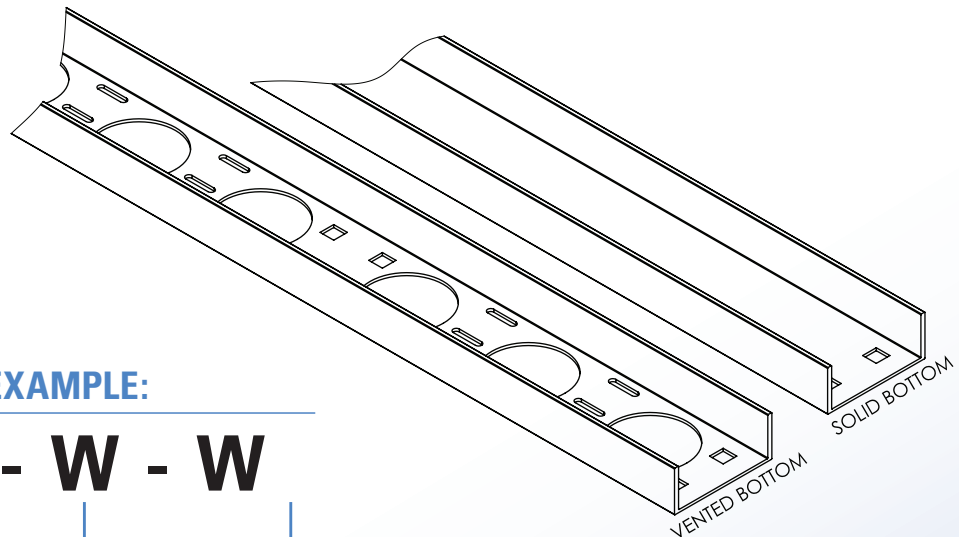
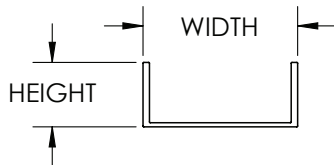
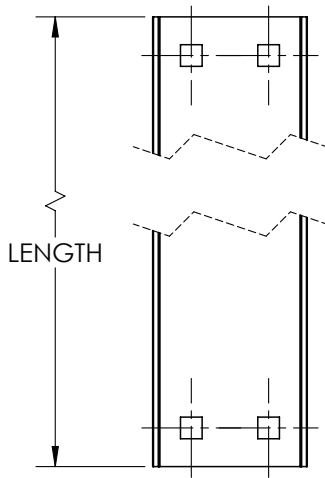

ORDERING DATA EXAMPLE:

S B X H - W - W

PATTERN

MATERIAL

TRAY HEIGHT

TRAY WIDTH

TRAY LENGTH

B = SOLID
BOTTOM
V = VENTED
BOTTOM

A = ALUMINUM
P = PREGLAV STEEL
G = HDGAF STEEL
V SS4 = STAINLESS STEEL 304
SS6 = STAINLESS STEEL 316

125 = 1.25" — 03 = 3"
175 = 1.75" — 04 = 4"
 06 = 6"

120 = 120"
144 = 144"

4 International Drive
Rye Brook, NY 10573
Toll Free: 1 888.764.7681
Phone: 914.934.2075
Fax: 914.934.2190
MonoSystems.com



Cable Tray / Channel Tray 9X-1231-X

Channel Tray Accessories

Manufactured in the USA by MonoSystems, Inc.



CABLE CENTER HANGER, SINGLE CHANNEL

Notes:

- 1.) Furnished as one bracket with positioning clip and clip hardware.
150 lb safety factor. 3.0
- 2.) Attach 1/2" threaded rod to support system above (by others).
Attach cable center hanger to 1/2" threaded rod using 1/2" hardware (by others). Rest channel tray (ordered separately) on center hanger as shown. Move positioning clip against channel tray and tighten hardware to hold in place.
- 3.) Views for reference - do not scale.

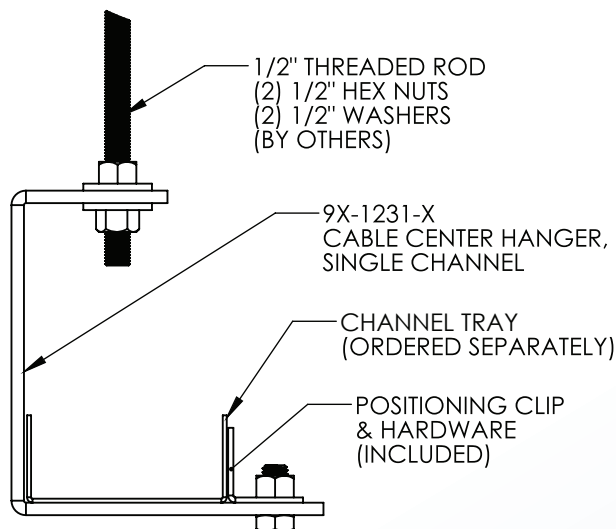
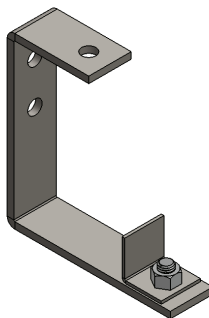
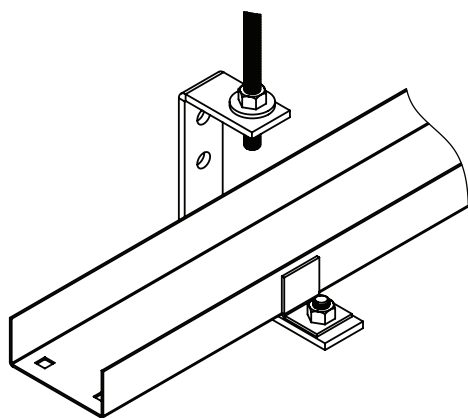

ORDERING DATA EXAMPLE:

9 X - 1231 - X

HANGER MATERIAL

P = PREGLAV STEEL
G = HDGAF STEEL

CHANNEL TRAY WIDTH

3 = 3"
4 = 4"
6 = 6"

4 International Drive
Rye Brook, NY 10573
Toll Free: 1 888.764.7681
Phone: 914.934.2075
Fax: 914.934.2190
MonoSystems.com



MonoSystems™
Expect. Direct.

Cable Tray / Channel Tray 9X-1232-X

Channel Tray Accessories

Manufactured in the USA by MonoSystems, Inc.



CABLE CENTER HANGER, DOUBLE CHANNEL

Notes:

- 1.) Furnished as one bracket. 265 lb safety factor. 3.0
- 2.) Attach 1/2" threaded rod to support system above (by others). Attach cable center hanger to 1/2" threaded rod using 1/2" hardware (by others). Rest channel tray (ordered separately) on center hanger as shown.
- 3.) Views for reference - do not scale.

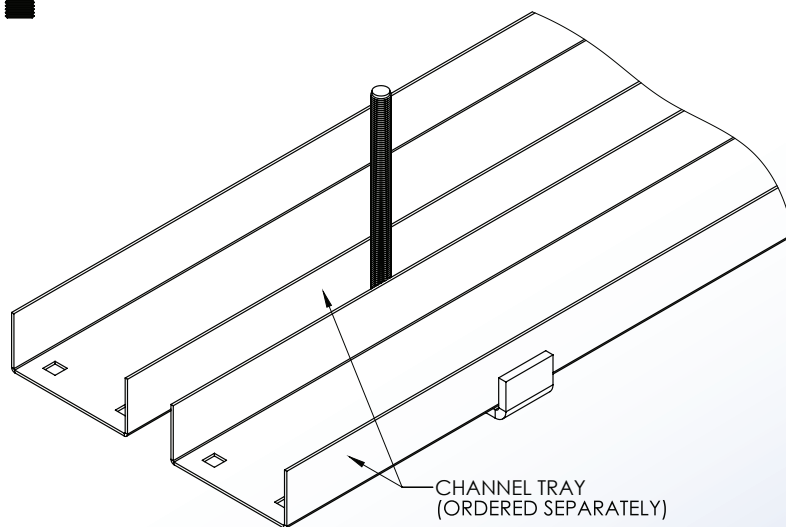
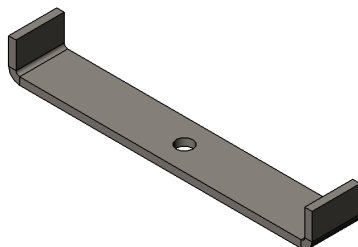
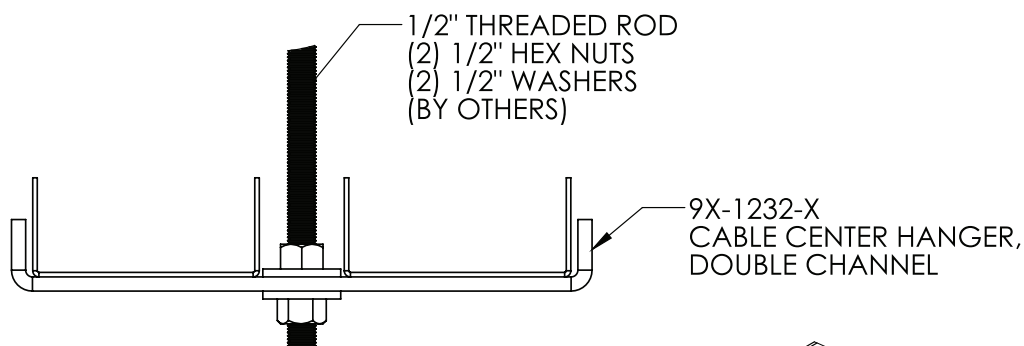

ORDERING DATA EXAMPLE:

9 X - 1232 - X

HANGER MATERIAL

P = PREGLAV STEEL
G = HDGAF STEEL

CHANNEL TRAY WIDTH

3 = 3"
4 = 4"
6 = 6"

4 International Drive
Rye Brook, NY 10573
Toll Free: 1 888.764.7681
Phone: 914.934.2075
Fax: 914.934.2190
MonoSystems.com



Cable Tray / Channel Tray SBX-B185CCL

Channel Tray Accessories
Manufactured in the USA by MonoSystems, Inc.



CHANNEL TRAY WALL BRACKET

Notes:

- 1.) Attach bracket to surface using 1/2" hardware (by others).
- 2.) Uniform load: 225 lbs [1.00Kn] safety factor of 2.5
- 3.) Views for reference - do not scale.

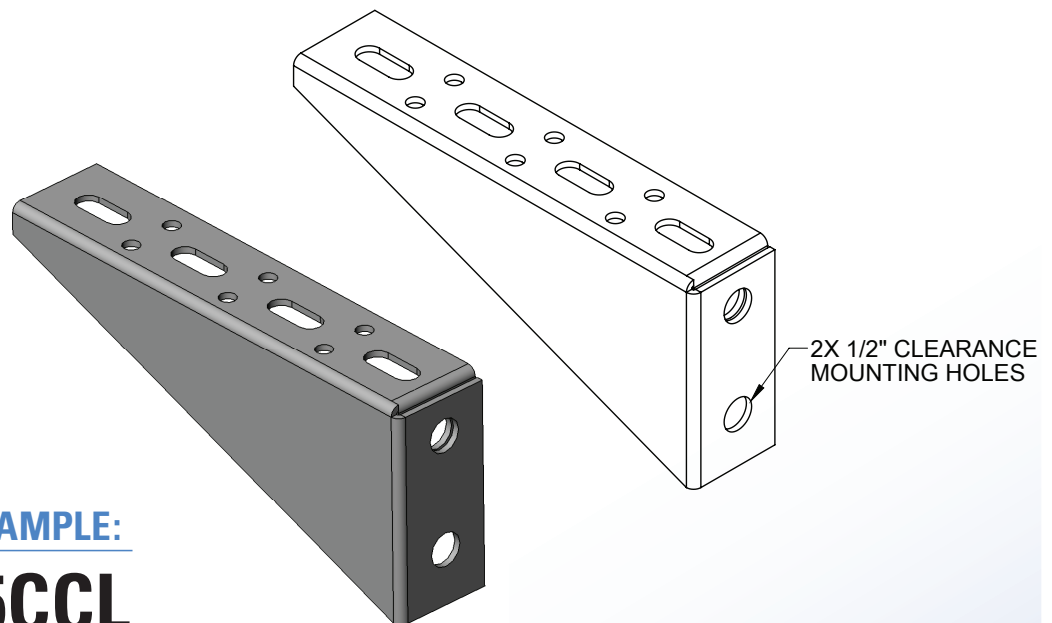
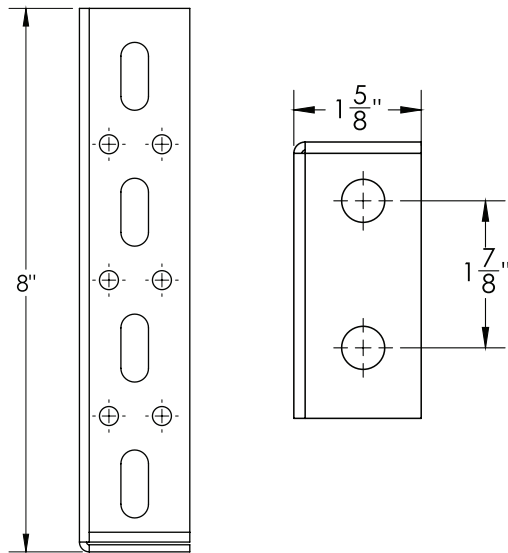

ORDERING DATA EXAMPLE:

SBX-B185CCL

MATERIAL

P = PREGLAV STEEL
G = HDGAF STEEL

4 International Drive
Rye Brook, NY 10573
Toll Free: 1 888.764.7681
Phone: 914.934.2075
Fax: 914.934.2190
MonoSystems.com



Channel Tray SBX-124X

Channel Tray Accessories

Manufactured in the USA by MonoSystems, Inc.

HOLD-DOWN (OR) EXPANSION CLAMP

Notes:

- 1.) Furnished as one clamp. 1/2" Mounting hardware ordered separately.
- 2.) Not for use with channel tray using cover.
- 3.) Views for reference - do not scale.

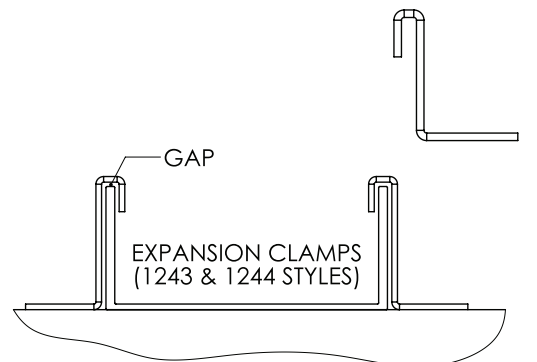
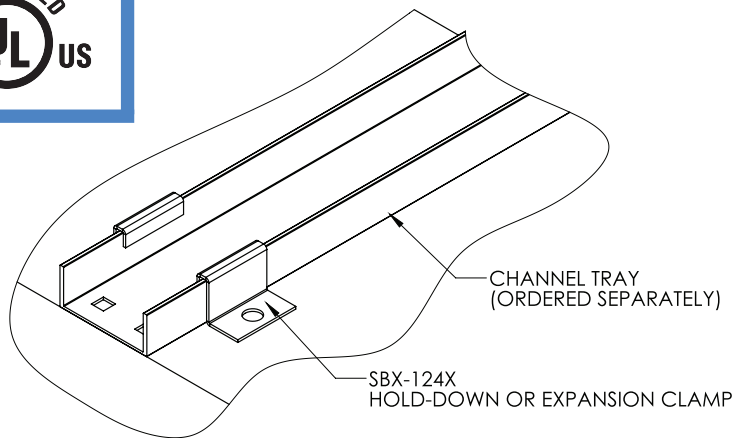
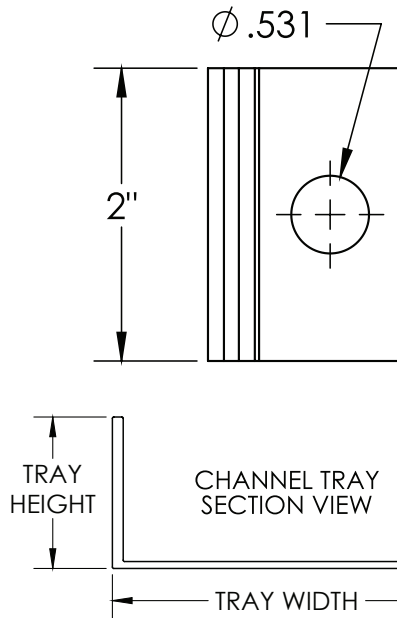

VERTICAL GAP ALLOWS FOR TRAY MOVEMENT



SECURES CHANNEL TRAY TO SUPPORT

ORDERING DATA EXAMPLE:

SB X-124 X

MATERIAL

A = ALUMINUM
P = PREGALV STEEL
SS4 = STAINLESS STEEL 304
SS6 = STAINLESS STEEL 316

STYLE & TRAY WIDTH

3 = EXPANSION 3" WIDE
4 = EXPANSION 4" AND 6" WIDE
5 = HOLD DOWN 3" WIDE
6 = HOLD DOWN 4" AND 6" WIDE

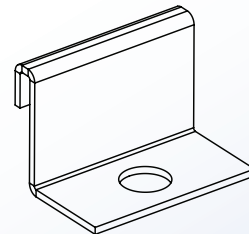

4 International Drive
Rye Brook, NY 10573
Toll Free: 1 888.764.7681
Phone: 914.934.2075
Fax: 914.934.2190
MonoSystems.com

